

MAP OF SURVEY
PROPERTY LINE ADJUSTMENT

located in
SOUTHWEST 1/4 OF SECTION 30, TOWNSHIP 37 SOUTH,
RANGE 4 WEST, WILLAMETTE MERIDIAN,
JACKSON COUNTY, OREGON
for
LARRY THOMPSON
1085 KUBLI ROAD
GRANTS PASS, OREGON 97527

NORTHWEST CORNER
D.L.C. NUMBER 40
S/N 4653 1469.47

NORTHEAST CORNER
D.L.C. NUMBER 40
FOUND TO AGREE WITH
JACKSON COUNTY
RE-ESTABLISHMENT
NOTES

CARIS CREEK
LOCATION PER
S/N 6352, 1976
DATA ROTATED TO
MATCH ABOVE
BEARING

SEE DETAIL
OF CREEK
W.C. 100
S89°49'46"E
77.00'
S89°50'20"W
215.87
(S89°50'20"W 300.00')

AREA 17.44 ACRES ±
INST. No. 02-44600
TL 303

N79°43'58"E 1116.75'
NEW BOUNDARY LINE

AREA 22.30 ACRES ±
INST. No. 02-44601
TL 501

FOUND 1" IRON PIPE
RECORD 1 1/2" PIPE
LEANING TO THE
NORTH. S/N 2792
WOODEN POINT INSIDE
WITH BRASS WASHER
MARKED RS 404
BEARING AND DISTANCE
FROM DEED CORNER
TO MONUMENT
S41°10'50"E 0.79'

LINE TABLE

NUM	DISTANCE	BEARING
L1	106.79	S20°10'40"W
L2	84.35	S69°47'46"W
L3	105.61	S38°40'33"W
L4	114.05	S62°57'43"W

89.06' FROM PROPERTY
LINE TO THE ANGLE POINT
POINT BETWEEN L2 AND L3
ALONG L3

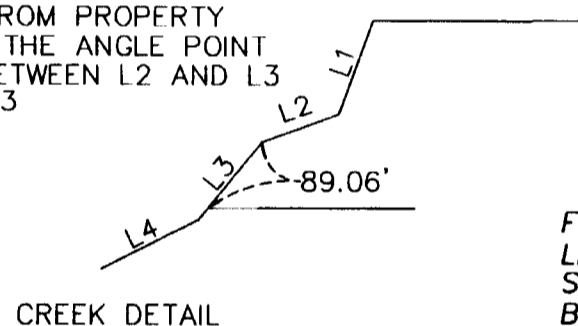

FOUND 1" IRON PIPE
LEANING TO THE NORTH
S/N 2792
BEARING AND DISTANCE
FROM DEED CORNER
TO MONUMENT
S14°59'05"E 1.34'

OLD BOUNDARY LINE

(S89°54'W 1100')

VALLEY
ROAD CENTER LINE
S60°0'W 209.1'
N79°30'W 276.9
N62°0'W 97.4'
CENTER LINE BEARING AND DISTANCE
FROM INSTRUMENT NUMBER 02-20658

ELL CORNER
D.L.C. NUMBER 40
FOUND TO AGREE WITH
JACKSON COUNTY
RE-ESTABLISHMENT
NOTES 1273.21

EAST-SOUTHEAST CORNER
D.L.C. NUMBER 40
FOUND TO AGREE WITH
JACKSON COUNTY
RE-ESTABLISHMENT
NOTES 1023.84

** RECEIVED **
DATE 9-3-02 BY *AS*
This survey consist of:
1 sheet(s) Map
2 page(s) Narrative
JACKSON COUNTY
SURVEYOR

REGISTERED
PROFESSIONAL
LAND SURVEYOR

Herbert A. Farber
OREGON
JULY 26, 1985
HERBERT A. FARBER
2189
RENEWAL DATE 12-31-03

SURVEY NARRATIVE
TO COMPLY WITH O.R.S. 209.250

PURPOSE: TO SURVEY AND MONUMENT THE PROPERTY LINE ADJUSTMENT OF THE LOTS DESCRIBED IN INSTRUMENT NUMBERS 95-25318 AND 02 20658 AS ARRPOVED BY JACKSON COUNTY PLANNING DEPARTMENT FILE NUMBER 2002-16-PLA

PROCEDURE: UTILIZING CONTROL ESTABLISHED DURING THIS SURVEY I MONUMENTED THE PROPERTY LINE ADJUSTMENT AS SHOWN HERE ON.

Surveyed by:
FARBER & SONS, INC.
dba FARBER SURVEYING
(541) 776-0846

OFFICE LOCATION: 120 MISTLETOE MEDFORD, OREGON 97501
MAILING ADDRESS: P.O. BOX 5286 CENTRAL POINT, OREGON 97502

SCALE: 1" = 200'
DATE: JULY 9, 2002
JOB NO.: 1069-02
DRAWING FILE:
JOBS\APPLGATE\THOMPSON 060802\PROJECT FILES\MAP OF SURVEY.FLX