

SURVEY FOR:
 Jeannette Marshall
 246 E. 10th. Street
 Medford, Oregon 97501

BY:
 Boyden Surveyors
 108 Mistletoe Street
 Medford, Oregon 97501

LOCATED in the SE1/4 of the
 SW1/4 of Section 24,
 T.39S., R.2W., W.M.,
 Jackson County, Oregon

Date: April 15, 2002

Basis of Bearings

N. Bdry. of the SE1/4 of the SW1/4
 Section 24, T.39S., R.2W., W.M.
 according to County Filed
 Survey Nos. 2262 & 4119

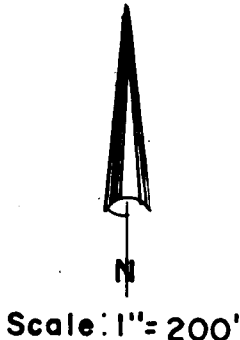

LEGEND

- FOUND 5/8" IRON PIN SET ON COUNTY FILED SURVEY NO. 2262
- FOUND 5/8" REBAR SET ON COUNTY FILED SURVEY NO. 4119
- ✱ SET 5/8" X 24" REBAR/AL. CAP STAMPED "BOYDEN PLS 281"
- ◆ SET 5/8" X 30" REBAR/AL. CAP STAMPED "BOYDEN PLS 281"
- W.C. = WITNESS CORNER
- F.S. = FILED COUNTY SURVEY
- LINE MEASURED
- - - LINE CALCULATED

** RECEIVED **
 Date 4-24-02 By MB
 This survey consists of:
 / sheet(s) Map
 / page(s) Narrative
 JACKSON COUNTY
 SURVEYOR

NOTE: LITTLE APPLAGATE RIVER NOT SURVEYED BETWEEN THE W. LINE TAX LOT 600 & SELY LINE OF TAX LOT 700

REGISTERED
**PROFESSIONAL
 LAND SURVEYOR**
Mark E. Boyden
 OREGON
 NOV. 9, 1981
**MARK E. BOYDEN
 281**

= Expires: 12/31/03.

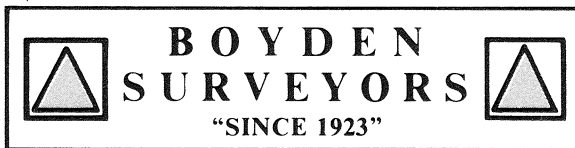

MARK E. BOYDEN
R.P.L.S. ORE. 281
108 MISTLETOE ST., MEDFORD, OREGON 97501
PHONE (503) 773-6000

SURVEY NO. 17295

SURVEY NARRATIVE TO COMPLY WITH O.R.S. 209.250

SURVEY FOR: Jeannette Marshall
246 E. 10th Street
Medford, OR 97501

SURVEY BY: Boyden Surveyors
108 Mistletoe Street
Medford, OR 97501

LOCATION: SE 1/4 of SW 1/4, Section 24, T. 39 S., R. 2 W., W.M.,
Jackson County, Oregon

BASIS OF BEARINGS: North boundary Re: Filed Survey No. 2262

DATE: April 15, 2002

PURPOSE: 1. To locate the North, Easterly and West boundaries of Tax Lot 600.
2. Locate the Southeasterly boundary of Tax Lot 700 between the NE corner and the witness corner set near the SE corner as utilized on Filed Survey No. 4119.

PROCEDURE: Utilizing E.D.M. equipment, traversed the North, West and along Little Applegate Road to tie in monuments set on Filed Survey Nos. 2262 and 4119 as shown.

At the SW 1/16 corner of Section 24, found the 5/8" iron pin set for corner on Filed Survey No. 2262 exposed 1", from which found a 5/8" iron pin flush of unknown origin that bears South 86° 27' East, 8.89 feet; the East side of an 8" White Oak bears N. 46 1/2° E., 34.3 feet; North side of a 12" Black Oak bears N 75 1/2° W., 34.4 feet.

At the Center-South one -sixteenth corner set on Filed Survey No. 2262, found a 5/8" iron pin 2" deep from which the center of a 7" White Oak with healed blazes bears S. 61° W., 30.1 feet (Record = S. 61 1/2° W., 30.2 feet) the center of an 18" Pine with healed blazes bears S 1° W., 14.6 feet (Record = South, 14.9 feet).

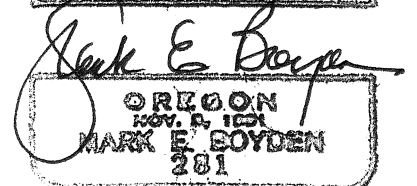
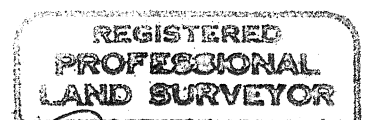
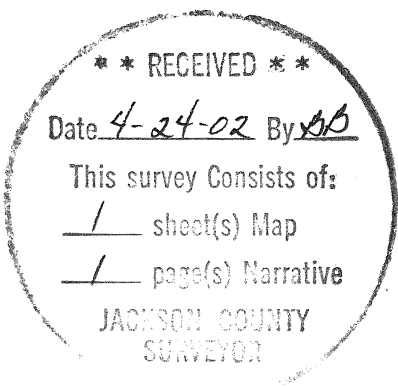

Expires: 12/31/03.