

MAP OF SURVEY

Located within Donation Land Claim Numbers 37 and 90, in the Southeast One-Quarter of Section 29, Township 37 South, Range 2 West of the Willamette Meridian, in the City of Jacksonville, Jackson County, Oregon

PREPARED FOR:

EXCELSIOR INVESTMENTS CO.
4061 Livingston Road
Central Point, Oregon 97502

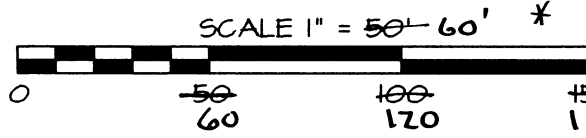

Delta = 35°16'43"
Arc Length = 61.57'
Chord Bearing = N50°36'34"E
60.60'

BASIS OF BEARINGS:
S60°01'55"E 162.98'
S60°01'55"E 149.87'

Delta = 23°42'59"
Arc Length = 62.09'
Chord Bearing = S48°10'25"E
61.65'

Monument set on SN 16362 destroyed during sidewalk construction

Found 5/8" rebar as per SN 1913

Found 5/8" rebar as per SN 13632

Found 5/8" rebar as per SN 13632

Found 5/8" rebar as per SN 13632

**** RECEIVED ****
Date 5-2-01 By SB
This survey consists of:
1 sheet(s) Map
0 page(s) Narrative
JACKSON COUNTY SURVEYOR

* AFFID OF CORRECTION Doc # 06-16642 (See CS 16897)
Robert Neathamer, C.S., 3/31/02

REGISTERED PROFESSIONAL LAND SURVEYOR
Robert V. Neathamer
OREGON
JULY 19, 1984
ROBERT V. NEATHAMER
2875
Renewal Date 12/31/02

NOTES:

- The real property depicted hereon consists of tax lots numbered 1800 and 1900 of Jackson County Assessor's Map Number 37 2W 29D.
- Said real property also subject to the following:
 - All easements as depicted hereon.
 - Right of way for Highway 238, also known as 5th Street.
 - Volume 255, Page 387, Deed Records of Jackson County is an easement blanket in nature, along existing facilities, in favor of the California Oregon Power Company, its successors and assigns.
 - A 10-foot wide sanitary sewer easement as defined in Document Number 67-05774, Official Records of Jackson County, Oregon.
 - A 15-foot wide easement for sewer and water facilities, as defined in Doc. No. 68-06124, and a 15-foot wide waterline easement as defined in Document Number 69-00192, Official Records of Jackson County, Oregon.
 - A 10-foot wide easement in favor of the Pacific Northwest Bell Telephone Company, its successors and assigns, as contained in Document Number 76-07221, Official Records of Jackson County, Oregon, affects 37 2W 29D, Tax Lot 1800.
 - The referenced easements as defined in Doc. No. 00-04920.

LEGEND

- Indicates a set 5/8-inch rebar by 30 inches long, with yellow plastic cap marked "NEATHAMER LS 2675", set flush with the surface, or as noted hereon.
- ▲ Indicates a found 5/8-inch rebar with a yellow plastic cap marked "D. MCMAHAN LS 1913", or as noted hereon, origin unknown.
- Indicates a found 5/8-inch rebar, refer to SN 16362; or as noted hereon.
- ⊙ Indicates a found 3-1/4 inch diameter brass disk in concrete, marked "CITY OF JACKSONVILLE C/L MON LS2675". Refer to SN 16362.
- Indicates a computed position.
- SN Indicates a survey filed number in the office of the Jackson County Surveyor.
- Doc. No. Indicates a document number pursuant to the Official Records of Jackson County, Oregon.
- Vol. No. Indicates a document number pursuant to the Deed Records of Jackson County, Oregon.
- () Indicates Record Information, as per SN 7174.
- < > Indicates Record information, as per SN 16362.
- [] Indicates Record information, as per SN 471.
- x- Indicates an existing fence line.
- ⊙-SS- Indicates an existing sanitary sewer line and manholes, as marked by the City of Jacksonville.
- W- Indicates an existing water line, as marked by the City of Jacksonville.
- T- Indicates an existing utility marked telephone line.
- OHU- Indicates an existing overhead utility and poles.

NARRATIVE TO COMPLY WITH O.R.S. 209.250

Purpose: Pursuant to Client's instructions, perform a field survey, identify any encroachments, monument dead corners, prepare and file a Map of Survey with the office of the Jackson County Surveyor.

Procedure: Utilizing a Nikon DTM-520 Total Station, and a Ranger Data Collector with TDS software, all found monuments, as depicted hereon, were tied in a closed loop traverse.

Based on said traverse, Instruments Numbered 71-01232 and 75-01073, Official Records of Jackson County, Oregon and Surveys Numbered 471, 7174 and 16362, on file in the Jackson County Surveyor's office, the boundaries of Client's property were computed and the corners monumented, as depicted hereon.

BASIS OF BEARINGS:

Nunan Square Subdivision, A Planned Community, recorded December 16, 1999, in Volume 25 of Plats at Page 42 of the records of Jackson County, Oregon. Bearing reference is the centerline of "G" Street, depicted hereon, and as contained on Survey Number 16362, filed in the office of the Jackson County Surveyor.

PREPARED BY: Neathamer Surveying, Inc.
304 South Central Avenue
Medford, Oregon 97501
Phone (541) 732-2869
FAX (541) 732-1382

PROJECT NUMBER: 99002 DATE: April 25, 2001

Sheet 1 of 1 © CEN



I, Kathleen S. Beckett, County Clerk for Jackson County, Oregon, certify that the instrument identified herein was recorded in the Clerk records.
Kathleen S. Beckett - County Clerk

AFFIDAVIT OF CORRECTION
Pursuant to O.R.S. 209.255

16897

Be it hereby noted that on the Map of Survey prepared for Excelsior Investments Company, filed as Survey Number 16897 in the Jackson County Surveyors Office, a drafting error was made on the face of the map. An incorrect scale of 1"= 50' is shown on said map. The correct scale is 1"=60'.

Date: March 30, 2006

Robert V. Neathamer, PLS

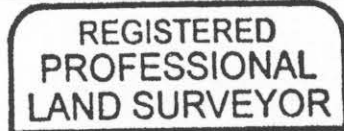

Robert V. Neathamer

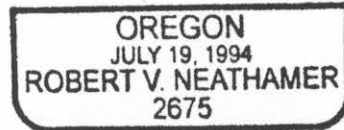

RENEWAL: DEC. 31, 06

STATE OF OREGON)
County of Jackson) ss.

Before me on March 30th, 2006, personally appeared the above named Robert V. Neathamer, a Registered Professional Land Surveyor, and acknowledged the foregoing instrument to be his voluntary act and deed.

Joy N. Pinkham

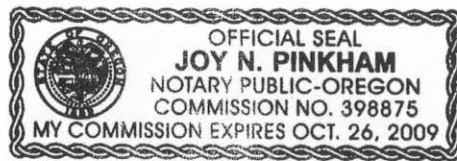

I, Roger R. Roberts, Jackson County Surveyor, do hereby certify that I have examined this Affidavit of Correction and that the changes are permitted in accordance with Chapter 209, Paragraph 255, Oregon Revised Statutes.

March 31, 2006
Date

Roger R. Roberts
Jackson County Surveyor

