

CURVE DATA

PT	RADIUS	DELTA	LENGTH	LC BEARING	LC
A	475.00	03°33'40"	29.52	N 31°19'48" W	29.52
B	475.00	08°20'47"	69.20	N 37°17'02" W	69.13
C	20.00	85°03'57"	29.69	N 01°04'33" E	27.04
D	20.00	49°59'42"	17.45	N 68°36'22" E	16.90
E	50.00	43°23'06"	37.86	N 71°54'40" E	36.96
F	50.00	42°38'37"	37.21	N 28°53'49" E	36.36
G	50.00	41°39'18"	36.35	N 13°15'09" W	35.56
H	50.00	60°00'00"	52.36	N 64°04'48" W	50.00
I	50.00	62°49'10"	54.82	S 54°30'37" W	52.12
J	50.00	29°29'12"	25.73	N 08°21'27" E	25.45
K	20.00	49°59'42"	17.45	N 18°36'41" E	16.90
L	20.00	84°30'07"	29.50	N 85°51'36" E	26.90

COURSE DATA

PT	LC BEARING	LC
L1	S 29°32'59" E	46.19
L2	S 29°32'59" E	36.09
L3	S 29°32'59" E	26.00
L4	S 43°36'32" W	28.10
L5	S 43°36'32" W	28.54
L6	S 86°17'17" E	15.00
L8	S 49°56'22" E	3.42
L9	S 05°12'38" W	2.65
L10	N 05°12'38" E	2.65
L11	N 22°14'26" W	5.58
L12	S 00°18'22" E	24.55
L13	S 00°18'22" E	24.71
L14	S 00°18'22" E	24.87
L15	N 77°03'20" E	47.27
L16	S 43°36'32" W	124.89
L17	N 05°12'38" E	2.65
L18	N 77°03'20" E	0.17
L19	N 77°03'20" E	0.17

CURVE DATA

PT	RADIUS	DELTA	LENGTH	LC BEARING	LC
M	475.00	12°39'15"	104.91	S 58°12'58" E	104.69
N	475.00	11°28'42"	95.16	N 70°16'56" W	95.00
O	475.00	10°16'00"	85.11	N 81°09'17" W	85.00

PT	RADIUS	DELTA	LENGTH	LC BEARING	LC
P	425.00	08°46'17"	65.06	S 81°54'08" E	65.00
Q	425.00	14°52'16"	110.31	S 70°04'52" E	110.00
R	425.00	14°03'21"	104.26	S 55°37'03" E	104.00

PT	RADIUS	DELTA	LENGTH	LC BEARING	LC
S	425.00	12°25'38"	92.18	S 42°22'33" E	92.00
T	425.00	06°36'46"	49.05	N 32°51'22" W	49.02
U	425.00	56°44'18"	420.87	S 57°55'08" E	403.88

PT	RADIUS	DELTA	LENGTH	LC BEARING	LC
V	475.00	11°54'27"	98.72	S 35°30'12" E	98.54
W	475.00	34°23'57"	285.18	S 69°05'19" E	280.92
X	450.00	17°09'01"	134.70	S 38°07'29" E	134.20

PT	RADIUS	DELTA	LENGTH	LC BEARING	LC
Y	450.00	39°35'17"	130.92	S 66°29'38" E	304.78
Z	450.00	56°44'18"	445.62	S 57°55'08" E	427.64
A1	125.00	05°30'09"	12.00	N 89°02'21" W	12.00

PT	RADIUS	DELTA	LENGTH	LC BEARING	LC
A2	125.00	25°25'05"	55.45	S 75°30'02" W	55.00
A3	125.00	22°43'51"	49.51	S 51°25'33" W	49.27
A4	20.00	90°00'00"	31.42	S 85°03'38" W	28.28

PT	RADIUS	DELTA	LENGTH	LC BEARING	LC
A5	270.00	27°41'56"	130.53	N 36°05'24" W	129.26
A6	125.00	53°39'05"	117.05	N 66°53'10" E	112.82
A7	100.00	53°39'05"	93.64	N 66°53'11" E	90.26

PT	RADIUS	DELTA	LENGTH	LC BEARING	LC
A8	75.00	53°39'05"	70.23	N 66°53'11" E	67.69
A9	20.00	90°00'00"	31.42	N 04°56'22" W	28.28
B1	287.69	18°07'47"	91.03	S 40°52'29" E	90.65

PT	RADIUS	DELTA	LENGTH	LC BEARING	LC
B2	287.69	07°42'28"	38.70	N 27°57'21" W	38.67
B3	287.69	13°48'57"	69.37	N 17°11'39" W	69.20
B4	287.69	09°58'49"	50.11	N 05°17'47" W	50.05

PT	RADIUS	DELTA	LENGTH	LC BEARING	LC
B5	287.69	49°38'00"	249.22	S 25°07'22" E	241.50
B6	257.69	49°38'00"	223.23	S 25°07'22" E	216.31
B7	227.69	43°20'21"	172.23	N 21°58'32" W	168.15

CURVE DATA

PT	RADIUS	DELTA	LENGTH	LC BEARING	LC
B8	227.69	06°17'39"	25.01	N 46°47'32" W	25.00
B9	227.69	49°38'00"	197.24	S 25°07'22" E	191.13
C1	330.00	04°36'52"	26.58	N 47°37'56" W	26.57

PT	RADIUS	DELTA	LENGTH	LC BEARING	LC
C2	330.00	12°04'40"	69.56	N 39°17'09" W	69.44
C3	330.00	11°00'23"	63.39	N 27°44'38" W	63.30
C4	330.00	27°41'56"	159.53	S 36°05'24" E	157.98

PT	RADIUS	DELTA	LENGTH	LC BEARING	LC
C5	300.00	27°41'56"	145.03	S 36°05'24" E	143.62
C6	270.00	08°31'35"	40.18	N 17°59'02" W	40.14
C7	270.00	18°55'31"	89.18	S 04°14'56" E	88.78

PT	RADIUS	DELTA	LENGTH	LC BEARING	LC
C8	50.00	279°59'22"	244.34	S 46°23'28" E	64.29
C9	270.00	27°27'05"	129.36	S 08°30'54" E	128.13
D1	440.00	00°25'03"	3.20	S 05°25'20" W	3.20

PT	RADIUS	DELTA	LENGTH	LC BEARING	LC
D2	470.00	00°11'43"	1.60	S 05°18'26" W	1.60
D3	330.00	10°46'06"	62.02	N 00°10'24" W	61.93
D4	20.00	82°36'46"	28.84	N 35°44'57" E	26.40

PT	RADIUS	DELTA	LENGTH	LC BEARING	LC
D5	300.00	18°09'20"	95.06	N 03°52'00" W	94.66
D6	300.00	09°17'46"	48.67	N 17°35'33" W	48.62
D7	300.00	27°27'05"	143.74	S 08°30'53" E	142.36

PT	RADIUS	DELTA	LENGTH	LC BEARING	LC
D8	455.00	14°14'27"	113.09	N 84°10'33" E	112.80
D9	480.00	10°51'36"	90.98	N 82°29'08" E	90.84
E1	505.00	07°58'59"	70.36	N 81°02'49" E	70.30

PT	RADIUS	DELTA	LENGTH	LC BEARING	LC
E2	20.00	82°36'46"	28.84	S 61°38'17" E	26.40
E3	330.00	01°54'33"	11.00	S 21°17'11" E	10.99

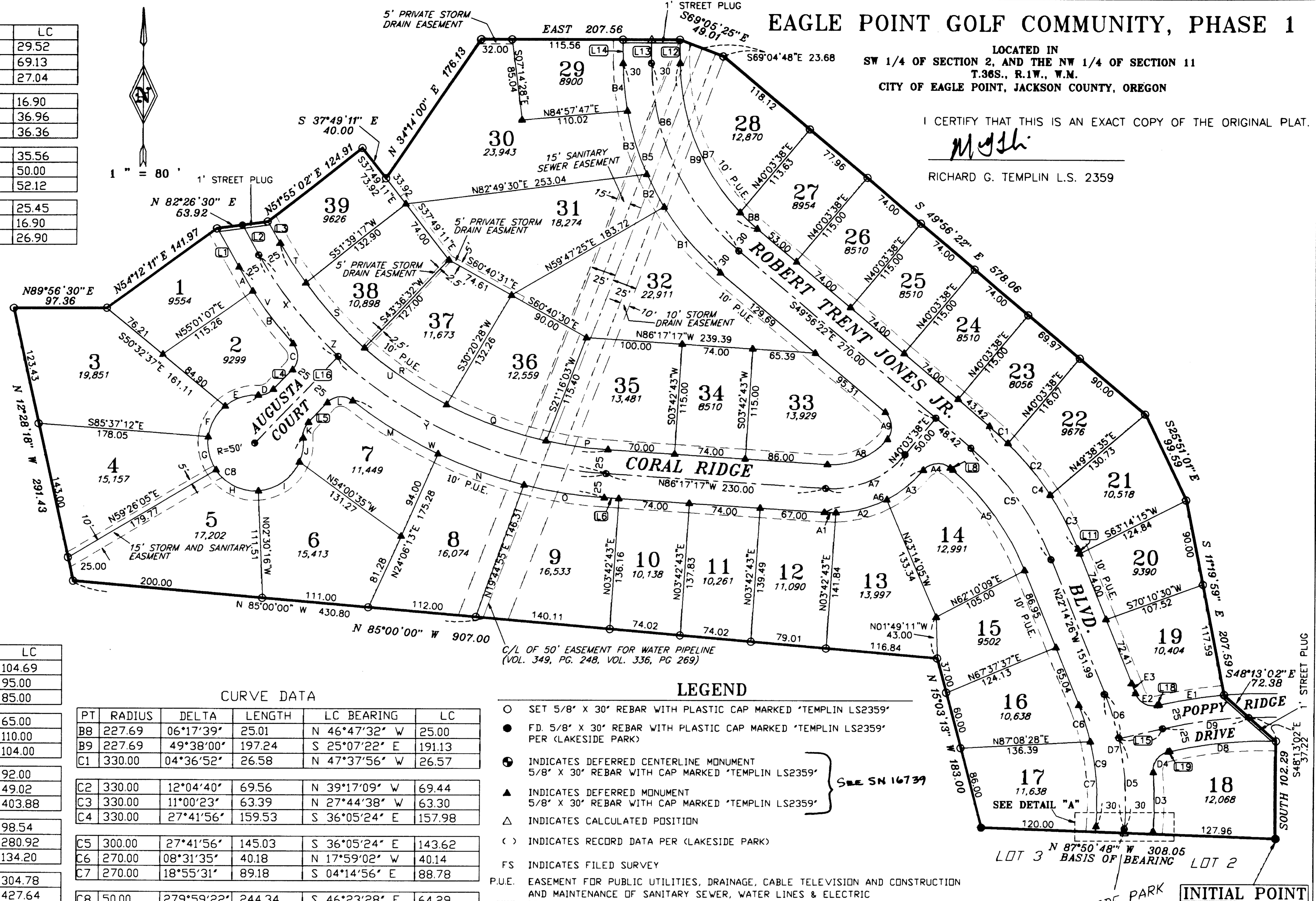

EAGLE POINT GOLF COMMUNITY, PHASE 1

LOCATED IN
SW 1/4 OF SECTION 2, AND THE NW 1/4 OF SECTION 11
T.36S., R.1W., W.M.
CITY OF EAGLE POINT, JACKSON COUNTY, OREGON

I CERTIFY THAT THIS IS AN EXACT COPY OF THE ORIGINAL PLAT.

Richard G. Templin
RICHARD G. TEMPLIN L.S. 2359

- LEGEND**
- SET 5/8" X 30" REBAR WITH PLASTIC CAP MARKED "TEMPLIN LS2359"
 - FD. 5/8" X 30" REBAR WITH PLASTIC CAP MARKED "TEMPLIN LS2359" PER (LAKESIDE PARK)
 - ⊙ INDICATES DEFERRED CENTERLINE MONUMENT 5/8" X 30" REBAR WITH CAP MARKED "TEMPLIN LS2359"
 - ▲ INDICATES DEFERRED MONUMENT 5/8" X 30" REBAR WITH CAP MARKED "TEMPLIN LS2359"
 - △ INDICATES CALCULATED POSITION
 - () INDICATES RECORD DATA PER (LAKESIDE PARK)
 - FS INDICATES FILED SURVEY
 - P.U.E. EASEMENT FOR PUBLIC UTILITIES, DRAINAGE, CABLE TELEVISION AND CONSTRUCTION AND MAINTENANCE OF SANITARY SEWER, WATER LINES & ELECTRIC

DETAIL "A"
NOT TO SCALE

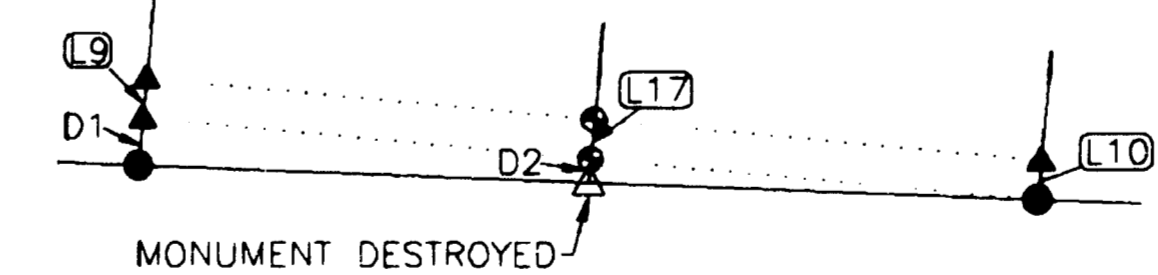

(RECORD)
R = 470.00
DELTA = 26°11'37"
LENGTH = 214.87
LC = N 18°30'11" E 213.00

FOR: Eagle Point Development L.L.C.
501 Spencer St.
Medford, Or. 97504

FILE: 'phase1ver10pg2.DWG'

RICHARD TEMPLIN LAND SURVEYING
P.O. BOX 1946 899-2032 JACKSONVILLE, OREGON

EAGLE POINT GOLF COMMUNITY PHASE 1

LOCATED IN
SW 1/4 OF SECTION 2, AND THE NW 1/4 OF SECTION 11
T.36S., R.1W., W.M.
CITY OF EAGLE POINT, JACKSON COUNTY, OREGON
DATE: OCTOBER 10, 2000

RICHARD TEMPLIN LAND SURVEYING
P.O BOX 1946
JACKSONVILLE, OREGON 97530
(541) 899-2032

SURVEY NARRATIVE

Survey No. 16694

SURVEY FOR: Eagle Point Development L.L.C.
501 Spencer St.
Medford, Oregon 97504

LOCATION: The SW 1/4 of Section 2 and the NW 1/4 of Section 11, Township
36 South, Range 1 West, of the Willamette Meridian, Jackson
County, Oregon.

DATE: October 5, 2000

BASIS OF Bearings based upon the North line of " LAKESIDE PARK ", per
filed survey number 16459 and as shown the accompanying Plat.

PURPOSE: To survey and monument a 39 lot subdivision per my clients
request and as depicted on the Plat, Eagle Point Golf Community Phase 1.

PROCEDURE: The outside boundary was monumented as requested by my client.
I set the angle points on the outside boundary. Occupying each
angle point I then checked between them and set on line the lot
corners along the outside boundary. The interior monuments are
to be deferred, as shown on the Plat.

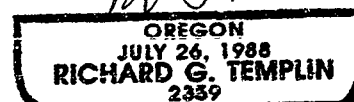
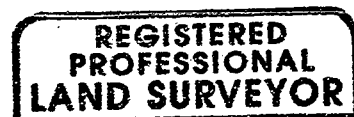
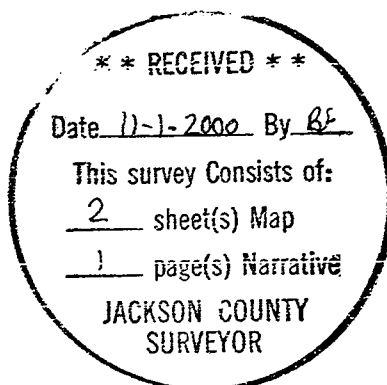

MY CERTIFICATE EXPIRES JUNE 30, 2002

DECLARATION

KNOW ALL MEN BY THESE PRESENTS, that we, Eagle Point Developments LLC, an Oregon limited liability company, are the owners in fee simple of the land shown hereon and that we have subdivided the same into lots and streets as shown hereon, and the number of each lot and the course and length of all lines are plainly set forth, and this plat is a correct representation of the subdivision. We do hereby dedicate to the public for public use the streets shown hereon, together with those easements labeled as public utility easements, and we hereby grant to the City of Eagle Point in fee simple, the area portrayed and designated hereon as one foot street plugs. By its approval of this plat, the City of Eagle Point declares that upon dedication of the extension of the affected street, it thereby dedicates the street plug for public street purposes. We hereby designate said subdivision as Eagle Point Golf Community, Phase 1.

Eagle Point Developments LLC by: [Signature]

C. A. Galpin

Its member

STATE OF Oregon

COUNTY OF Jackson



This certifies that on this 11th day of October, 2000, before me a Notary Public,

personally appeared C. A. Galpin, member of Eagle Point Developments LLC, and acknowledged the foregoing instrument to be his Voluntary act and deed.

Before me: Patricia L. Thomas Notary Public

We, U. S. BANK NATIONAL ASSOCIATION, the undersigned beneficiary of a certain Trust Deed recorded August 13, 1999 as Document No. 99-42463 Official Records of Jackson County, Oregon, affecting the land described herein, hereby release from the lien of said Trust Deed, all property shown hereon as dedicated to the public for public use.

U.S. BANK NATIONAL ASSOCIATION by: [Signature]

THOMAS T. BYRER

Its Vice President

STATE OF Oregon

COUNTY OF Multnomah

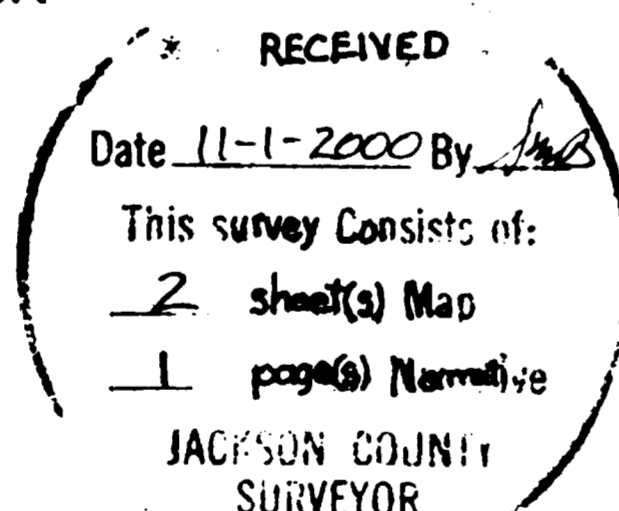

This certifies that on this 23rd day of October, 2000, before me a Notary Public,

personally appeared Thomas T. Byrer, and acknowledged the foregoing instrument to be their Voluntary act and deed.

Before me: Darci B. Hall Notary Public

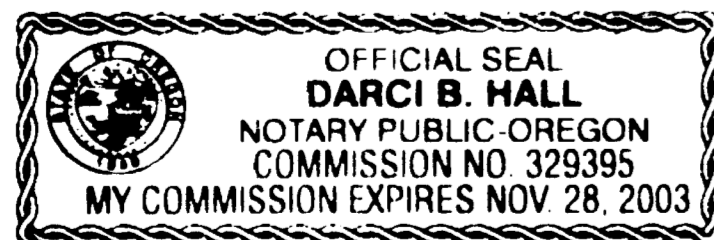

EAGLE POINT GOLF COMMUNITY, PHASE 1

LOCATED IN SW 1/4 OF SECTION 2, AND THE NW 1/4 OF SECTION 11 T.36S., R.1W., W.M. CITY OF EAGLE POINT, JACKSON COUNTY, OREGON

I, Richard G. Templin, a duly registered surveyor of the State of Oregon, do hereby certify that I have correctly surveyed and marked with the proper monuments as provided by law the tract of land hereon shown and the plat is a correct representation of the same, and the following is an accurate description of the boundary lines:

Beginning at the INITIAL POINT, a 5/8" iron rod at the Northeast corner of Lot 2, " LAKESIDE PARK ", as recorded in Volume 26, Page 09 of the records of Jackson County, Oregon and filed as Survey number 16459 (being also the Initial Point of said " LAKESIDE PARK "); thence North 87°50'48" West along the North line of said " LAKESIDE PARK ", 308.05 feet to a 5/8" iron rod at the Northwest corner of Lot 3 of said " LAKESIDE PARK "; thence North 15°03'13" West, 183.00 feet to a 5/8" iron rod; thence North 85°00'00" West, 907.00 feet to a 5/8" iron rod; thence North 12°28'18" West, 291.43 feet to a 5/8" iron rod; thence North 89°56'30" East, 97.36 feet to a 5/8" iron rod; thence North 54°12'11" East, 141.97 feet to a 5/8" iron rod; thence North 82°26'30" East, 53.92 feet to a 5/8" iron rod; thence North 51°55'02" East, 124.91 feet to a 5/8" iron rod; thence South 37°49'11" East, 40.00 feet to a 5/8" iron rod; thence North 34°14'00" East, 176.13 feet to a 5/8" iron rod; thence East, 207.56 feet to a 5/8" iron rod; thence South 69°05'25" East, 49.01 feet to a 5/8" iron rod; thence South 49°56'22" East, 578.06 feet to a 5/8" iron rod; thence South 25°51'01" East, 99.59 feet to a 5/8" iron rod; thence South 11°19'59" East, 207.59 feet to a 5/8" iron rod; thence South 48°13'02" East, 72.38 feet to a 5/8" iron rod; thence South, 102.29 feet to the true point of beginning.

RICHARD G. TEMPLIN LS 2359

We, Eagle Point Developments LLC, an Oregon limited liability company, the undersigned beneficiaries of a certain Trust Deed recorded August 13, 1999 as Document No. 99-42678, and assigned by instrument recorded May 18, 2000 as Document No. 00-20936, along with a certain Trust Deed recorded August 13, 1999 as Document No. 99-42679, and assigned by instrument recorded May 18, 2000 as Document No. 00-20937, Official Records of Jackson County, Oregon, affecting the land described herein, hereby release from the lien of said Trust Deed, all property shown hereon as dedicated to the public for public use.

Eagle Point Developments LLC by: [Signature]

C. A. Galpin

Its member

STATE OF Oregon

COUNTY OF Jackson



This certifies that on this 11th day of October, 2000, before me a Notary Public,

personally appeared C. A. Galpin, member of Eagle Point Developments LLC, and acknowledged the foregoing instrument to be their Voluntary act and deed.

Before me: Patricia L. Thomas Notary Public

I CERTIFY THAT THIS IS AN EXACT COPY OF THE ORIGINAL PLAT.

RICHARD G. TEMPLIN L.S. 2359

FOR: Eagle Point Development L.L.C. 501 Spencer St. Medford, Or. 97504

APPROVALS

Examined and approved this 11th day of October, 2000

[Signature] JACKSON COUNTY SURVEYOR

All deferred monuments will be set no later than January 1, 2001.

[Signature] RICHARD G. TEMPLIN LS 2359

All deferred monuments are now set, see Document No. 00-50421 of Official Records, this 14th day of December, 2000

Approved by Jackson County Surveyor.

[Signature] JACKSON COUNTY SURVEYOR

Examined and recommended for approval this 17 day of October, 2000

[Signature] CITY ENGINEER

Examined and recommended for approval by Bear Creek Valley Sanitary Authority this 16 day of OCTOBER, 2000

[Signature] DISTRICT ENGINEER

Examined and approved by the City Administrator/Planning Director of the City of Eagle Point, Jackson County, Oregon. Dated this 26 day of October, 2000

[Signature] CITY ADMINISTRATOR / PLANNING DIRECTOR

Examined and approved as required by O.R.S. 92.100 as of October 27, 2000

[Signature] ASSESSOR, DEPARTMENT OF ASSESSMENT

All taxes, fees, assessments or other charges as required by O.R.S. 92.095 have been paid as of October 27, 2000

[Signature] TAX COLLECTOR

RECORDERS CERTIFICATE

For order of the County Court approving this plat see Volume _____, Page _____ of County Commissioners Journal of Proceedings.

Filed for record this 1 day of November, 2000 at 1:30 o'clock P.M.

and recorded in Volume 26 of Plats at page 43 of records of Jackson County, Oregon.

Kathleen S. Beckett COUNTY CLERK

[Signature] DEPUTY

FILE: "phase1ver10pg1.DWG"

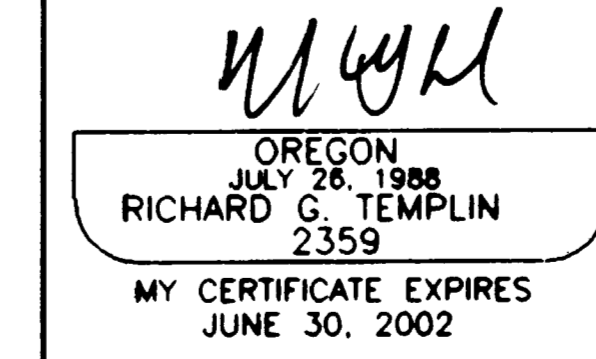
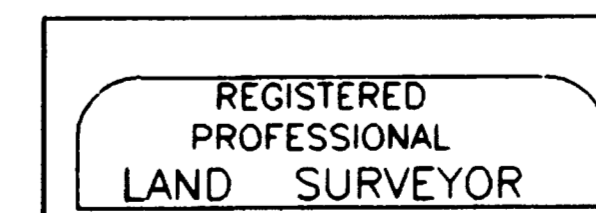

RICHARD TEMPLIN LAND SURVEYING P.O. BOX 1946 899-2032 JACKSONVILLE, OREGON

EAGLE POINT GOLF COMMUNITY PHASE 1

LOCATED IN SW 1/4 OF SECTION 2, AND THE NW 1/4 OF SECTION 11 T.36S., R.1W., W.M.

CITY OF EAGLE POINT, JACKSON COUNTY, OREGON DATE: OCTOBER 10, 2000

DECLARATION

KNOW ALL MEN BY THESE PRESENTS, that we, Eagle Point Developments LLC, an Oregon limited liability company, are the owners in fee simple of the land shown hereon and that we have subdivided the same into lots and streets as shown hereon, and the number of each lot and the course and length of all lines are plainly set forth, and this plat is a correct representation of the subdivision. We do hereby dedicate to the public for public use the streets shown hereon, together with those easements labeled as public utility easements, and we hereby grant to the City of Eagle Point in fee simple, the area portrayed and designated hereon as one foot street plugs. By its approval of this plat, the City of Eagle Point declares that upon dedication of the extension of the affected street, it thereby dedicates the street plug for public street purposes. We hereby designate said subdivision as Eagle Point Golf Community, Phase 1.

Eagle Point Developments LLC by: [Signature]
C. A. Galpin

Its member

STATE OF Oregon

COUNTY OF Jackson



This certifies that on this 11th day of October, 2000, before me a Notary Public,

personally appeared C. A. Galpin, member of Eagle Point Developments LLC, and acknowledged the foregoing instrument to be his Voluntary act and deed.

Before me: Patricia L. Thomas
Notary Public

We, U. S. BANK NATIONAL ASSOCIATION, the undersigned beneficiary of a certain Trust Deed recorded August 13, 1999 as Document No. 99-42463 Official Records of Jackson County, Oregon, affecting the land described herein, hereby release from the lien of said Trust Deed, all property shown hereon as dedicated to the public for public use.

U.S. BANK NATIONAL ASSOCIATION by: [Signature]
Its Vice President THOMAS T. BYRER

STATE OF Oregon

COUNTY OF Multnomah

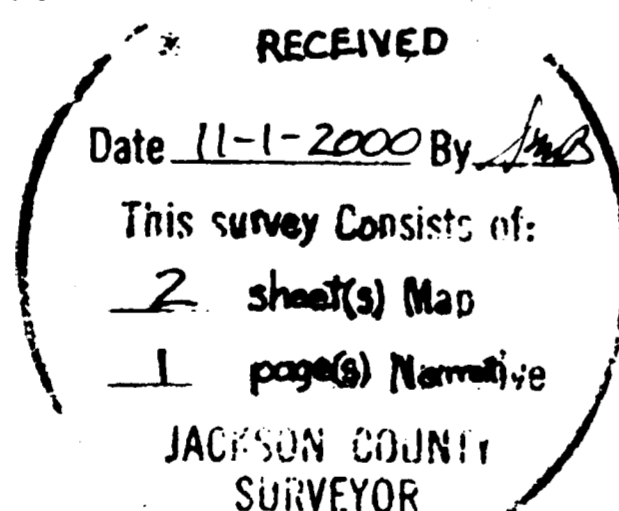

This certifies that on this 23rd day of October, 2000, before me a Notary Public,

personally appeared Thomas T. Byrer, and acknowledged the foregoing instrument to be their Voluntary act and deed.

Before me: Darci B. Hall
Notary Public

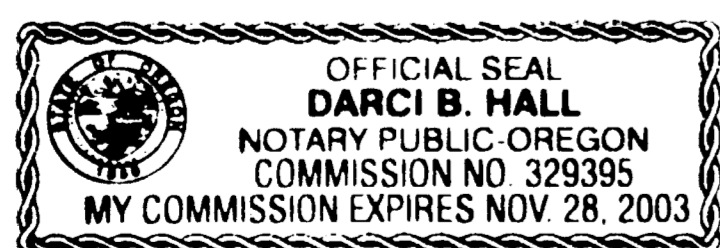

EAGLE POINT GOLF COMMUNITY, PHASE 1

LOCATED IN
SW 1/4 OF SECTION 2, AND THE NW 1/4 OF SECTION 11
T.36S., R.1W., W.M.
CITY OF EAGLE POINT, JACKSON COUNTY, OREGON

I, Richard G. Templin, a duly registered surveyor of the State of Oregon, do hereby certify that I have correctly surveyed and marked with the proper monuments as provided by law the tract of land hereon shown and the plat is a correct representation of the same, and the following is an accurate description of the boundary lines:

Beginning at the INITIAL POINT, a 5/8" iron rod at the Northeast corner of Lot 2, " LAKESIDE PARK ", as recorded in Volume 26, Page 09 of the records of Jackson County, Oregon and filed as Survey number 16459 (being also the Initial Point of said " LAKESIDE PARK "); thence North 87°50'48" West along the North line of said " LAKESIDE PARK ", 308.05 feet to a 5/8" iron rod at the Northwest corner of Lot 3 of said " LAKESIDE PARK "; thence North 15°03'13" West, 183.00 feet to a 5/8" iron rod; thence North 85°00'00" West, 907.00 feet to a 5/8" iron rod; thence North 12°28'18" West, 291.43 feet to a 5/8" iron rod; thence North 89°56'30" East, 97.36 feet to a 5/8" iron rod; thence North 54°12'11" East, 141.97 feet to a 5/8" iron rod; thence North 82°26'30" East, 53.92 feet to a 5/8" iron rod; thence North 51°55'02" East, 124.91 feet to a 5/8" iron rod; thence South 37°49'11" East, 40.00 feet to a 5/8" iron rod; thence North 34°14'00" East, 176.13 feet to a 5/8" iron rod; thence East, 207.56 feet to a 5/8" iron rod; thence South 69°05'25" East, 49.01 feet to a 5/8" iron rod; thence South 49°56'22" East, 578.06 feet to a 5/8" iron rod; thence South 25°51'01" East, 99.59 feet to a 5/8" iron rod; thence South 11°19'59" East, 207.59 feet to a 5/8" iron rod; thence South 48°13'02" East, 72.38 feet to a 5/8" iron rod; thence South, 102.29 feet to the true point of beginning.

[Signature]
RICHARD G. TEMPLIN LS 2359

We, Eagle Point Developments LLC, an Oregon limited liability company, the undersigned beneficiaries of a certain Trust Deed recorded August 13, 1999 as Document No. 99-42678, and assigned by instrument recorded May 18, 2000 as Document No. 00-20936, along with a certain Trust Deed recorded August 13, 1999 as Document No. 99-42679, and assigned by instrument recorded May 18, 2000 as Document No. 00-20937, Official Records of Jackson County, Oregon, affecting the land described herein, hereby release from the lien of said Trust Deed, all property shown hereon as dedicated to the public for public use.

Eagle Point Developments LLC by: [Signature]
Its member C. A. Galpin

STATE OF Oregon

COUNTY OF Jackson



This certifies that on this 11th day of October, 2000, before me a Notary Public,

personally appeared C. A. Galpin, member of Eagle Point Developments LLC, and acknowledged the foregoing instrument to be their Voluntary act and deed.

Before me: Patricia L. Thomas
Notary Public

I CERTIFY THAT THIS IS AN EXACT COPY OF THE ORIGINAL PLAT.

[Signature]
RICHARD G. TEMPLIN L.S. 2359

FOR: Eagle Point Development L.L.C.
501 Spencer St.
Medford, Or. 97504

APPROVALS

Examined and approved this 11th day of October, 2000
[Signature]
JACKSON COUNTY SURVEYOR

All deferred monuments will be set no later than January 1, 2001.
[Signature]
RICHARD G. TEMPLIN LS 2359

All deferred monuments are now set, see Document No. 00-80421 of Official Records, this 14th day of DECEMBER, 2000

Approved by Jackson County Surveyor.
[Signature]
JACKSON COUNTY SURVEYOR

Examined and recommended for approval this 17 day of October, 2000.
[Signature]
CITY ENGINEER

Examined and recommended for approval by Bear Creek Valley Sanitary Authority this 16 day of OCTOBER, 2000.
[Signature]
DISTRICT ENGINEER

Examined and approved by the City Administrator/Planning Director of the City of Eagle Point, Jackson County, Oregon. Dated this 26 day of October, 2000.
[Signature]
CITY ADMINISTRATOR / PLANNING DIRECTOR

Examined and approved as required by O.R.S. 92.100 as of October 27, 2000.
[Signature]
ASSESSOR, DEPARTMENT OF ASSESSMENT

All taxes, fees, assessments or other charges as required by O.R.S. 92.095 have been paid as of October 27, 2000.

[Signature]
TAX COLLECTOR

RECORDERS CERTIFICATE

For order of the County Commission approving this plat see Volume _____, Page _____ of County Commissioners Journal of Proceedings.

Filed for record this 1 day of November, 2000 at 1:30 o'clock P.M. and recorded in Volume 26 of Plats at page 43 of records of Jackson County, Oregon.

[Signature]
COUNTY CLERK

[Signature]
DEPUTY

FILE: "phase1ver10pg1.DWG"

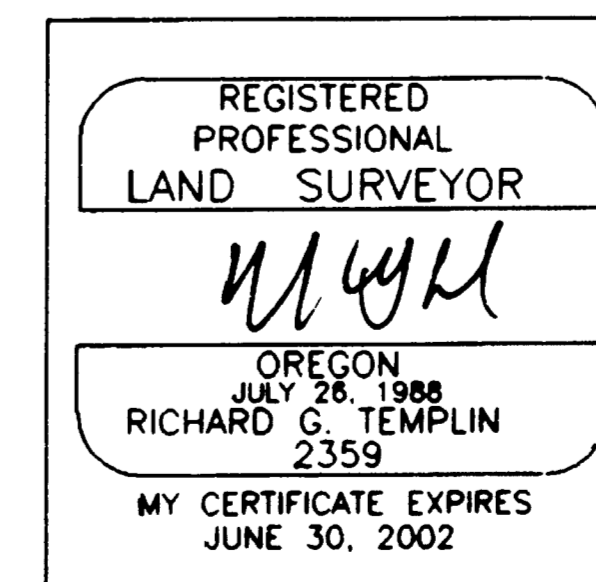

RICHARD TEMPLIN LAND SURVEYING
P.O. BOX 1946 899-2032 JACKSONVILLE, OREGON
EAGLE POINT GOLF COMMUNITY
PHASE 1
LOCATED IN
SW 1/4 OF SECTION 2, AND THE NW 1/4 OF SECTION 11
T.36S., R.1W., W.M.
CITY OF EAGLE POINT, JACKSON COUNTY, OREGON
DATE: OCTOBER 10, 2000