

**CURVE TABLE**

NUM	DELTA	ARC	RADIUS	BEARING	DISTANCE
C1	31°15'20"	111.53'	204.45'	N53°22'30"E	110.15'
C2	31°15'20"	127.89'	234.45'	N53°22'30"E	126.31'
C3	31°15'20"	144.26'	264.45'	N53°22'30"E	142.47'
C4	46°08'45"	144.58'	179.52'	S45°55'47"W	140.71'
C5	46°08'45"	120.42'	149.52'	S45°55'47"W	117.19'
C6	46°08'45"	96.26'	119.52'	S45°55'47"W	93.68'
C7	49°45'06"	178.88'	206.01'	S2°01'08"E	173.32'
C8	49°45'06"	152.83'	176.01'	S2°01'08"E	148.08'
C9	49°45'06"	126.78'	146.01'	S2°01'08"E	122.84'
C10	42°50'04"	199.32'	266.61'	N5°28'39"W	194.71'
C11	42°50'04"	221.74'	296.61'	N5°28'39"W	216.61'
C12	42°50'04"	244.17'	326.61'	N5°28'39"W	238.52'
C13	15°31'02"	197.70'	730.00'	N23°41'54"E	197.10'
C14	15°31'02"	205.84'	760.00'	N23°41'54"E	205.21'
C15	15°31'02"	213.97'	790.00'	N23°41'54"E	213.31'
C16	10°06'56"	276.30'	1565.00'	S26°23'57"W	275.94'
C17	10°06'56"	271.00'	1535.00'	S26°23'57"W	270.65'
C18	10°06'56"	265.71'	1505.00'	S26°23'57"W	265.36'
C19	22°17'27"	210.09'	540.00'	N32°29'12"E	208.76'
C20	22°17'27"	221.77'	570.00'	N32°29'12"E	220.37'
C21	22°17'27"	233.43'	600.00'	N32°29'12"E	231.96'
C22	13°29'29"	184.84'	785.00'	S31°48'07"W	184.42'
C23	18°34'33"	244.80'	755.00'	S34°20'42"W	243.73'
C24	17°22'56"	219.95'	725.00'	S33°44'51"W	219.11'
C25	12°23'21"	177.31'	820.00'	N31°15'04"E	176.97'
C26	12°23'21"	183.80'	850.00'	N31°15'04"E	183.45'
C27	12°23'21"	190.28'	880.00'	N31°15'04"E	189.92'
C28	45°54'01"	96.13'	120.00'	N60°23'44"E	93.58'
C29	45°54'01"	120.17'	150.00'	N60°23'44"E	116.98'
C30	45°54'01"	144.20'	180.00'	N60°23'44"E	140.37'
C31	87°22'03"	182.98'	120.00'	S39°39'43"W	165.76'
C32	87°22'03"	137.24'	90.00'	S39°39'43"W	124.32'
C33	87°22'03"	91.49'	60.00'	S39°39'43"W	82.88'
C34	5°05'09"	69.68'	785.00'	S41°05'21"W	69.66'
C35	1°11'43"	15.13'	725.00'	S43°02'05"W	15.12'
C36	18°34'33"	254.50'	785.00'	S34°20'42"W	253.41'
C37	18°34'33"	235.05'	725.00'	S34°20'42"W	234.02'

**LINE TABLE**

NUM	DISTANCE	BEARING
L1	255.43'	S37°44'50"W
L2	55.61'	S89°00'10"W
L3	150.36'	S22°51'25"W
L4	69.97'	S26°53'41"E
L5	203.83'	S15°56'23"W
L6	13.31'	S31°27'25"W
L7	315.24'	S21°20'29"W
L8	29.45'	S43°37'56"W
L9	44.77'	S25°03'23"W
L10	82.83'	S37°26'44"W
L11	67.27'	S83°20'45"W

**EASEMENT NOTES:**

EASEMENT SET FORTH IN INSTRUMENT NO. 85-02811 TO PACIFIC POWER AND LIGHT DOES NOT LIE WITHIN THE BOUNDARIES OF THIS PLAT.

THE EASEMENT FOR INGRESS AND EGRESS AS SET FORTH IN INSTRUMENT NO. 86-13111 AND 86-13113 DOES NOT LIE WITHIN THE BOUNDARIES OF THIS PLAT.

RESTRICTIVE COVENANTS AS IMPOSED BY JACKSON COUNTY DEPARTMENT OF PLANNING AND DEVELOPMENT AND RECORDED AS INSTRUMENT NO. 91-01945 AND 94-22029 EFFECTS PARCELS NO 1, 2 AND 3 AS SHOWN HEREON.

I, Herbert A. Farber, do hereby certify that this is an exact copy of the original.

*Herbert A. Farber*

REGISTERED PROFESSIONAL LAND SURVEYOR

*Herbert A. Farber*

OREGON  
JULY 26, 1985  
HERBERT A. FARBER  
2189

RENEWAL DATE 12-31-01

PARTITION PLAT NO. P-33-2000  
of  
**Parcel No 2, P-139-1991**  
located in  
SOUTHWEST ONE QUARTER OF SECTION 33  
TOWNSHIP 38 SOUTH, RANGE 2 WEST  
WILLAMETTE MERIDIAN, JACKSON COUNTY, OREGON  
for  
**STERLING MINE PROPERTIES**  
823 WEST 8TH STREET  
MEDFORD, OREGON 97501

- LEGEND**
- ⊗ = FOUND 2 1/2" BRASS CAP-1/4 SECTION CORNER PER JACKSON SURVEYOR'S RECORDS
  - ⊕ = FOUND 2 1/2" BRASS CAP, PER BLM PLAT DATED 1-22-1999 TIED S/N 13381 NOT RETIED THIS SURVEY, SEE BLM NOTES
  - ⊙ = FOUND 5/8" IRON PIN w/ YELLOW PLASTIC CAP MARKED "FARBER LS 2189" PER S/N 12350
  - = FOUND 5/8" IRON PIN w/ YELLOW PLASTIC CAP MARKED "FARBER LS 2189" PER S/N 12817
  - = FOUND 5/8" x 30" IRON PIN w/ YELLOW PLASTIC CAP MARKED "FARBER PLS 2189" PER S/N 13381
  - = FOUND 5/8" x 24" IRON PIN w/ YELLOW PLASTIC CAP MARKED "FARBER PLS 2189" PER S/N 13381 UNLESS NOTED
  - S/N = RECORD FILED SURVEY NUMBER
  - W.C. = WITNESS CORNER
- BASIS OF BEARING IS TRUE NORTH, NAD 83/91 DATUM, AS DERIVED BY GLOBAL POSITIONING SYSTEM OBSERVATIONS.  
- RECORD SURVEY DATA IS SHOWN IN PARENTHESIS ADJACENT TO MEASURED SURVEY DATA WHERE APPLICABLE.  
- INST. No. = INSTRUMENT NUMBER AS RECORDED IN THE OFFICIAL RECORDS OF JACKSON COUNTY, OREGON.  
- ALL POSITIONS VISITED BUT NOT TIED ON THIS SURVEY

**SURVEY NARRATIVE  
TO COMPLY WITH O.R.S. 209.250**

**PURPOSE:** TO SURVEY AND MONUMENT THE LAND PARTITION AS APPROVED BY JACKSON COUNTY DEPARTMENT OF PLANNING AND DEVELOPMENT, FILE No. 2000-3-MP

**PROCEDURE:** THIS PARTITION WAS ORIGINALLY SURVEYED IN 1992 AND WAS NOT COMPLETED. SUBSEQUENT TO THIS TIME THE BLM RESURVEYED AND PLATTED SECTION 33, UTILIZING EXISTING MONUMENTATION, ESTABLISHED BY THIS OFFICE IN S/N 13381, 12817, 12350 AND THE BLM SURVEY THIS PLAT WAS PREPARED AS SHOWN HEREON.

Surveyed by:  
**FARBER & SONS, INC.**  
dba FARBER SURVEYING  
(541) 776-0846

OFFICE LOCATION: 120 MISTLETOE MEDFORD, OREGON 97501  
MAILING ADDRESS: P.O. BOX 5286 CENTRAL POINT, OREGON 97502

SCALE: 1" = 200'  
DATE: MAY 8, 2000  
JOB NO.: 0069-89C  
DRAWING FILE: JOBS\STERLING\TL108PARTTRIM.FLX

Surveyor's Certificate:

I, Herbert A. Farber, a duly registered Professional Land Surveyor of the State of Oregon, do hereby certify that I have correctly surveyed and marked with proper monuments, as provided by law, the tract of land hereon shown, this plat being a correct representation of the same, and the following is an accurate description of the boundary lines of Parcel No. 2 of Partition Plat No. P-139-1991, of the records of Jackson County, Oregon, Index Volume 2, Page 139, County Surveyor's File No. 12817, more particularly described as follows:

Commencing at the southeast corner of the Southwest Quarter of Section 33, Township 38 South, Range 2 West of the Willamette Meridian, Jackson County, Oregon; thence North 0°35'49" West, along the East line of said quarter 25.00 feet to the Initial Point being a 5/8 inch iron pin; thence South 89°27'40" West, along the South line of Parcel No. 2 of Partition Plat No. P-139-1991 of the Records of Jackson County, Oregon, 1410.13 feet to a point on the Easterly right of way of Griffin Lane as described in Instrument No. 90-32155 of the Official Records of Jackson County, Oregon; thence North 4°01'18" West along said right of way 67.28 feet; thence along the arc of a curve to the right, having a central angle of 87°22'03", a radius of 60.00 feet, a length of 91.49 feet; thence North 83°20'45" East, 67.27 feet; thence along the arc of a curve to the left, having a central angle of 45°54'01", a radius of 180.00 feet, a length of 144.20 feet; thence North 37°26'44" East, 82.83 feet; thence along the arc of a curve to the left, having a central angle of 12°23'21", a radius of 880.00 feet, a length of 190.28 feet; thence North 25°03'23" East, 44.77 feet; thence along the arc of a curve to the right, having a central angle of 18°34'33", a radius of 725.00 feet, a length of 235.05 feet; thence North 43°37'56" East, 29.45 feet; thence along the arc of a curve to the left, having a central angle of 22°17'27", a radius of 600.00 feet, a length of 233.43 feet; thence North 21°20'29" East, 315.24 feet; thence along the arc of a curve to the right, having a central angle of 10°06'56", a radius of 1505.00 feet, a length of 265.71 feet; thence leaving said right of way South 76°49'57" East, along the Northerly line of said parcel 495.05 feet to the Northeast corner of the Southeast quarter of the Southwest quarter of said section; thence South 0°35'49" East along the east line of the quarter, quarter of said section, 1292.32 feet to the Initial Point.

TOGETHER WITH the following described parcel:

Beginning (Initial Point) at the Northwest corner of the Northeast quarter of the Southwest quarter of Section 33, Township 38 South, Range 2 West of the Willamette Meridian, Jackson County, Oregon, thence North 89°38'35" East along the North line of Parcel No. 2 of Partition Plat No. P-139-1991, 1225.49 feet to a point on the Westerly right of way of Griffin Lane as described in Instrument No. 90-32155 of the Official Records of Jackson County, Oregon; thence South 37°44'50" West, along said right of way 41.98 feet; thence along the arc of a curve to the right having a central angle of 31°15'20", a radius of 204.45 feet, a length of 111.53 feet; thence South 69°00'10" West, 55.61 feet; thence along the arc of a curve to the left having a central angle of 46°08'45", a radius of 179.52, a length of 144.58 feet; thence South 22°51'25" West, 150.36 feet; thence along the arc of a curve to the left having a central angle of 49°45'06", a radius of 206.01 feet, a length of 178.88 feet; thence South 26°53'41" East, 69.97 feet; thence along the arc of a curve to the right having a central angle of 42°50'04", a radius of 266.61 feet, a length of 199.32 feet; thence South 15°56'23" West, 203.83; thence along the arc of a curve to the right having a central angle of 15°31'02", a radius of 730.00 feet, a length of 197.70 feet; thence South 31°27'25" West, 13.31 feet; thence along the arc of a curve to the left having a central angle of 10°06'56", a radius of 1565.00 feet, a length of 276.30 feet; thence South 21°20'29" West, 315.24 feet; thence along the arc of a curve to the right having a central angle of 22°17'27", a radius of 540.00 feet, a length of 210.09 feet; thence South 43°37'56" West, 29.45 feet; thence along the arc of a curve to the left having a central angle of 18°34'33", a radius of 785.00 feet, a length of 254.50 feet; thence South 25°03'23" West, 44.77 feet; thence along the arc of a curve to the right having a central angle of 12°23'21", a radius of 820.00 feet, a length of 177.31 feet; thence South 37°26'44" West, 82.83 feet; thence along the arc of a curve to the right having a central angle of 45°54'01", a radius of 120.00 feet, a length of 96.13 feet; thence South 83°20'45" West, 67.27 feet; thence leaving said right of way North 63°52'33" West, along the Southerly line of said parcel, 334.71 feet, thence North 18°21'44" East, along the Westerly line of said parcel 1008.25 feet to the Southwest corner of said quarter; thence North 0°25'04" West, along the West line of said quarter, 345.85; thence continuing along the West line of said quarter, quarter, North 0°23'11" West, 973.85 feet to the Point of Beginning.

Herbert A. Farber, PLS 2189

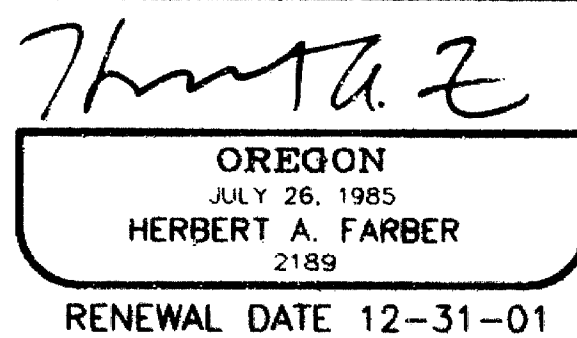
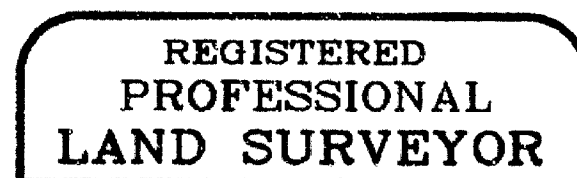

I, Herbert A. Farber, do hereby certify that this is an exact copy of the original.

Herbert A. Farber

PARTITION PLAT No. P-33-2000

of Parcel No 2, P-139-1991

located in SOUTHWEST ONE QUARTER OF SECTION 33, TOWNSHIP 38 SOUTH, RANGE 2 WEST OF THE WILLAMETTE MERIDIAN, JACKSON COUNTY, OREGON.

STERLING MINE PROPERTIES

823 WEST 8TH STREET MEDFORD, OREGON 97501

Declaration:

KNOW ALL MEN BY THESE PRESENTS, that John Henderson and Robert M. Fasel, Trustee of ROBERT M. FASEL REVOCABLE TRUST AGREEMENT, dated September 21, 1994 are the owners of the lands hereon described, and that they have partitioned the same into parcels as shown hereon and size of the parcels and the lengths of the lines are plainly set forth, and do hereby grant an easement for ingress and egress over the existing road shown hereon benefiting the southwest quarter of the southeast quarter of Section 33 as shown hereon and that this plat is a correct representation of the Partition.

John Henderson

Robert M. Fasel, Trustee

State of Oregon ) County of Jackson )

The foregoing instrument was acknowledged before me this 23rd day of May, 2000, by John Henderson

Notary Public for Oregon Wendi Greb My commission expires July 1, 2000

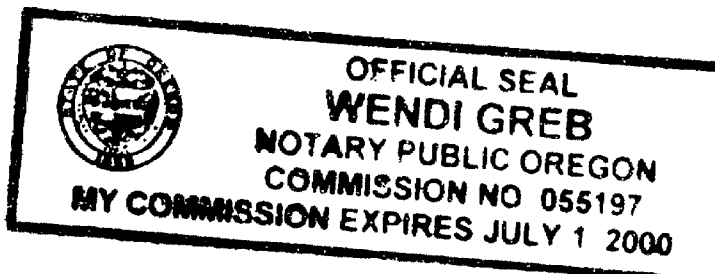

State of Oregon ) County of Jackson )

The foregoing instrument was acknowledged before me this 25th day of May, 2000, by Robert M. Fasel, Trustee.

Notary Public for Oregon Wendi Greb My commission expires July 1, 2000

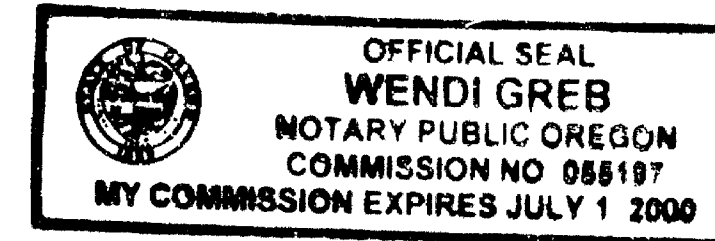

Approvals:

Examined and approved by Jackson County Department of Planning and Development, File No. 2000-3-MP

this 25th day of May 2000.

Sandy Mathewson for Planning Director

Examined and approved by the Jackson County Surveyor this 23rd day of May 2000.

Robert Roberts County Surveyor

All taxes, fees, assessments, or other charges as required by O.R.S. 92.095 have been paid as of May 26, 2000

Lynda Adsett, Deputy Tax Collector May 26, 2000 Date

Ron Lindsey, Deputy Assessor May 26, 2000 Date

Recorder:

Filed for record this 26 day of May, 2000 at 6:43 P. M. and recorded as Partition Plat No. P-33-2000 of the Records of Jackson County, Oregon. Index Volume 11, Page 33.

Kathleen S. Berkett County Clerk Cheryl Augers Deputy

County Surveyor's File No. 16529

