

OREGON CORNER RESTORATION FORM

16395

Section 9 Township 36S Range 1W

County Jackson Date 01/05/00

CORNER DESIGNATION

- Condition Report Only
- Not Found
- Renewed
- Unrecorded
- Surveyed In
- Referenced Out

Previous Renewals/Surveys, etc. 1976 Second Re-establishment by R. Roberts and E. Graham

Monument(s) & Accessories Found: (Condition and Source)

Found  $2\frac{1}{2}$ " brass cap and two accessories, per 1976 second re-establishment.

A  $5/8$ " rebar with plastic cap bears  $S35^{\circ}46'18"$  E, 171.37 feet.

A  $3/4$ " iron pin bears  $S88^{\circ}26'36"$  E, 230.05 feet.

These points were tied to a closed loop traverse that was based off of O.D.O.T. control prior to construction.

Monument Detail

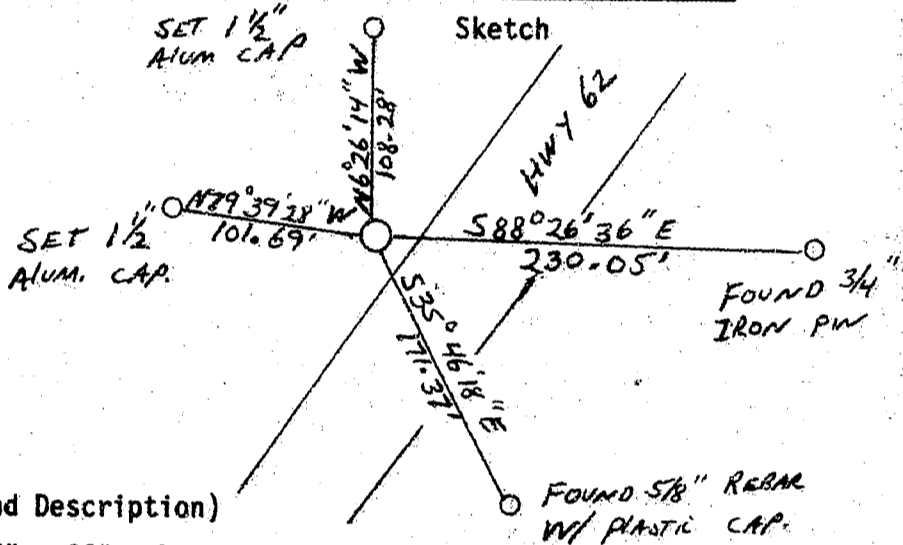
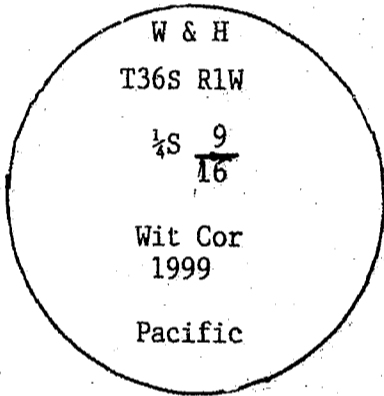

Monument Set (Procedures and Description)

Set 2" aluminum cap on  $5/8$ " x 30" rebar.

This point was re-established from the same control traverse from which it was tied, and checked to the found accessories.

New Accessories

Set  $1\frac{1}{2}$ " aluminum cap marked WH Pacific NW RP on  $5/8$ " x 30" rebar, which bears  $N6^{\circ}26'14"$  W, 108.28 feet.

Set  $1\frac{1}{2}$ " aluminum cap marked WH Pacific SW RP on  $5/8$ " x 30" rebar, which bears  $N79^{\circ}39'23"$  W, 101.69 feet.

Location & Comments

Bearings are calculated Compass Declination  
 based off of control Firm/Agency W&H Pacific  
 from ODOT for the Highway 62, Linn Road  
 to Dutton Road project. Address 1004 Main Street  
Klamath Falls, Oregon  
 Party Chief Travis Foster  
 Notes \_\_\_\_\_  
 Witness \_\_\_\_\_

Surveyor's Seal

