

OREGON CORNER RESTORATION FORM

16894

Section 9 Township 35S Range 2E

County JACKSON Date July 1998

Corner Designation

T35S R2E

S9 | S10  
1/4

- Condition Report Only
- Not Found
- Renewed
- Unrecorded
- Surveyed In
- Referenced Out

Previous Renewals/Surveys, etc.

Monument(s) & Accessories Found: (Condition and Source)

- FOUND JACKSON COUNTY BRASS CAP AT GROUND LEVEL
- 49" DOUGLAS FIR STUMP WITH OPEN FACE BEARS S40<sup>3</sup>/<sub>4</sub>° E 12.7 FEET
- 16" DOUGLAS FIR STUMP WITH HEALED FACE BEARS N58° E 41.5 FEET
- ROTTEN REMAINS OF STUMP BEARS N61° W 28.5 FEET

Monument Detail

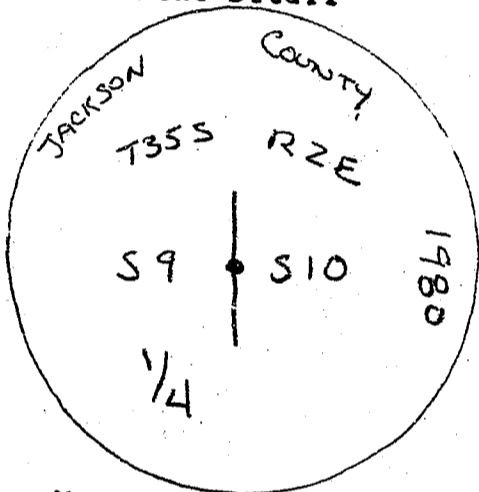

Sketch

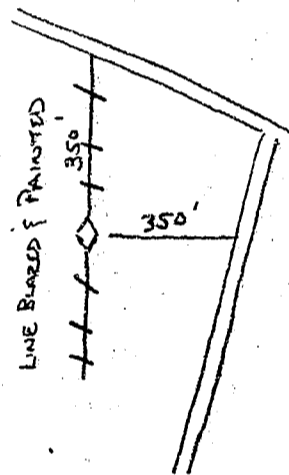

Monument Set (Procedures and Description)

New Accessories

- 15" DOUGLAS FIR BEARS S45<sup>3</sup>/<sub>4</sub>° W 14.5 FEET WE SCRIBE AND TAG TREE
- 15" DOUGLAS FIR BEARS N11<sup>1</sup>/<sub>4</sub>° W 41.8 FEET WE SCRIBE AND TAG TREE
- 15" DOUGLAS FIR BEARS N37<sup>3</sup>/<sub>4</sub>° E 39.4 FEET WE SCRIBE AND TAG TREE

Location & Comments

CORNER IS AT GROUND  
LEVEL APPROX. 350  
FEET SOUTH OF AQUADULT  
ROAD.

Compass Declination 19 1/2<sup>o</sup>  
Firm/Agency LOWE ROCK  
TIMBER COMPANY  
Address P.O. BOX 1127

Surveyor's Se

REGISTERED  
PROFESSIONAL  
LAND SURVEYOR

*Ken W. Hoffine*

OREGON  
JULY 18, 1997  
KEN W. HOFFINE  
2291

Party Chief GARY ANGIOLAT  
Notes GARY ANGIOLAT  
Witness MARK D

\*\* RECEIVED \*\*  
Date 12/15/99 By CFD  
This survey consists of:  
1 sheet(s) Map  
0 page(s) Narrative  
JACKSON COUNTY  
SURVEYOR