

Narrative of Survey

Purpose: establish property corner monuments

Procedure :

A previously established control traverse was utilized to evaluate the found 1 inch iron pipe of unknown origin as shown hereon. Also previous ties to found 3/8" iron pipes recovered by Surveyor C.H. Ketchum in 1976 (f.s. 6405) and recovered by this firm as shown on f.s.15381 were used as well. The origin of these 3/8" pipes were never disclosed by Ketchum but they provide very good control for the tracts of land abutting Baum Street. The found aluminum cap of unknown origin at the centerline of Church Street, previously shown on filed surveys 15381 & 15163, was thought to control the centerline intersection of Church & Baum Streets or Church & Almond Streets. However, despite being on the centerline of Church it isn't on the centerlines of Baum or Almond.... unknown monument set for unknown reasons presumably.

There is an excess of land concerning the tracts along Church bounded by Baum Street and High Street. My client's property is part of the old "Church" Lot conveyed to the Presbyterian Church by John Helman in 1867 (Volume 4 Page 465 of the Deed Records of Jackson County, Oregon) and is the senior tract in this area. Accordingly it was given it's full dimension less the Baum Street right of way; which was conveyed later to the City of Ashland in 1888 (Volume 17 Page 207). There was no attempt to determine junior-senior rights on the remaining tracts affected by this excess.

Section corner common to Sections 4, 5, 8, & 9 computed from Jackson County Surveyor's references including Jackson County GPS station No.163

Map of SURVEY
located in
Donation Land Claim No.40 in the Northeast One/Quarter of Section 8 Township 39 South of Range 1 East of the Willamette Base and Meridian in the City of Ashland
JACKSON COUNTY OREGON
found: 3" brass disk in monument case for the centerline of Church & High Streets
Jon Barry & Jennifer Jones
134 Church Street
Ashland, Oregon 97520

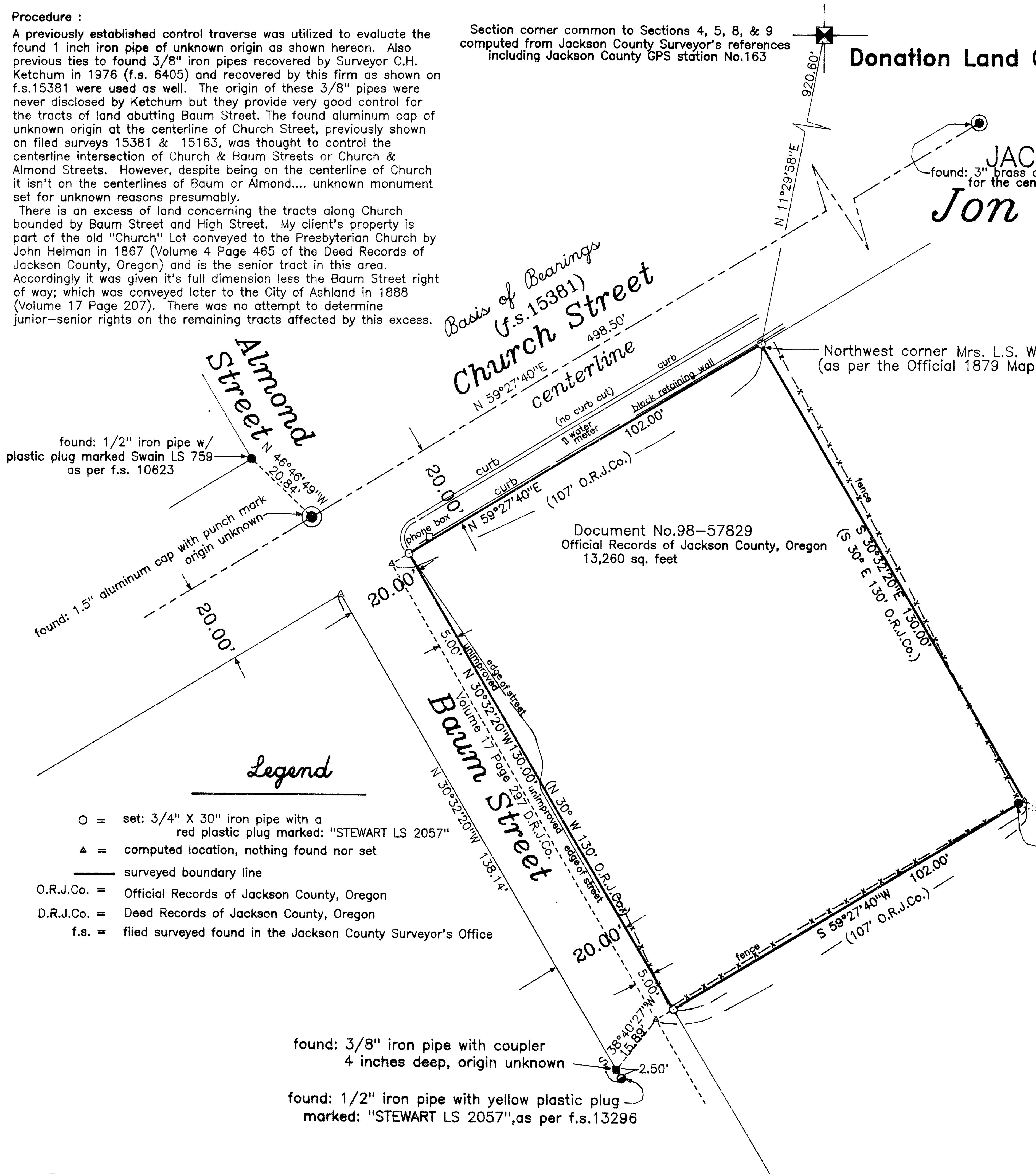

SURVEYOR

STEWART LAND SURVEYS May 7, 1999
6370 Highway 66
Ashland, Oregon 97520
SCALE: 1" = 20'
BASIS OF BEARING:

phone (541) 488-2831
filed survey No.15381

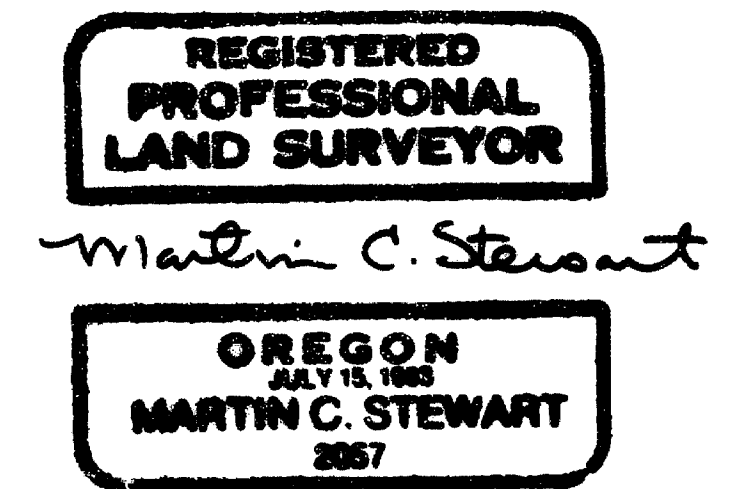

Surveyor's Registration
Renewal Date is June 30, 2000

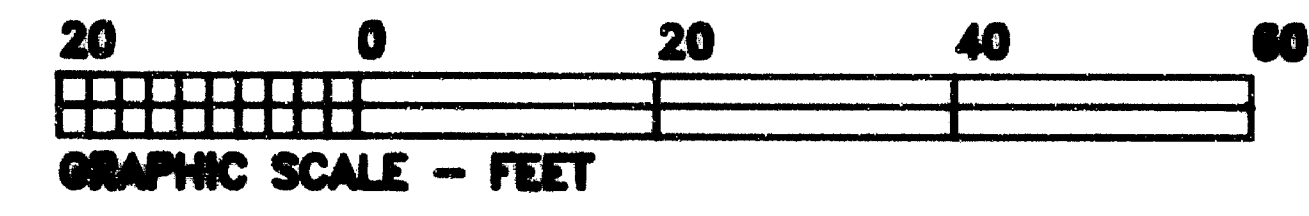
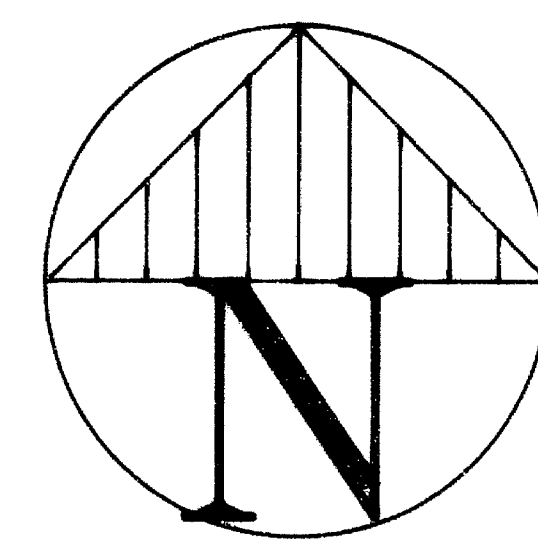

- Legend**
- = set: 3/4" X 30" iron pipe with a red plastic plug marked: "STEWART LS 2057"
 - ▲ = computed location, nothing found nor set
 - surveyed boundary line
 - O.R.J.Co. = Official Records of Jackson County, Oregon
 - D.R.J.Co. = Deed Records of Jackson County, Oregon
 - f.s. = filed surveyed found in the Jackson County Surveyor's Office

**** RECEIVED ****
Date 8-20-99 By BF
This survey consists of:
1 sheet(s) Map
0 page(s) Narrative
JACKSON COUNTY SURVEYOR

file: 91e8ad-3.crd & 91e4cd-2.crd & 91e8ad-6.pl1
job: jn-9907

Tax Lot 4900 of Assessor's Map 39s-1e-8aa

sheet One of One