

Survey For  
 WH DOUGHERTY  
 ELK LUMBER CO  
 Located in Secs. 31, 32, & 33 T. 32 S., R. 2 E., WM  
 Secs. 6, 5, & 4 T. 33 S., R. 2 E., WM  
 By Boyden & Boyden  
 May, 1954

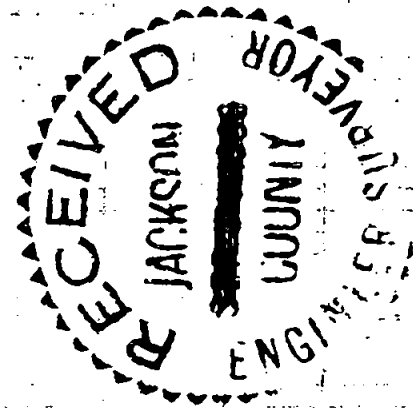

SCALE: 1" = 1320'  
 ○ Set 1" iron pipe  
 ● Re-established Govt. cor.

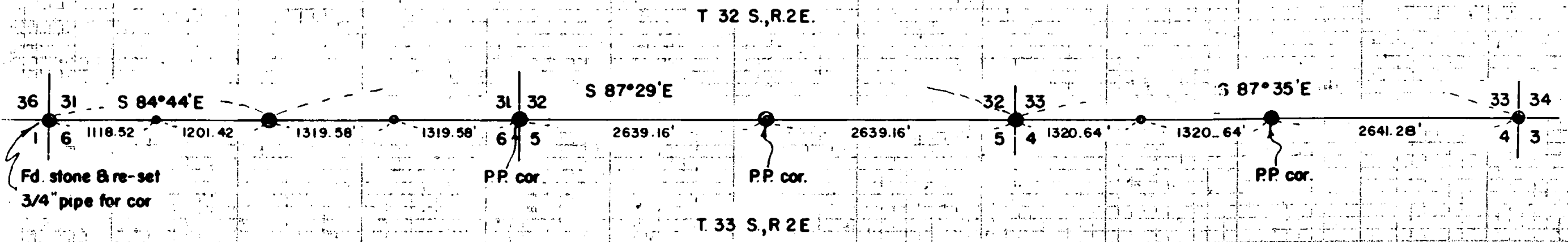

REGISTERED  
 OREGON  
 LAND SURVEYOR

*Mark E. Boyden*  
 NOVEMBER 9, 1951  
 MARK E. BOYDEN  
 281

SURVEY NARRATIVE TO COMPLY WITH PARAGRAPH 209.250

OREGON REVISED STATUTES

FOR: W.H. DOUGHERTY &  
ELK LUMBER CO.

PURPOSE:

To monument corners along the Township line between Sections 31, 32, and 33, Township 32 South, Range 2 East and between Sections 6, 5, and 4, Township 33 South, Range 2 East as shown.

PROCEDURE:

With transit and chain on random lines traversed between the Southeast corner of Section 33 and the Southwest corner of Section 31, Township 32 South, Range 2 East, finding original corner evidence at the South 1/4 corner of Section 31, the Southeast corner of Section 32, the Southeast corner of Section 33 and the Southwest corner of Section 31 in Township 32 South, Range 2 East.

Monumented the true corners with iron pipe and marked new witness trees which references are duly recorded in the establishment and re-establishment records in the County Surveyors office.

Meridian determined by Solar observation.

Sept. 1960

