

# CITY OF MEDFORD MAPPING CONTROL SURVEY

MARCH 23, 1998  
SEE ATTACHED NARRATIVE

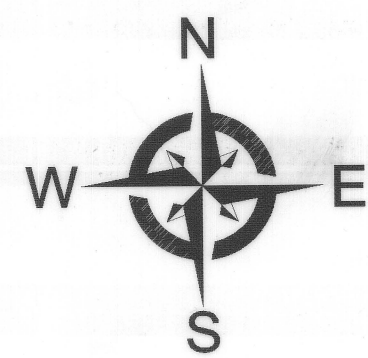

MEDFORD  
AND VICINITY

SCALE IN FEET

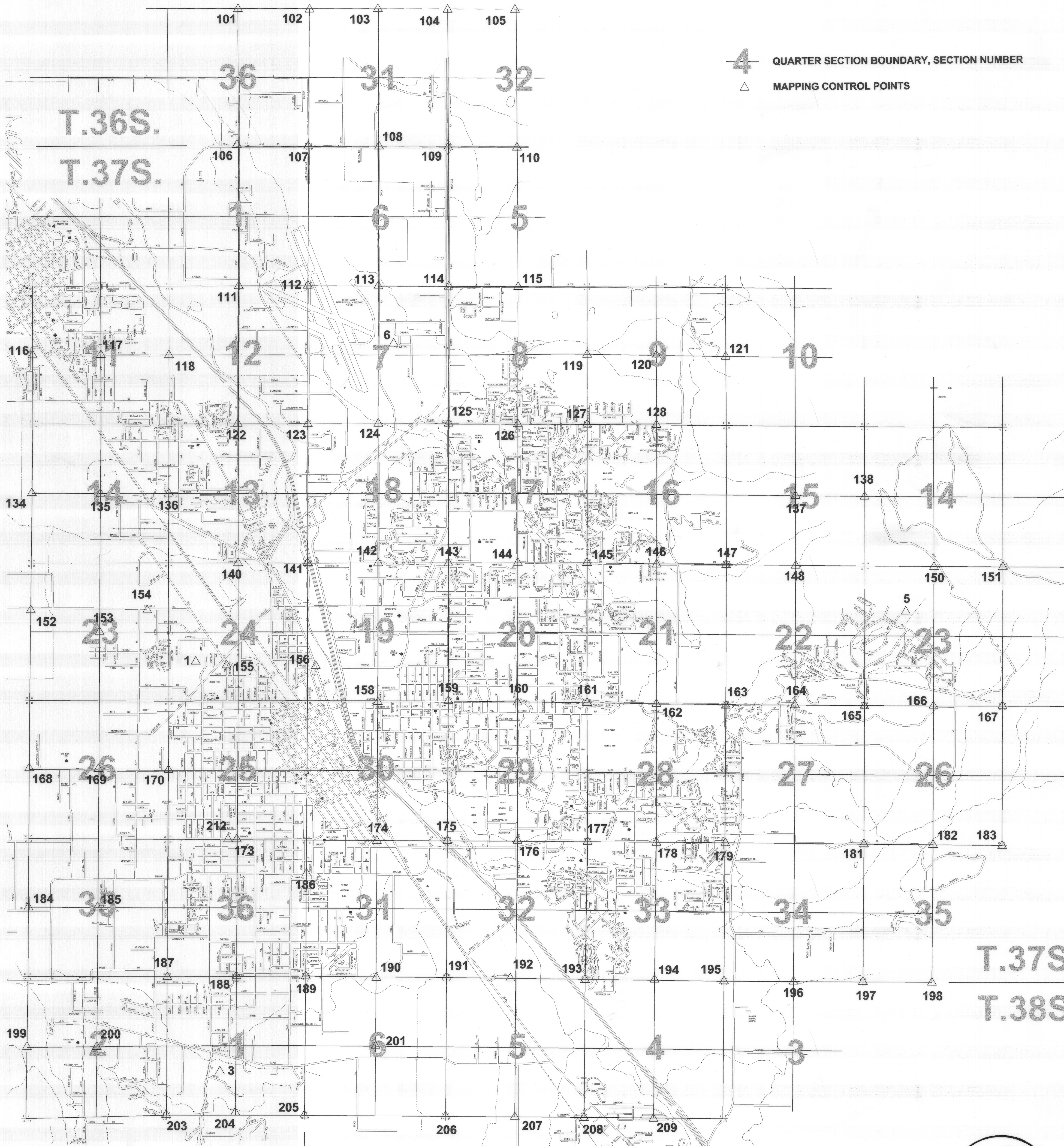
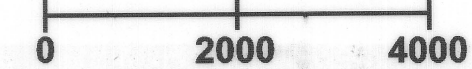

**4** QUARTER SECTION BOUNDARY, SECTION NUMBER  
△ MAPPING CONTROL POINTS

T.36S.  
T.37S.

T.37S.  
T.38S.

R.2W.  
R.1W.

REGISTERED  
PROFESSIONAL  
LAND SURVEYOR  
*Paul D. Lewis*  
OREGON  
JULY 24, 1978  
PAUL D. LEWIS  
1.6.4.4  
001005 12-31-98

\*\* RECEIVED \*\*  
Date: 11-20-98 By: *PL*  
This survey consists of:  
1/4 sheet(s) Map  
1/4 page(s) Narrative  
JACKSON COUNTY  
SURVEYOR

SURVEY NUMBER 15965

SURVEY NARRATIVE TO COMPLY WITH ORS 209.250(5) & (6)

DATE: March 23, 1998

SURVEY FOR: City of Medford  
411 West Eighth Street  
Medford, Oregon 97501

SURVEY BY: Paul Lewis, City Surveyor  
City of Medford Engineering Department, Survey Division  
411 W. 8th Street  
Medford, Oregon 97520

EQUIPMENT: Wild GPS System 200, Model 299 receivers, "SKI" version  
1.09 data reduction software.

PURPOSE: To establish horizontal and vertical positions for  
mapping control.

DATUM: Horizontal: Oregon State Plane, South Zone, NAD 83/91  
Vertical: NGVD 1929  
Units: Meters

PROCEDURE: This survey was controlled by Jackson County Surveyor  
point #146 and City of Medford point "Pumice". Geodetic  
positions and WGS 84 ellipsoid heights for these were  
provided by the Jackson County Surveyor's Office.  
Utilizing three receivers, a series of closed loops were  
observed.

**\*\* RECEIVED \*\***  
Date 11-20-98 By PL  
This survey Consists of:  
1 sheet(s) Map  
4 page(s) Narrative  
JACKSON COUNTY  
SURVEYOR

Vertical reductions were processed using the NGS "GEOID  
96" geoid model, since a model approximating the City  
datum, NGVD 1929, was not available. A random sampling of  
control points tied to City datum yielded an offset of  
negative 1.18 meters, (GEOID 96 to City datum).

Horizontal and vertical values are within our  
photogrammetrist's specifications of +/- 7 centimeters.  
Independent observations of City of Medford point "Woods"  
and the National Geodetic Survey HARN point "Justice"  
checked horizontally to within 1 cm. of published values.

See attached map.

REGISTERED  
PROFESSIONAL  
LAND SURVEYOR  
*Paul D. Lewis*  
OREGON  
JULY 14, 1978  
PAUL D. LEWIS  
1644

EXPIRES 12/31/98

15965

POINT NUMBER	EASTING METERS	NORTHING METERS	CITY ELEV. METERS	DESCRIPTION
1	1302981.36	76959.89	416.27	SET 0.38 CALIBER SHELL IN CONCRETE
3	1303229.73	72220.32	468.24	SET 0.38 CALIBER SHELL IN CONCRETE
5	1311177.89	77412.52	661.64	SET 0.38 CALIBER SHELL IN CONCRETE
6	1305356.94	80673.42	402.90	SET 0.38 CALIBER SHELL IN CONCRETE
101	1303655.04	84685.27	386.44	SET NAIL WITH SHINER
102	1304469.16	84662.40	386.63	FOUND 2-1/2" BRASS CAP, SECTION CORNER 31, 36, 25, 30, T36S, R1&2W
103	1305287.26	84621.29	390.36	SET 1/2" X 10" IRON PIN
104	1306089.68	84611.07	393.38	FOUND 2-1/2" BRASS CAP, SECTION CORNER 29, 30, 31, 32, T36S, R1W
105	1306887.51	84597.65	403.34	SET 1/2" X 10" IRON PIN
106	1303601.21	83092.70	390.90	FOUND OSHD R/W PIN WITH METAL CAP
107	1304425.42	83048.49	393.27	FOUND 3" BRASS CAP IN MONUMENT CASE, TOWNSHIP CORNER, T36&37S, R1&2W
108	1305237.85	83014.87	396.94	SET NAIL WITH SHINER
109	1306053.53	82994.48	397.76	FOUND BRASS CAP, SECTION CORNER 5, 6, 31, 32, T36&37S, R1W
110	1306861.29	82969.58	403.69	FOUND BRASS CAP, 1/4 SECTION CORNER, 5&32 T36&37S, R1W
111	1303566.42	81451.45	389.03	FOUND BRASS CAP IN MONUMENT CASE, 1/4 SECTION CORNER, 1, 12, T37S, R2W
112	1304377.87	81434.09	397.18	SET 1/2" X 12" IRON PIN
113	1305202.57	81405.81	398.51	FOUND 2-1/2" BRASS CAP, 1/4 SECTION CORNER, 6&7, T37S, R1W
114	1306008.99	81380.30	408.84	FOUND 2-1/2" BRASS CAP, SECTION CORNER 5, 6, 7, 8, T37S, R1W
115	1306815.10	81357.90	442.83	FOUND 2-1/2" BRASS CAP, 1/4 SECTION CORNER 5&6, T37S, R1W
116	1301129.25	80711.41	393.85	SET 1/2" X 12" PIN
117	1301882.86	80699.91	390.66	FOUND BRASS CAP IN CONCRETE, FLUSH, CENTERLINE MONUMENT
118	1302683.16	80663.80	389.09	FOUND BRASS CAP IN CONCRETE, FLUSH, CENTERLINE MONUMENT
119	1307590.03	80520.03	420.95	SET 1/2" X 10" IRON PIN
120	1308428.25	80496.41	444.62	SET 1/2" X 10" IRON PIN
121	1309215.30	80456.78	531.68	SET 1/2" X 10" IRON PIN
122	1303520.41	79835.90	394.79	FOUND 2-1/2" BRASS CAP IN MONUMENT CASE, 1/4 SECTION CORNER, 12&13, T37S, R2W
123	1304328.97	79818.90	396.46	FOUND BRASS CAP IN MONUMENT CASE, SECTION CORNER 7, 12, 13, 18, T37S, R1&2W
124	1305157.88	79790.84	403.81	FOUND BRASS CAP, 1/4 SECTION CORNER, 7&18 T37S, R1W
125	1305966.00	79766.33	412.19	FOUND BRASS CAP IN MONUMENT CASE, SECTION CORNER 7, 8, 17, 18, T37S, R1W
126	1306773.88	79751.35	415.70	SET NAIL WITH SHINER
127	1307582.14	79727.48	425.52	SET NAIL WITH SHINER
128	1308369.60	79701.36	450.06	SET NAIL WITH SHINER
134	1301087.01	78982.68	401.30	SET 1/2" X 10" IRON PIN
135	1301857.25	79001.44	401.71	SET NAIL WITH SHINER
136	1302690.19	79044.50	400.27	FOUND BRASS CAP IN MONUMENT CASE, 1/4 SECTION CORNER, 13&14, T37S, R2W

OREGON STATE PLANE NAD 83(91) SOUTH ZONE

15965

POINT NUMBER	EASTING METERS	NORTHING METERS	CITY ELEV. METERS	DESCRIPTION
137	1309980.26	78764.09	630.89	SET 1/2" X 10" IRON PIN
138	1310787.06	78802.95	807.75	FOUND 2-1/2" BRASS CAP, 1/4 SECTION CORNER 14&15, T37S, R1W
140	1303490.63	78254.15	406.10	FOUND PK NAIL
141	1304298.62	78246.66	402.96	SET NAIL WITH SHINER
142	1305111.41	78184.03	405.80	FOUND BRASS CAP IN MONUMENT CASE, CENTERLINE MONUMENT
143	1305934.37	78097.43	414.98	SET NAIL WITH SHINER
144	1306730.37	78129.03	430.67	FOUND BRASS CAP IN MONUMENT CASE, 1/4 SECTION CORNER 17&20, T37S, R1W
145	1307595.15	78106.59	439.14	SET NAIL WITH SHINER
146	1308321.01	78070.14	472.64	SET NAIL WITH SHINER
147	1309152.41	78044.75	520.10	SET 1/2" X 10" IRON PIN
148	1309933.41	78032.27	697.37	SET 1/2" X 10" IRON PIN
150	1311571.69	77966.72	767.47	FOUND BRASS CAP, 1/4 SECTION CORNER 14&23, T37S, R1W
151	1312381.82	77948.47	918.83	FOUND BRASS CAP, SECTION CORNER 13, 14, 23, 24, T37S, R1W
152	1301029.87	77752.84	410.46	SET MAG NAIL & SHINER
153	1301890.75	77456.19	411.80	SET 1/2" X 10" IRON PIN
154	1302317.04	77705.70	410.06	SET MAG NAIL WITH SHINER
155	1303312.86	77077.22	414.26	SET MAG NAIL WITH SHINER
156	1304328.46	77090.80	409.97	SET NAIL WITH SHINER
158	1305085.87	76564.52	413.24	SET PK NAIL WITH SHINER
159	1305882.20	76539.47	425.07	FOUND BRASS CAP IN MONUMENT CASE, SECTION CORNER 19, 20, 29, 30, T37S, R1W
160	1306687.82	76514.27	458.46	FOUND BRASS CAP IN MONUMENT CASE, 1/4 SECTION CORNER, 20&29, T37S, R1W
161	1307521.09	76494.44	493.21	SET MAG NAIL WITH SHINER
162	1308306.57	76460.08	486.73	SET MAG NAIL WITH SHINER
163	1309111.52	76420.18	486.26	FOUND NAIL
164	1309870.18	76418.45	539.27	FOUND BRASS CAP IN CONCRETE, FLUSH, CENTERLINE MONUMENT
165	1310727.88	76367.28	641.88	SET 1/2" X 10" IRON PIN
166	1311537.00	76316.83	635.84	SET 1/2" X 10" IRON PIN
167	1312310.24	76341.81	661.73	SET NAIL WITH SHINER
168	1300972.23	75667.40	428.44	SET NAIL WITH SHINER
169	1301767.09	75828.14	428.32	SET NAIL WITH SHINER
170	1302601.16	75812.87	427.46	FOUND BRASS CAP, 1/4 SECTION CORNER 25&26, T37S, R2W
173	1303390.62	74990.44	432.75	FOUND BRASS CAP, 1/4 SECTION CORNER 25&36, T37S, R1W
174	1304989.19	74949.51	423.77	FOUND BRASS CAP IN MONUMENT CASE, CENTERLINE MONUMENT
175	1305842.62	74923.29	425.72	SET NAIL WITH SHINER
176	1306651.50	74874.98	427.84	SET NAIL WITH SHINER

OREGON STATE PLANE NAD 83(91) SOUTH ZONE

15965

POINT NUMBER	EASTING METERS	NORTHING METERS	CITY ELEV. METERS	DESCRIPTION
177	1307474.63	74871.56	442.95	FOUND BRASS CAP IN CONCRETE, FLUSH, CENTERLINE MONUMENT
178	1308274.52	74846.84	456.11	SET 1/2" X 10" IRON PIN
179	1309067.37	74818.34	469.21	SET NAIL WITH SHINER
181	1310683.60	74768.96	519.82	FOUND BRASS CAP, SECTION CORNER 26, 27, 34, 35, T37S, R1W
182	1311470.50	74758.94	563.17	SET 1/2" X 10" IRON PIN
183	1312297.89	74719.39	652.31	FOUND BRASS CAP, SECTION CORNER 25, 26, 35, 36, T37S, R1W
184	1300946.03	74210.65	447.19	SET NAIL WITH SHINER
185	1301721.94	74206.09	447.68	SET 1/2" X 10" IRON PIN
186	1304192.54	74557.98	431.00	SET NAIL WITH SHINER
187	1302487.97	73305.62	456.70	SET NAIL WITH SHINER
188	1303375.03	73336.08	447.02	FOUND 5/8" IRON PIN
189	1304144.17	73257.77	443.17	SET NAIL WITH SHINER
190	1304972.82	73333.92	445.77	SET 1/2" X 10" IRON PIN
191	1305808.45	73301.71	434.13	SET 1/2" X 10" IRON PIN
192	1306543.54	73299.71	430.31	SET NAIL WITH SHINER
193	1307381.77	73251.36	472.00	SET 1/2" X 18" IRON PIN
194	1308219.66	73230.31	449.00	FOUND 2-1/2" BRASS CAP, 1/4 SECTION CORNER 33&4, T37&38S, R1W
195	1309010.89	73193.45	462.54	SET 1/2" X 10" IRON PIN
196	1309819.82	73175.76	474.25	SET 1/2" X 10" IRON PIN
197	1310633.86	73168.67	512.91	FOUND BRASS CAP, SECTION CORNER 2, 3, 34, 35, T37&38S, R1W
198	1311463.22	73133.79	569.38	SET 1/2" X 10" IRON PIN
199	1300888.12	72585.29	485.46	SET 1/2" X 12" IRON PIN
200	1301705.84	72691.14	471.62	SET 1/2" X 12" IRON PIN
201	1304910.56	72527.00	445.18	SET 1/2" X 12" IRON PIN
203	1302485.71	71784.87	550.52	SET 1/2" X 12" IRON PIN
204	1303300.63	71802.25	512.95	SET 1/2" X 12" IRON PIN
205	1304101.41	71751.06	492.20	SET 1/2" X 18" IRON PIN
206	1305749.92	71724.49	451.94	SET 1/2" X 12" IRON PIN
207	1306587.32	71667.38	463.72	SET MAG NAIL WITH SHINER
208	1307357.50	71651.32	447.39	SET 1/2" X 12" IRON PIN
209	1308202.81	71597.08	441.21	FOUND PAVEMENT NAIL
212	1303366.83	74991.12	432.81	SET NAIL WITH SHINER