

15962

**SURVEY FOR:**

LORENE R. HALE  
2075 SO. PACIFIC HWY.  
MEDFORD, OR. 97501

**BY:**

BOYDEN SURVEYORS  
108 MISTLETOE ST.  
MEDFORD, OR. 97501

**LOCATED IN:**

THE S.E. 1/4 OF SEC. 7, T.37 S., R.1W., W.M.  
CITY OF MEDFORD  
JACKSON COUNTY, OR.

**LEGEND**

- - SET 5/8" x 24" REBAR WITH ALUM. CAP STAMPED "BOYDEN PLS 281"
  - - FD. MONUMENT AS INDICATED
  - ⊙ - FD. 2 1/2" BR. DISK RE: F.S. 13835
- FS.- COUNTY FILED SURVEY NO.

**DATE:**

NOVEMBER 18, 1998

REGISTERED  
PROFESSIONAL  
LAND SURVEYOR

*Mark E. Boyden*  
MARK E. BOYDEN  
Exp. RES: 12/31/99.

1/4 COR. SECS. 7 & 18  
NOT VISITED THIS  
SURVEY

37 1W 7D TL 400

NOTE: FD. RED CAP STAMPED  
"HARDEY ENG. & ASSOC."  
BEARS: N 89°18'42"W 0.07'

PARCEL 3 F.S. 15219

NOTE: FD. RED CAP STAMPED  
"HARDEY ENG. & ASSOC."  
(S.E. COR. PARCEL 3)  
BEARS: S 61°E 0.33'

BOUNDARY LINE AGREEMENT INS. NO. 84-17187 OR.  
BASIS OF BEARINGS = N 0°02'31"W F.S. 10079 & F.S. 15219

N 0°02'31" W 638.51' MEAS.  
INS. NO. 66-10213 = NORTH, 638.35'  
= N 0°01'02" W 638.43' MEAS.

S 89°18'42" E 762.10'

FD. 1/2" REBAR RE: F.S. 1977 & 10079

6.52'

LORENE R. HALE  
INS. NO. 66-10213  
F.S. 1977

NEW NET AREA = 11.21 Ac.±

INS. NO. 66-10213 = SOUTH, 579.05'  
S 0°01'02" E 579.13'

SCALE: 1" = 100'

FD. 1/2" REBAR  
BENT

S 0°01'02" E 50.00'

N 89°58'58" E 108.37'

FD. 5/8" IRON PIN  
S.W. COR. F.S. 1977

S 89°58'58" W 870.13'

9.38'

6.24'

FD. YELLOW CAP  
"JACKSON CS"  
RE: F.S. 10079

N 0°02'31" W  
686.09'

RE: F.S. 10079

F.S. 1516

\*\*\* RECEIVED \*\*\*

Date 11-23-98 By MB

This survey consists of:

1 sheet(s) Map

1 page(s) Narrative

JACKSON COUNTY  
SURVEYOR

FD. 2 1/2" BR. DISK IN  
CONCRETE TRAFFIC ISLAND  
RE: F.S. 13835

DELTA WATERS ROAD  
N 0°00'27" W F.S. 13835  
N 0°01'02" W MEAS.

15962

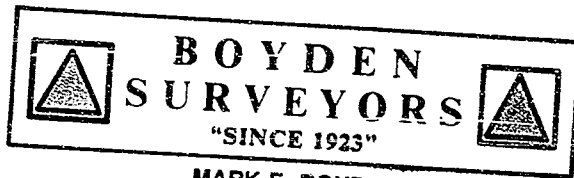

MARK E. BOYDEN  
R.P.L.S. ORE. 281  
108 MISTLETOE ST., MEDFORD, OREGON 97501  
PHONE (503) 773-6000

SURVEY NO. **15962**

SURVEY NARRATIVE TO COMPLY WITH O.R.S. 209.250

SURVEY FOR: LORENE R. HALE  
2075 SOUTH PACIFIC HIGHWAY  
MEDFORD, OR 97501

SURVEY BY: BOYDEN SURVEYORS  
108 MISTLETOE STREET  
MEDFORD, OR 97501

LOCATION: SE 1/4, SECTION 7, T. 37 S., R. 1 W., W.M.  
CITY OF MEDFORD, JACKSON COUNTY, OREGON

BASIS OF BEARINGS: West line of Filed Survey No. 15219 and the new  
monumented boundary Re: Filed Survey No. 10079.

DATE: NOVEMBER 18, 1998

PURPOSE: To monument the current boundaries of the Hale  
ownership described in Instrument No. 66-10213 and the additional property obtained in  
that boundary agreement described in Instrument No. 84-17187, less that portion in  
present Delta Waters Road conveyed to the City of Medford by Instrument No. 93-21178

PROCEDURE: Utilizing E.D.M. equipment, enclosed the subject property,  
tying to monuments found as shown.

To better re-trace the original survey FS. 1977, it was decided to use record angles and  
the small "North-South" overplus as shown.

Monuments found on F.S. 15219 differed slightly from said procedure as shown.  
Control for Delta Waters Road was established from the centerline monument found set  
on F.S. 13835 and the difference in basis of bearings between said survey and F.S.10079.

**\*\* RECEIVED \*\***  
Date 11-23-98 By [Signature]  
This survey consists of:  
1 sheet(s) Map  
1 page(s) Narrative  
JACKSON COUNTY  
SURVEYOR

REGISTERED  
PROFESSIONAL  
LAND SURVEYOR

[Signature]  
OREGON  
NOV 23 1998  
MARK E. BOYDEN  
281  
Exp 12/31/99.