

15804

SURVEY MAP

FOR: EURO-DRAWER INC. BY: BOYDEN SURVEYORS
P.O. BOX 849 108 MISTLETOE ST.
MOCKSVILLE, N.C. 27028 MEDFORD, OR. 97501

LOCATED IN THE S.W. 1/4 SEC. 17, T. 36 S., R. 1W., W.M.
JACKSON COUNTY, OR.

SCALE: 1" = 100'

** RECEIVED **

JULY 1, 1998

Date 7-9-98 By *[Signature]*

This survey Consists of:

- 1 sheet(s) Map
- 1 page(s) Narrative

JACKSON COUNTY SURVEYOR

R = 36.00'
L = 44.87'
LC = S54°29'30"W
42.02'

S89°48'E
AVE. 'G' F.S. 4306
684.43'

N89°48'W
132.91'

S70°03'20"E
30.00'

1.82 ACRES ±

N18°25'40"E
90.07'

N 0°17'40" W 1478.35' (F.S. 4306)
ROAD

S15°47'W 493.80' (REC.)
S18°47'W 305.31' MEAS. 308.20' (DEED)
F.S. 6192 & 1843

INS. NO. 98-17857 O.R.

N 20°06'40"E 480.30' (REC.)
N 20°07'30"E 480.33' MEAS.
(NOW PARTIALLY DISMANTLED) SPUR
TRACT "B" - INS. NO. 77-06099 O.R.

F.S. 14419

S 71°13' E 139.81' MEAS.
139.93' (REC.)

LEGEND

- - FD. 3/4" IRON PIN
- ⊗ - FD. YELLOW CAP STAMPED "KAISER PLS 803" F.S. 14419
- ⊙ - FD. BRASS DISC IN CONCRETE 3" DEEP
- - SET 5/8"x24" REBAR W/ ALUM. CAP STAMPED "BOYDEN PLS 281"
- F.S. - FILED COUNTY SURVEY
- BASIS OF BEARINGS = G AVE. 'G' F.S. 4306

18/17
19/20

SEC. COR. NOT
TIED THIS SURVEY

REGISTERED
PROFESSIONAL
LAND SURVEYOR

[Signature]
OREGON
NOV. 8, 1995
MARK E. BOYDEN
281
EXPIRES: 12/31/99.

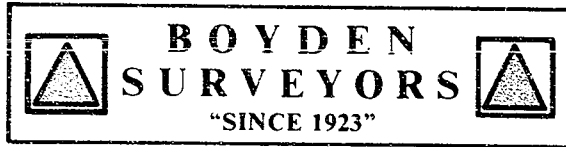

MARK E. BOYDEN
R.P.L.S. ORE. 281
108 MISTLETOE ST., MEDFORD, OREGON 97501
PHONE (503) 773-6000

SURVEY NO. 15804

SURVEY NARRATIVE TO COMPLY WITH O.R.S. 209.250

SURVEY FOR: EURO-DRAWER, INC.
P. O. BOX 849
MOCKSVILLE, NC 27028

SURVEY BY: BOYDEN SURVEYORS
108 MISTLETOE STREET
MEDFORD, OR 97501

LOCATION: SW ¼, Section 17, Township 36 South, Range 1 West,
W.M., Jackson County, OR

BASIS OF BEARINGS: Centerline Avenue 'G', Re: County Filed Survey No. 4306

DATE: June 25, 1998

PURPOSE: To locate and remonument the missing property corners of
tract described in Instrument No. 98-17857, O.R.

PROCEDURE: Utilizing E.D.M. equipment, traversed around the subject
premises, tying the previously set monuments as shown.
Computed the boundaries, and set monuments for those corners not found.

