

MAP OF SURVEY  
FOR  
SCOTT BRILL  
N.W. 1/4 OF S.E. 1/4, SECTION 35, T. 33 S. R. 1 W. W.M.  
SOLAR DATUM

DATE: 9-3-60

SCALE: 1" = 200'

REGISTERED  
OREGON  
LAND SURVEYOR

*L. E. Ager*

MARCH 16, 1944  
L. E. AGER  
21

C 1/4 COR. SEC.

C E 1/16 COR.

1045.46'

IP. 88° 51' E. 277.34' IP.

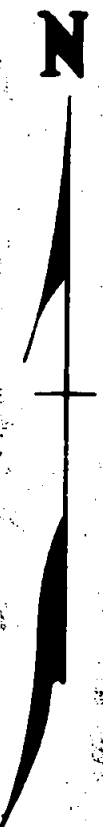
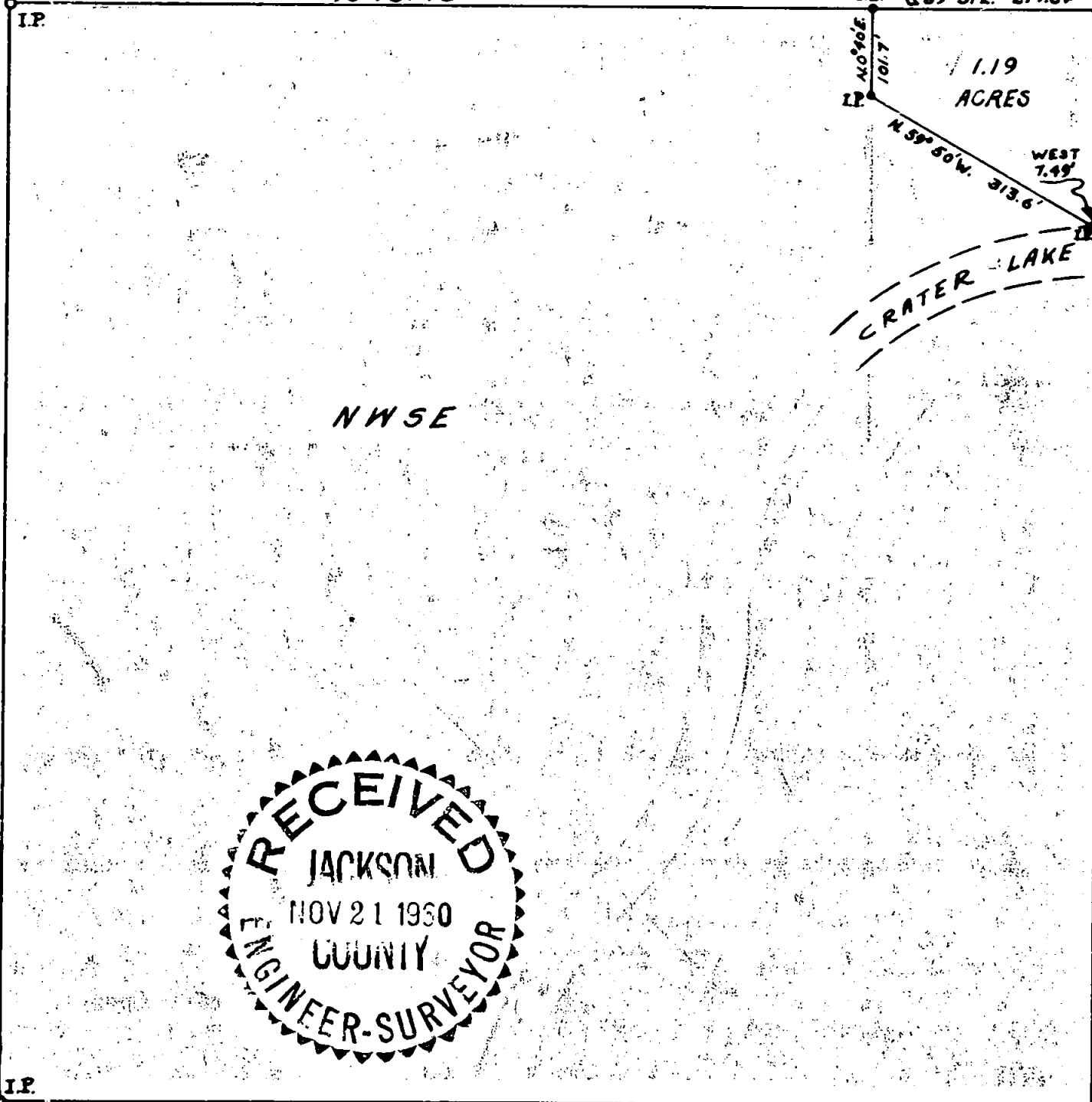

N. 0° 11' E. 1325.2'

1.19  
ACRES  
WEST  
7.49'  
N. 59° 50' W. 313.6'  
S. 80° 07' W. 259.34'

CRATER LAKE  
HIGHWAY

RECEIVED  
JACKSON  
NOV 21 1960  
COUNTY  
ENGINEER-SURVEYOR

C S 1/16  
COR.

Survey narrative to comply with Section 87-330, Oregon State Law of 1947

For: Scott Brill

Purpose: To establish the boundaries of tract shown on accompanying map.

Procedure: Began survey on the north line of the NW $\frac{1}{4}$  of the SE $\frac{1}{4}$  of the Section from corners previously established by a survey made in 1952 and surveyed the tract shown on the accompanying map according to the bearings and distances thereon.

REGISTERED  
OREGON  
LAND SURVEYOR

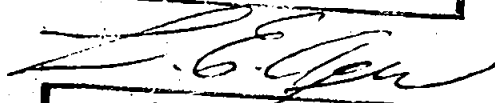

MARCH 10, 1944  
L. E. AGER  
21

RECEIVED  
JACKSON  
NOV 21 1960  
COUNTY  
ENGINEER-SURVEYOR