

15486

SURVEY FOR:

A. Peter Holm
1225 Netherlands Road
Trail, Oregon 97541

SURVEY BY:

Kaiser Surveying
19440 Highway 62
Eagle Point, Oregon 97524

LOCATION:

N.W. 1/4 of Section 11,
T.34S., R.1E., W.M.,
Jackson County, Oregon

DATE:

August 25, 1997

LEGEND

() = Record Per Filed
Survey No. 13123

Basis of Bearings
Filed Survey No. 13755
(Traverse Lines)



SCALE: 1" = 300'

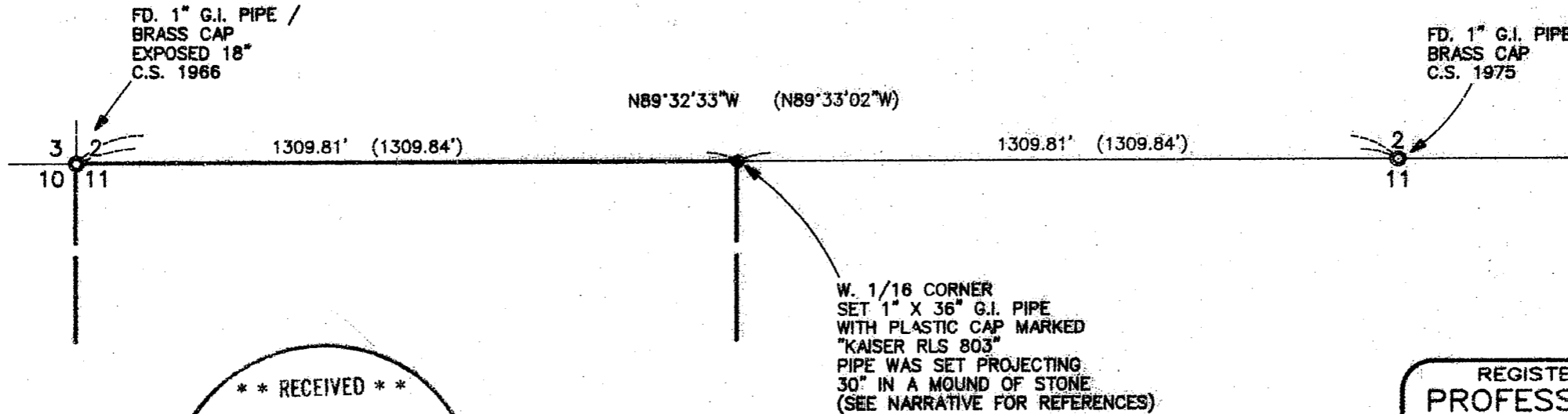

**** RECEIVED ****
 Date 8-25-97 By [Signature]
 This survey Consists of:
1 sheet(s) Map
1 page(s) Narrative
 JACKSON COUNTY
 SURVEYOR

REGISTERED
**PROFESSIONAL
 LAND SURVEYOR**
G.D.K.
 OREGON
 JULY 16, 1987
 GARY D. KAISER
 No. 803
 EXP. 6-30-99

T.L. No. 341E 11 - 100

15486

GARY D. KAISER
R.P.L.S. ORE. 803
C.W.R.E. ORE. 73

KAISER SURVEYING
19440 HIGHWAY 62
EAGLE POINT, OREGON 97524

PHONE
SHADY COVE (541) 878-3995
FAX (541) 878-3995

SURVEY NO. 15486

SURVEY NARRATIVE TO COMPLY WITH O.R.S. 209.250

SURVEY FOR: A. PETER HOLM
1225 NETHERLANDS ROAD
TRAIL, OR 97541

SURVEY BY: KAISER SURVEYING
19440 HWY. 62
EAGLE POINT, OR 97524

LOCATION: NW ¼ of Section 11, T.34S., R.1E.,
W.M., Jackson County, Oregon

BASIS OF BEARINGS: Filed Survey No. 13755 (Traverse
Point)

DATE: August 25, 1997

PURPOSE: Monument the NE corner of the NW ¼
NW ¼ of Section 11, T.34S., R.1E.,
W.M.

PROCEDURE: Utilizing E.D.M. Equipment, set West
1/16 corner on North boundary of Section 11 from which:
A 6" white oak scribed "W 1/16 - BT" bears S. 63° 14'
W., 59.99 feet.
A 4" white oak scribed "W 1/16 - BT" bears N. 44° 31'
W., 86.2 feet.
The corner falls approximately 225' East from McNeil
Creek Road.

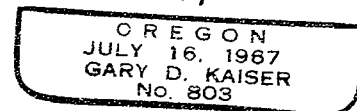
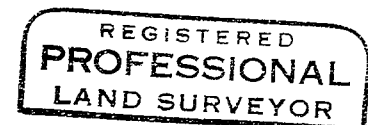
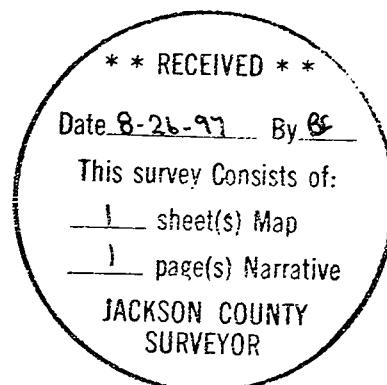

Exp 6-30-99