

15475

PROPERTY LINE ADJUSTMENT  
Map of Survey

Located in the northwest quarter of Section 2, Township 39  
South, Range 1 East of the Willamette Meridian, Jackson  
County, Oregon.  
for

William J. Craven

P.O. Box 596  
Ashland, Oregon 97502



Legend:

Basis of Bearing is NAD-83 True North based on Global  
Positioning Satellite observations.

S/N is survey file number at the Jackson County Surveyor's  
Office, Oregon.  
Inst. No. is Instrument Number of the Official records of  
Jackson County, Oregon.

- ( ) indicates record data per S/N 8466 or as indicated.
- found 1 inch iron pipe monument with 2 1/2 inch brass cap per  
S/N 5301.
- found 3/4 inch iron pipe monument with crimped top per S/N  
1700.
- ∅ found 5/8 inch iron pin monument with plastic cap marked  
"PIERSON LS 1650 per S/N 8466.
- set 5/8 by 30 inch iron pin monument with yellow plastic cap  
marked "FARBER PLS 2189".

NW COR DLC No 44 FOUND PIPE & BRASS CAP  
PER JACKSON COUNTY SURVEYOR RE-ESTAB.

SURVEY NARRATIVE  
TO COMPLY WITH O.R.S. 209.250

Surveyed by:

Farber & Sons, Inc.  
Farber Surveying  
120 Mistletoe Street  
Medford, Oregon 97504

REGISTERED  
PROFESSIONAL  
LAND SURVEYOR

*Herbert A. Farber*

OREGON  
JULY 26, 1985  
HERBERT A. FARBER  
2189

RENEWAL DATE 12-31-97

Purpose: To survey and monument that property line  
adjustment as approved by the Jackson County  
Department of Planning and Development. File  
No. 96-664-PA

Procedure: Utilizing Trimble Global Positioning Satellite  
observations, I tie the monuments as shown. I  
set the property corners per deed record as  
shown.

Approved by the Jackson County Department of Planning and  
Development. File No. 96-664-PA

By: *Louise Marie Hunt*

\*\* RECEIVED \*\*

Date 8-15-97 By *BF*

This survey Consists of:

1 sheet(s) Map

0 page(s) Narrative

JACKSON COUNTY  
SURVEYOR

Detail:  
no scale

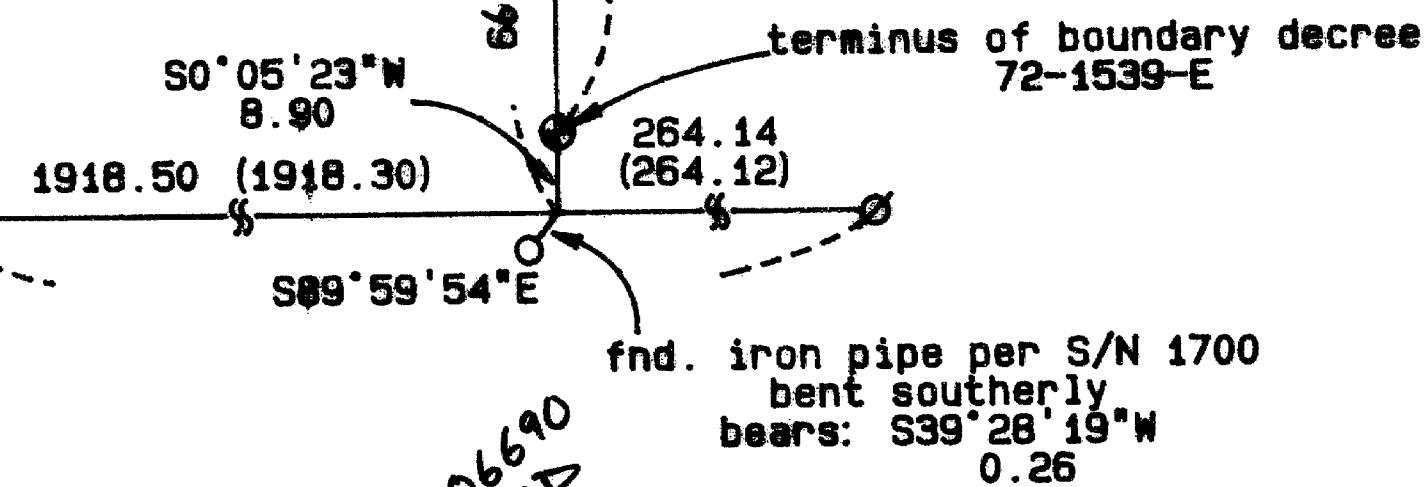

INST. NO. 97-06690  
NOT SURVEYED

