

OREGON DEPARTMENT OF TRANSPORTATION
PHOTOGRAMMETRY UNIT
Room 26, Transportation Building
355 Capitol St. NE
Salem, Oregon 97310-3154
Phone: 986-3539 Fax: 986-3131

5237

HORIZONTAL CONTROL DATA SHEET

DATE SET: 10/26/95 STATE: OR

STATION NAME: WILD 1994
SECTION: 31 TOWNSHIP: 38S RANGE: 1E
1/4 SECTION: NE COUNTY: JACKSON

GROUP: C ORDER: 1
PPM: 10

GPS: YES TYPE: STATIC

GEODETIC DATUM: NAD 83/91
LAT.: N 42°13'37.63079"
LONG.: W 122°44'25.36360"

SPCS DATUM: OREGON SOUTH
NORTHING: 64732.311 meters
EASTING: 1315061.223 meters

VERTICAL DATUM: NGVD 29/47
ELIPSOID ELEV: meters
ORTHOMETRIC ELEV: 535.3727 meters
SEPARATION: meters

CONVERGENCE: - 1°31'57.9000"
SCALE FACTOR: 1.00002843

STATEMENT PER ORS 209.250(6) (g)

This survey was completed in October, 1995 for the "Pacific Hwy - OR 99" project. Project was completed using three ASHTEK Z-XII dual frequency GPS receivers. Oregon HPGN control stations, "ASH, JUSTICE and CA 02 02" were the basis for processing this data. Data for this project is located in Control File 94-030 in the Photogrammetry Unit, Oregon Department of Transportation in Salem, OR.

DIRECTIONS TO THE MONUMENT: The mark is located in the SE part of the North Ashland I-5 Interchange at MP 19.015, exit #19 (Valley View Rd).

MONUMENT TYPE: Brass disk set in concrete post.

STAMPING: WILD 1994

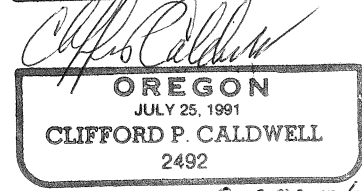
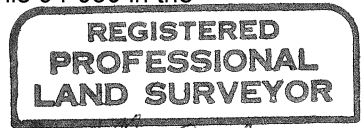

SURVEYOR'S STAMP expires 12/97

DESCRIPTION OF THE MONUMENT: The mark is an ORDOT standard Geodetic Control Disk set in a 12" x 12" concrete post with 5/8" iron rod imbedded; 41 ft north of large sign; 132 ft south of SW corner of freeway O'xing; 23 ft east of edge of Valley View Rd oil; 1.5 ft west of witness post.

For conversion of meters to U.S. Survey Feet multiply the meters by 39.37/12.0 which is 3.28083333333 to 12 significant figures.
For conversion of meters to International Feet multiply the meters by 100.0/30.48 which is 3.28083989501 to 12 significant figures.
Elevation Factor (in the North American Continent) = 1 - (Ellipsoid Elevation in meters / 6,372,000).

**OREGON DEPARTMENT OF TRANSPORTATION
PHOTOGRAMMETRY UNIT**

Room 26, Transportation Building
355 Capitol St. NE
Salem, Oregon 97310-3154
Phone: 986-3539 Fax: 986-3131

HORIZONTAL CONTROL DATA SHEET

DATE SET: 10/26/95 **STATE:** OR

STATION NAME: HAMBY 1994
SECTION: 32 **TOWNSHIP:** 38S **RANGE:** 1E
1/4 SECTION: NE **COUNTY:** JACKSON

GPS: YES **TYPE:** STATIC

GROUP: C **ORDER:** 1
PPM: 10

GEODETIC DATUM: NAD 83/91
LAT.: N 42°13'19.67009"
LONG.: W 122°43'26.42056"

SPCS DATUM: OREGON SOUTH
NORTHING: 64142.291 meters
EASTING: 1316397.753 meters

VERTICAL DATUM: NGVD 29/47
ELIPSOID ELEV: meters
ORTHOMETRIC ELEV: meters
SEPARATION: meters

CONVERGENCE: - 1°31'17.5700"
SCALE FACTOR: 1.00002985

STATEMENT PER ORS 209.250(6) (g)

This survey was completed in October, 1995 for the "Pacific Hwy - OR 99" project. Project was completed using three ASHTEK Z-XII dual frequency GPS receivers. Oregon HPGN control stations, "ASH, JUSTICE and CA 02 02" were the basis for processing this data. Data for this project is located in Control File 94-030 in the Photogrammetry Unit, Oregon Department of Transportation in Salem, OR.

DIRECTIONS TO THE MONUMENT: The mark is located in the north bound Port of Entry along Interstate I-5 at mile post 18.15 in Ashland.

MONUMENT TYPE: Brass disk set in concrete post.

STAMPING: HAMBY 1994

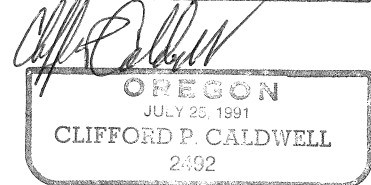

SURVEYOR'S STAMP Expires 12/97

DESCRIPTION OF THE MONUMENT: The mark is an ORDOT standard Geodetic Control Disk set in a 12" X 12" concrete post with 5/8" iron rod imbedded; 325 ft northwest of the scale house at weighmaster site; 47.5 ft southwest of curb; 46.8 ft northeast of edge of paved shoulder; 2 ft from witness post.

For conversion of meters to U.S. Survey Feet multiply the meters by 39.37/12.0 which is 3.28083333333 to 12 significant figures.
For conversion of meters to International Feet multiply the meters by 100.0/30.48 which is 3.28083989501 to 12 significant figures.
Elevation Factor (in the North American Continent) = 1 - (Ellipsoid Elevation in meters / 6,372,000).

**OREGON DEPARTMENT OF TRANSPORTATION
PHOTOGRAMMETRY UNIT**

Room 26, Transportation Building
355 Capitol St. NE
Salem, Oregon 97310-3154
Phone: 986-3539 Fax: 986-3131

HORIZONTAL CONTROL DATA SHEET

DATE SET: 10/26/95 **STATE:** OR

STATION NAME: KDOV 1994
SECTION: 15 **TOWNSHIP:** 39S **RANGE:** 1E
1/4 SECTION: NE **COUNTY:** JACKSON

GPS: YES **TYPE:** STATIC

GROUP: C **ORDER:** 1
PPM: 10

GEODETTIC DATUM: NAD 83/91
LAT.: N 42°10'47.38247"
LONG.: W 122°40'51.04944"

SPCS DATUM: OREGON SOUTH
NORTHING: 59351.215 meters
EASTING: 1319837.540 meters

VERTICAL DATUM: NGVD 29/47
ELIPSOID ELEV: meters
ORTHOMETRIC ELEV: meters
SEPARATION: meters

CONVERGENCE: - 1°29'31.2700"
SCALE FACTOR: 1.00004218

STATEMENT PER ORS 209.250(6) (g)

This survey was completed in October, 1995 for the "Pacific Hwy - OR 99" project. Project was completed using three ASHTEK Z-XII dual frequency GPS receivers. Oregon HPGN control stations, "ASH, JUSTICE and CA 02 02" were the basis for processing this data. Data for this project is located in Control File 94-030 in the Photogrammetry Unit, Oregon Department of Transportation in Salem, OR.

DIRECTIONS TO THE MONUMENT: To reach this mark go southeast from intersection of OR 99 and OR 66 in Ashland, 0.685 miles to mark on southwest side of OR 99.

MONUMENT TYPE: Brass disk set in concrete post.

STAMPING: KDOV 1994

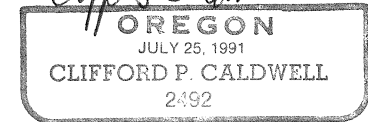

Exp. res 12/97
SURVEYOR'S STAMP

DESCRIPTION OF THE MONUMENT: The mark is an ORDOT standard Geodetic Control Disk set in a 12" X 12" concrete post with 5/8" iron rod imbedded; 156 ft east of Park St; 24 ft south of OR 99; 20.4 ft south of power pole #S5158504; 1.5 ft south of bike path.

For conversion of meters to U.S. Survey Feet multiply the meters by 39.37/12.0 which is 3.28083333333 to 12 significant figures.
For conversion of meters to International Feet multiply the meters by 100.0/30.48 which is 3.28083989501 to 12 significant figures.
Elevation Factor (in the North American Continent) = 1 - (Ellipsoid Elevation in meters / 6,372,000).

**OREGON DEPARTMENT OF TRANSPORTATION
PHOTOGRAMMETRY UNIT**
Room 26, Transportation Building
355 Capitol St. NE
Salem, Oregon 97310-3154
Phone: 986-3539 Fax: 986-3131

HORIZONTAL CONTROL DATA SHEET

DATE SET: 10/26/94 **STATE:** OR

STATION NAME: KITCH 1994
SECTION: 3 **TOWNSHIP:** 39S **RANGE:** 1E
1/4 SECTION: NE **COUNTY:** JACKSON

GPS: YES **TYPE:** STATIC

GROUP: C **ORDER:** 1
PPM: 10

GEODETTIC DATUM: NAD 83/91
LAT.: N 42°12'38.56437"
LONG.: W 122°40'50.78034"

SPCS DATUM: OREGON SOUTH
NORTHING: 62780.509 meters
EASTING: 1319933.037 meters

VERTICAL DATUM: NGVD 29/47
ELIPSOID ELEV: meters
ORTHOMETRIC ELEV: 624.4630 meters
SEPARATION: meters

CONVERGENCE: - 1°29'31.0900"
SCALE FACTOR: 1.00003313

STATEMENT PER ORS 209.250(6) (g)

The survey was completed in October, 1995 for the "Pacific Hwy - OR 99" project. Project was completed using three ASHTEK Z-XII dual frequency GPS receivers. Oregon HPGN control stations, "ASH, JUSTICE and CA 02 02" were the basis for processing this data. Data for this project is located in Control File 94-030 in the Photogrammetry Unit, Oregon Department of Transportation in Salem, OR.

DIRECTIONS TO THE MONUMENT: From the intersection of OR 99 and OR 66, go north on OR 99, 0.457 miles to Mountain Ave, turn right on Mountain Ave and go north 1.57 miles to intersection of Mountain Ave and Nevada St.; turn right on Nevada St and go 0.987 miles to mark on the right.

MONUMENT TYPE: Brass disk set in concret post.

STAMPING: KITCH 1994

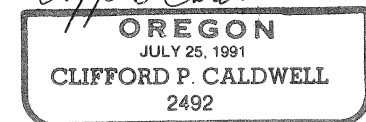
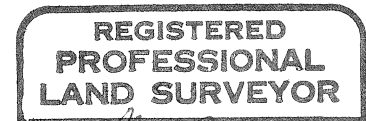

Expires 12/97

SURVEYOR'S STAMP

DESCRIPTION OF THE MONUMENT: The mark is an ORDOT standard Geodetic Control Disk set in a 12" x 12" concrete post with 5/8" iron rod imbedded; 14 ft south of edge of Nevada St oil; 4.3 ft north of fence; 72 ft east of power pole #76.

For conversion of meters to U.S. Survey Feet multiply the meters by 39.37/12.0 which is 3.28083333333 to 12 significant figures.
For conversion of meters to International Feet multiply the meters by 100.0/30.48 which is 3.28083989501 to 12 significant figures.
Elevation Factor (in the North American Continent) = 1 - (Ellipsoid Elevation in meters / 6,372,000).

**OREGON DEPARTMENT OF TRANSPORTATION
PHOTOGRAMMETRY UNIT**
Room 26, Transportation Building
355 Capitol St. NE
Salem, Oregon 97310-3154
Phone: 986-3539 Fax: 986-3131

HORIZONTAL CONTROL DATA SHEET

STATION NAME: BEAR 1993
SECTION: 12 **TOWNSHIP:** 37S **RANGE:** 2W
1/4 SECTION: SE **COUNTY:** JACKSON
DATE SET: 11/17/93 **STATE:** OR

GPS: YES **TYPE:** STATIC
GROUP: C **ORDER:** 1
PPM: 10

GEODETIC DATUM: NAD 83/91
LAT.: N 42°21'41.01909"
LONG.: W 122°52'59.52745"

VERTICAL DATUM: NGVD 29/47
ELIPSOID ELEV: meters
ORTHOMETRIC ELEV: meters
SEPARATION: meters

SPCS DATUM: OREGON SOUTH
NORTHING: 79966.952 meters
EASTING: 1303698.918 meters

CONVERGENCE: - 1°37'49.6600"
SCALE FACTOR: 0.99999305

STATEMENT PER ORS 209.250(6) (g)

This survey was completed in February, 1994 for the "Hwy 238 - Jackson St" project. Project was completed using three ASHTEK MD-XII dual frequency GPS receivers. Oregon HPGN control stations FAIR, JUSTICE and ILLA were the basis for processing this data. Data for this project is located in Control File 93-020 in the Photogrammetry Unit, Oregon Department of Transportation in Salem, OR.

DIRECTIONS TO THE MONUMENT: From the Table Rock overcrossing go south on Interstate 5 about 0.16 mi. to the mark in the median at MP 31.17.

MONUMENT TYPE: Brass disk set in concrete

STAMPING: BEAR 1993

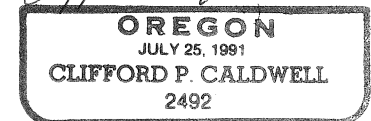
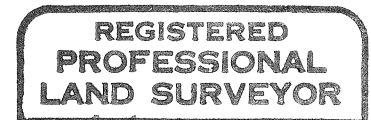

SURVEYOR'S STAMP
EXPIRES 12/97

DESCRIPTION OF THE MONUMENT: Mark is an ORDOT Geodetic Control Disk set in concrete, 23.5 ft. west of northbound lanes and 46 ft. east of southbound lanes.

For conversion of meters to U.S. Survey Feet multiply the meters by 39.37/12.0 which is 3.28083333333 to 12 significant figures.
For conversion of meters to International Feet multiply the meters by 100.0/30.48 which is 3.28083989501 to 12 significant figures.
Elevation Factor (in the North American Continent) = 1 - (Ellipsoid Elevation in meters / 6,372,000).

**OREGON DEPARTMENT OF TRANSPORTATION
PHOTOGRAMMETRY UNIT**
Room 26, Transportation Building
355 Capitol St. NE
Salem, Oregon 97310-3154
Phone: 986-3539 Fax: 986-3131

HORIZONTAL CONTROL DATA SHEET

STATION NAME: JH20 1993
SECTION: 13 **TOWNSHIP:** 37S **RANGE:** 2W
1/4 SECTION: NE **COUNTY:** JACKSON
DATE SET: 11/18/93 **STATE:** OR

GPS: YES **TYPE:** STATIC
GROUP: C **ORDER:** 1
PPM: 10

GEODETTIC DATUM: NAD 83/91
LAT.: N 42°21'16.96568"
LONG.: W 122°52'39.50189"

VERTICAL DATUM: NGVD 29/47
ELIPSOID ELEV: meters
ORTHOMETRIC ELEV: meters
SEPARATION: meters

SPCS DATUM: OREGON SOUTH
NORTHING: 79212.049 meters
EASTING: 1304135.916 meters

CONVERGENCE: - 1°37'35.9600"
SCALE FACTOR: 0.99999468

STATEMENT PER ORS 209.250(6) (g)

This survey was completed in February, 1994 for the "Hwy 238 - Jackson St" project. Project was completed using three ASHTEK MD-XII dual frequency GPS receivers. Oregon HPGN control stations FAIR, JUSTICE and ILLA were the basis for processing this data. Data for this project is located in Control File 93-020 in the Photogrammetry Unit, Oregon Department of Transportation in Salem, OR.

DIRECTIONS TO THE MONUMENT: Mark is in Medford on the Medco Haul Rd. overcrossing of Interstate 5 at MP 30.64 (of I-5)

MONUMENT TYPE: Brass disk set in concrete guardrail

STAMPING: JH20 1993

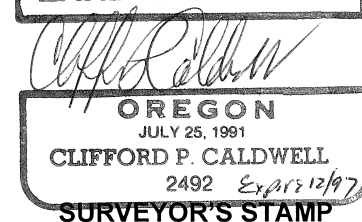
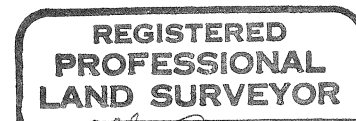

DESCRIPTION OF THE MONUMENT: Mark is an ORDOT Geodetic Control Disk set in concrete guardrail, in the NE corner of the structure.

For conversion of meters to U.S. Survey Feet multiply the meters by 39.37/12.0 which is 3.2808333333 to 12 significant figures.
For conversion of meters to International Feet multiply the meters by 100.0/30.48 which is 3.28083989501 to 12 significant figures.
Elevation Factor (in the North American Continent) = 1 - (Ellipsoid Elevation in meters / 6,372,000).