

MAP OF SURVEY

In the S.W. 1/4 of Sec. 17, T.35 S.,
R.1 W., W.M. Jackson County, Oregon.

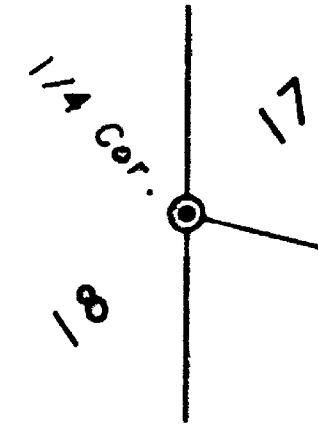

576°12'52"E
999.68

(N65°00'00"E
N65°00'29"E
326.94)
326.66

SURVEY FOR:

Edward Carson
1996 Highway 234
Eagle Point, OR 97524

SURVEY BY:

L.J. Friar & Associates, P.C.
Consulting Land Surveyors
304 South Holly Street
Medford, Oregon 97501
Phone: (541) 772-2782

LEGEND:

- ⊙ - Found County Surveyor's brass capped monument & accessories.
- - Found 5/8" iron pin per RS2881.
- - Found OSHD 3/4" iron pin. CL - Centerline.
- - Set 5/8" x 24" iron pin w/ plastic cap mkd. L.J.FRIAR & ASSOC.
- () - Record data per deed & RS2881.

BASIS OF BEARINGS: Survey No. 2881 as shown hereon.

DATE: January 6, 1996 **UNIT OF MEASUREMENT:** Feet **SCALE:** 1" = 100'

Doc. 95-37514. ORJCO.

(N24°32'37"W
N24°33'10"W
736.02)

(S29°35'30"E
S29°35'22"E
719.70)

In CL Driveway

Sp. Ch. - N63°49'49"E 52.04

N23°39'31"W 20.02

In CL Driveway

20.00 (20.00)
5.49 (5.72)

Sp. Ch. S62°10'11"W
(S62°06'10"W
281.65
281.71)
234

P.O.S. 715-00

STATE HIGHWAY

P.S. 711-08-52

857.49
S61°26'50"W
Beals of Bearings
877.49 (877.41)

Pin appears to have been moved from map position. Fence corner post at record position.

**** RECEIVED ****
Date 8-29-96 By [Signature]
This survey consists of:
- [] Survey Map
- [] Record Narrative
- [] [] COUNTY SURVEYOR

REGISTERED PROFESSIONAL LAND SURVEYOR
James E. Hibbs
OREGON
JULY 17, 1988
JAMES E. HIBBS
2234
Renewal Date 6-30-97

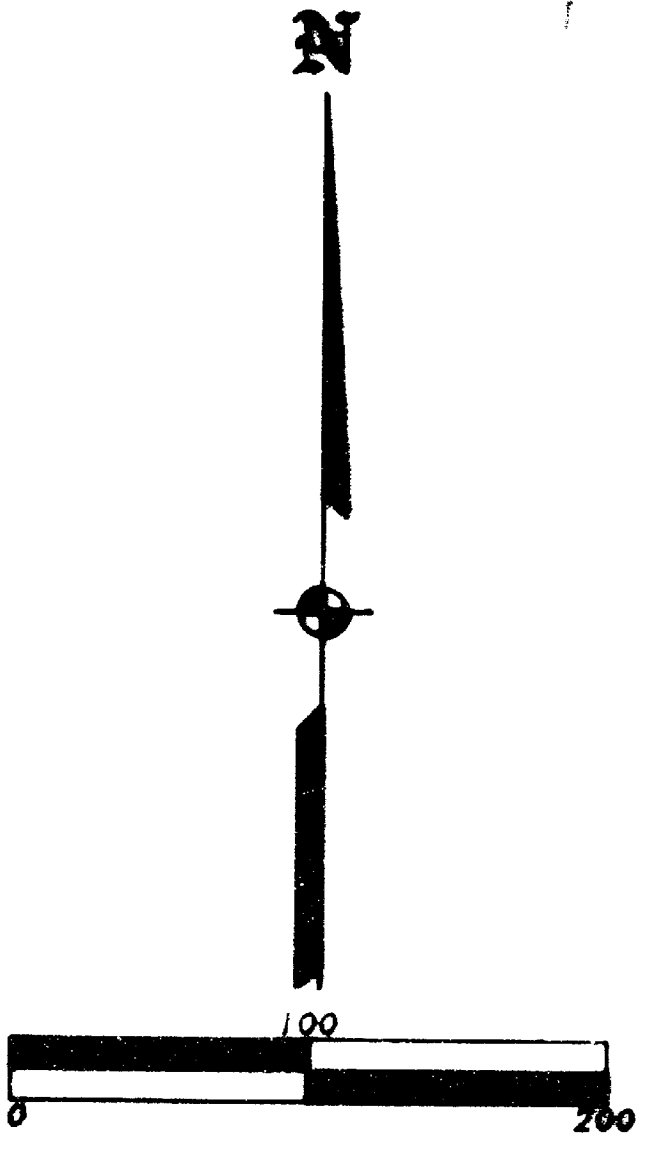

SURVEY NARRATIVE TO COMPLY WITH O.R.S. 209.250

PURPOSE: To survey and monument the client's tract of land.

PROCEDURE: Tied to pins set or found by RS2881. Calculated the position of the Southwesterly corner of the subject tract at map & deed record distance from the found R/W pin. Those monuments found as well as those set are as shown hereon.