

MAP OF SURVEY
 LOCATED IN
 JOHN R. CREWS SUBDIVISION
 SOUTHEAST 1/4 OF SECTION 13,
 TOWNSHIP 37 SOUTH, RANGE 2 WEST, WILLAMETTE MERIDIAN,
 JACKSON COUNTY, OREGON

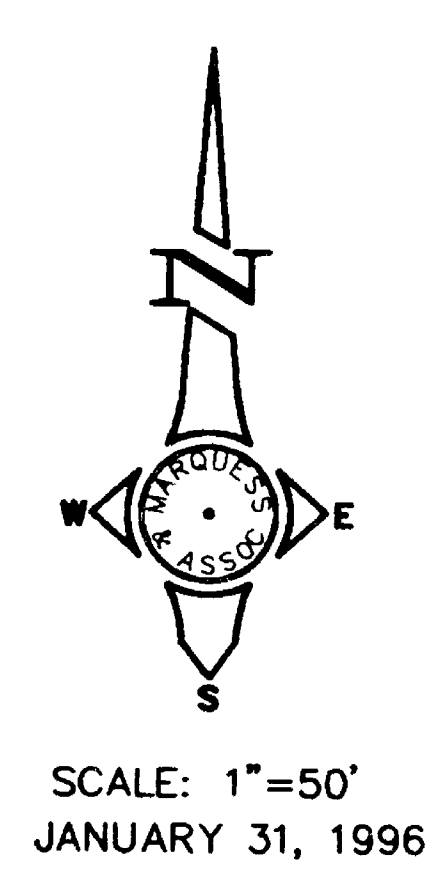

- LEGEND**
- FOUND MONUMENT AS NOTED
 - SET 5/8" x 30" IP WITH PLASTIC CAP MARKED "MARQUESS & ASSOC."
 - ⊕ FOUND BRASS CAPPED MONUMENT
 - RS RECORDED SURVEY, JACKSON COUNTY, OREGON
 - (R=) RECORD BEARING AND/OR DISTANCE FROM RS 7655
 - (PR=) RECORD BEARING AND/OR DISTANCE FROM PLAT OF JOHN R. CREWS SUBDIVISION
 - IP IRON PIN
 - FD FOUND
 - DLC DONATION LAND CLAIM
 - OR OFFICIAL RECORDS, JACKSON COUNTY, OREGON

SURVEY FOR:
 MEL SHERBOURNE
 3237 CARRIAGE DR.
 MEDFORD, OREGON 97501

SURVEYOR:
 MARQUESS AND ASSOCIATES INC.
 1120 EAST JACKSON STREET
 MEDFORD, OREGON 97504
 TELE: 772-7115
 MAI JOB NO. \1-5854\PLAT.DWG

BASIS OF BEARINGS:
 THE WEST LINE OF DONATION LAND CLAIM NO. 61,
 AS SHOWN ON RS 7655, RS 13842.

1-31-96

REGISTERED PROFESSIONAL LAND SURVEYOR

Stuart M. Osmus

STUART M. OSMUS

SURVEY NO. 14835

SURVEY NARRATIVE TO COMPLY WITH CHAPTER 209
OREGON REVISED STATUTES

SURVEY FOR: Mel Sherbourne
3237 Carriage Drive
Medford, Oregon 97501

LOCATION: John R. Crews Subdivision in the Southeast 1/4 of Section 13, Township
37 South, Range 2 West, Willamette Meridian, Jackson County, Oregon.

PURPOSE: To survey and monument the corners of the client's property.

EQUIPMENT: Lietz Set 4 Total Station

PROCEDURE: Two original monuments were found from the John R. Crews Subdivision;
the 2" iron pipe shown along the west line of D.L.C. No. 61, and the 1"
iron pin at the northwesterly corner of Lot 11, Block 3. The 2" iron pipe
was shown as disturbed on Filed Survey No. 13842 and its position
relative to the aforementioned D.L.C. line would indicate that it was
moved slightly during fence construction. Therefore, much of the
boundary of the client's property was based upon the location of the 1"
iron pin, the D.L.C. corners, found monuments from Filed Survey No.
7655, and record bearings and distances from Filed Survey No. 7655 and
the plat of the John R. Crews Subdivision. Two monuments were found
from Filed Survey No. 13842. Both appear to have been moved during
fence construction and did not fit the other monuments found.

BASIS OF BEARING: The west line of Donation Land Claim No. 61, as shown on Filed Survey
No. 7655 and Filed Survey No. 13842.

DATE: January 31, 1996

MARQUESS & ASSOCIATES, INC.
1120 East Jackson Street
P. O. Box 490
Medford, Oregon 97501

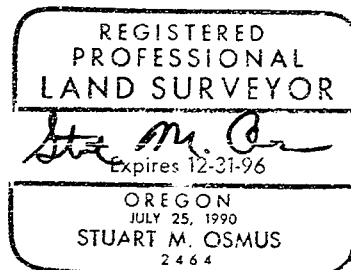
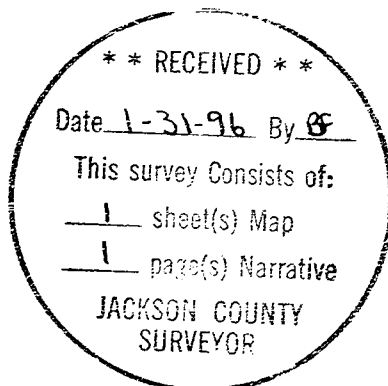

Stuart M. Osmus
Oregon Professional Land Surveyor No. 2464