

1475

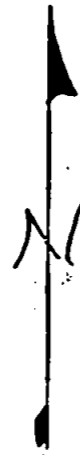

SOLAR OBSER.

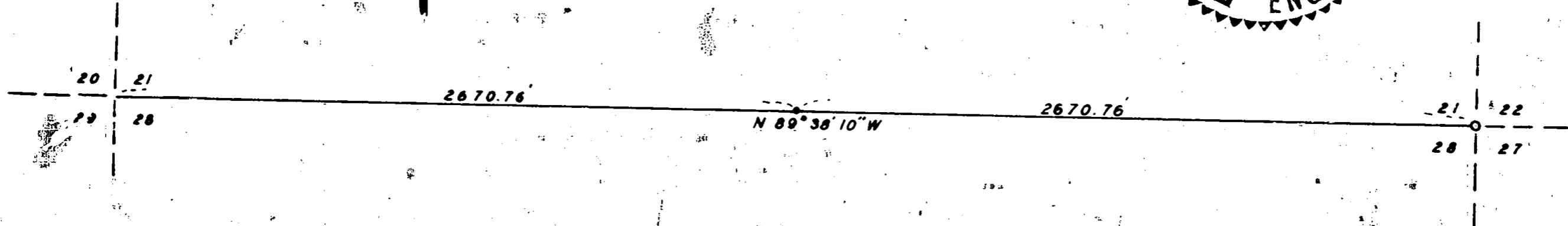
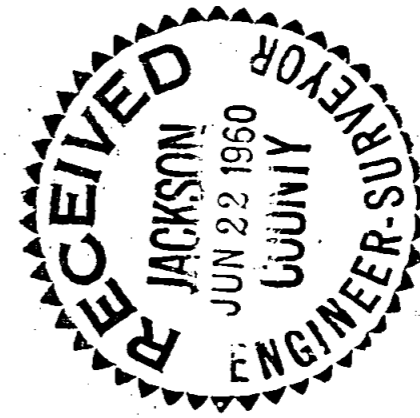

SURVEY FOR ROSS LUMBER CO.  
 IN SEC. 21, T. 38 S., R. 4 E., W. M.  
 60-8-1

BY EDWARD MCGINTY  
 MEDFORD OREGON  
 JUNE, 1960

SCALE: 1"=500'  
 ○ = 3/4" PIPE SET  
 ○ = 1" GAL. PIPE FD.

REGISTERED  
 OREGON  
 LAND SURVEYOR

*Edward A. McGinty*

JULY 10, 1960  
 EDWARD A. MCGINTY  
 301

1475

Survey No. \_\_\_\_\_

Survey Narrative to comply with O.R.S. 209-205 and O.R.S. 209-120.

Survey for: Ross Lumber Co.Survey by: Edward A. McGinty, L.S.  
6/17/60

BASIS OF BEARING: Solar observation.

PURPOSE OF SURVEY: To establish the 1/4 corner between Sec. 21 and 28 at a proportional distance as shown.

At the corner of Sec. 20, 21, 28 &amp; 29, found the original BT, now a 26 in. Fir S.70°E., 36.98 Ft.

Tree to the NE, removed by road construction.

Tree to the NW, stump indentation.

Tree to the SW, removed by road construction.

Corner falls in road bed, and from this point;

Mkd. Fir, 18 in. diam., N.18°W., 68.1 ft., scribed 301 BT.

Mkd. Fir, 22 in. diam., S.76½°W., 36.55 ft., scribed 301 BT.

Mkd. Fir, 10 in. diam., N.74½°E., 32.2 ft., scribed 301 BT.

Original BT now a Fir, 26 in. diam., S.70°E., 36.98 ft.

At the 1/4 corner between Sec. 21 &amp; 28, set a 3/4 in. iron pipe, 24 in. long, 20" in the ground in a rock mound at a proportional distance from which:

A Fir, 10 in. diam., bears S.41°E., 12.1 ft., scribed 301 BT.

A Fir, 9 ins. diam., bears N.21½°E., 43.9 ft., scribed 301 BT.

At corner 21, 22, 28 &amp; 27, found a 1 in. cap pipe, according to the official record of the re-established records made in 1956 by the County Surveyor.

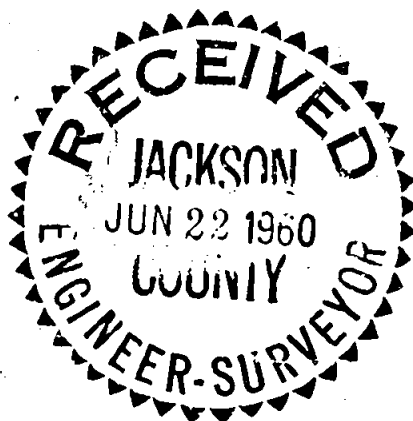

*Edward A. McGinty*

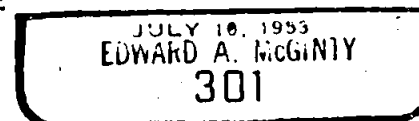

Survey No. \_\_\_\_\_

Survey Narrative to comply with O.R.S. 209-205 and O.R.S. 209-120.

Survey for: Ross Lumber Co.Survey by: Edward A. McGinty, L.S.

6/17/60

BASIS OF BEARING: Solar observation.

PURPOSE OF SURVEY: To establish the 1/4 corner between Sec. 21 and 28 at a proportional distance as shown.

At the corner of Sec. 20, 21, 28 &amp; 29, found the original BT, now a 26 in. Fir S.70°E., 36.98 Ft.

Tree to the NE, removed by road construction.

Tree to the NW, stump indentation.

Tree to the SW, removed by road construction.

Corner falls in road bed, and from this point;

Mkd. Fir, 18 in. diam., N.18°W., 68.1 ft., scribed 301 BT.

Mkd. Fir, 22 in. diam., S.76½°W., 36.55 ft., scribed 301 BT.

Mkd. Fir, 10 in. diam., N.74½°E., 32.2 ft., scribed 301 BT.

Original BT now a Fir, 26 in. diam., S.70°E., 36.98 ft.

At the 1/4 corner between Sec. 21 &amp; 28, set a 3/4 in. iron pipe, 24 in. long, 20" in the ground in a rock mound at a proportional distance from which;

A Fir, 10 in. diam., bears S.41°E., 12.1 ft., scribed 301 BT.

A Fir, 9 ins. diam., bears N.21½°E., 43.9 ft., scribed 301 BT.

At corner 21, 22, 28 &amp; 27, found a 1 in. cap pipe, according to the official record of the re-established records made in 1956 by the County Surveyor.

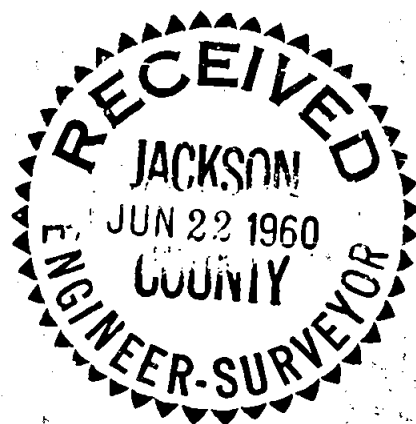

*Edward A. McGinty*

