

PARTITION PLAT NO. P-69-1995
LAND PARTITION (LDP-95-14)

LOCATED IN:

the Northwest 1/4 of Section 19,
Township 37 South, Range 1 West, W.M.,
Tax Lot 1400
City of Medford, Jackson County, Oregon

FOR:

Gregory Hornecker et. al.
P.O. Box 670
Medford, Oregon 97501

DECLARATION:

KNOW ALL MEN BY THESE PRESENTS, that we, Gregory T. Hornecker, R. Ray Heysell, E. Larus Smith and Dorothy J. Smith, Robert H. Hutchins, John Batzer and Jack Batzer, Pulver & Leaver Real Estate Company 401K Profit Sharing Plan and Helen C. Hoffbuhr, Trustee of the Family Credit Shelter Trust established by the Jack A. Hoffbuhr Living Trust are the owners of the real property represented on this Partition Plat and more particularly described in the SURVEYOR'S CERTIFICATE, and have caused the same to be partitioned into parcels as shown on the Partition Plat. We hereby dedicate to the public for public use those easements labeled as public utility easements, and to the City of Medford those easements labeled as storm drain easements, and to the City of Medford Water Commission those easements labeled as water line easements.

STATE OF OREGON }
COUNTY OF JACKSON }

Gregory T. Hornecker
Gregory T. Hornecker

Personally appeared the above named Gregory T. Hornecker and acknowledged the foregoing instrument to be his voluntary act and deed before me this 19th day of July, 1995.

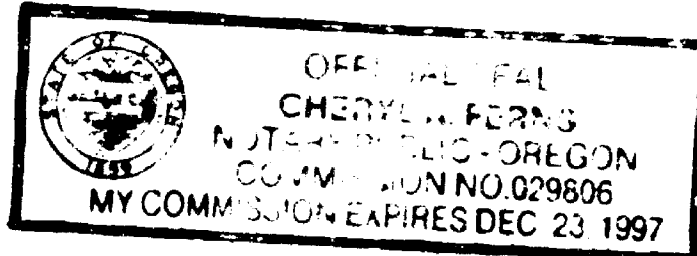

Cheryl A. Ferris
Notary

STATE OF OREGON }
COUNTY OF JACKSON }

R. Ray Heysell
R. Ray Heysell

Personally appeared the above named R. Ray Heysell and acknowledged the foregoing instrument to be his voluntary act and deed before me this 20th day of July, 1995.



Roberta B. Kent
Notary
My Commission exp. 9/25/95

STATE OF OREGON }
COUNTY OF JACKSON }

E. Larus Smith
E. Larus Smith

Personally appeared the above named E. Larus Smith and acknowledged the foregoing instrument to be his voluntary act and deed before me this 19th day of July, 1995.

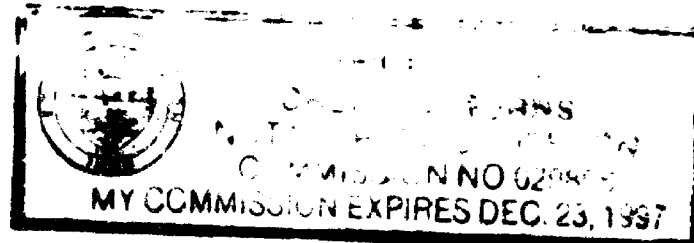

Cheryl A. Ferris
Notary

STATE OF OREGON }
COUNTY OF JACKSON }

Dorothy J. Smith
Dorothy J. Smith

Personally appeared the above name Dorothy J. Smith and acknowledged the foregoing instrument to be her voluntary act and deed before me this 19th day of July, 1995.

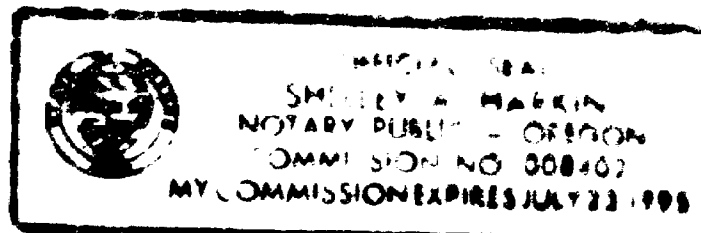

Shirley A. Macken
Notary

STATE OF OREGON }
COUNTY OF JACKSON }

Robert H. Hutchins
Robert H. Hutchins

Personally appeared the above named Robert H. Hutchins and acknowledged the foregoing instrument to be his voluntary act and deed before me this 19th day of July, 1995.

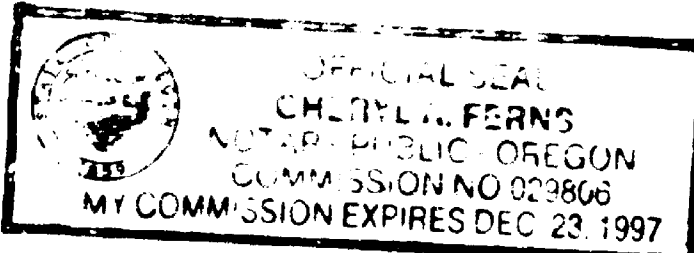

Cheryl A. Ferris
Notary

STATE OF OREGON }
COUNTY OF JACKSON }

John Batzer
John Batzer

Personally appeared the above named John Batzer and acknowledged the foregoing instrument to be his voluntary act and deed before me this 19th day of July, 1995.

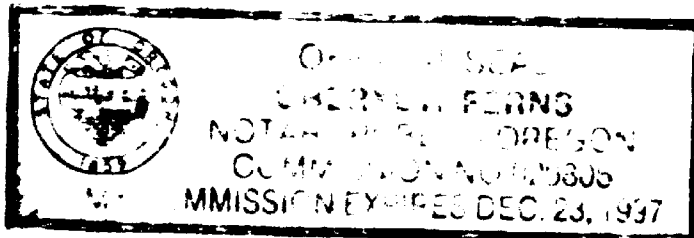

Cheryl A. Ferris
Notary

STATE OF OREGON }
COUNTY OF JACKSON }

Jack Batzer
Jack Batzer

Personally appeared the above named Jack Batzer and acknowledged the foregoing instrument to be his voluntary act and deed before me this 19th day of July, 1995.

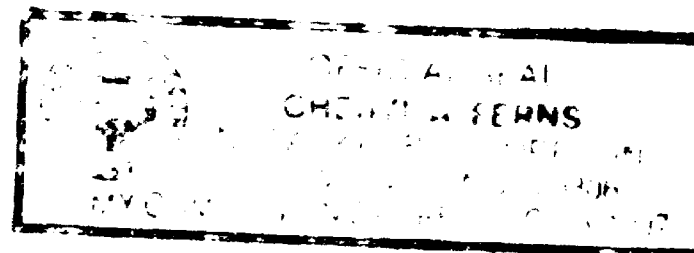

Cheryl A. Ferris
Notary

STATE OF OREGON }
COUNTY OF JACKSON }

Frank J. Pulver III
Frank J. Pulver III, Co-Trustee

The foregoing instrument was acknowledged before me this 19th day of July, 1995, by Frank J. Pulver III, known to me as the person who executed the within instrument on behalf of Pulver And Leaver Real Estate Company 401K Profit Sharing Plan.

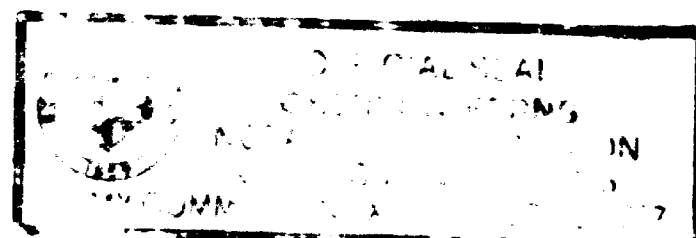

Cheryl A. Ferris
Notary

STATE OF OREGON }
COUNTY OF JACKSON }

William L. Leaver
William L. Leaver, Co-Trustee

The foregoing instrument was acknowledged before me this 19th day of July, 1995, by William L. Leaver, known to me as the person who executed the within instrument on behalf of Pulver And Leaver Real Estate Company 401K Profit Sharing Plan.

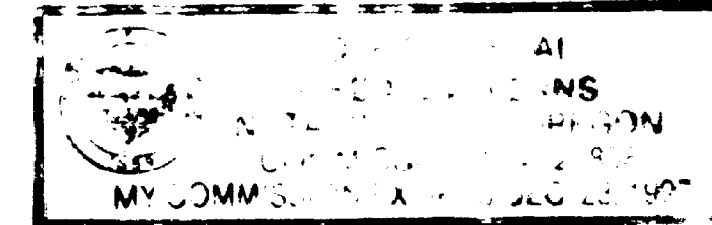

Cheryl A. Ferris
Notary

STATE OF OREGON }
COUNTY OF JACKSON }

Helen C. Hoffbuhr
Helen C. Hoffbuhr, Trustee

The foregoing instrument was acknowledged before me this 19th day of July, 1995, by Helen C. Hoffbuhr, known to me as the person who executed the within instrument on behalf of the Family Credit Shelter Trust.

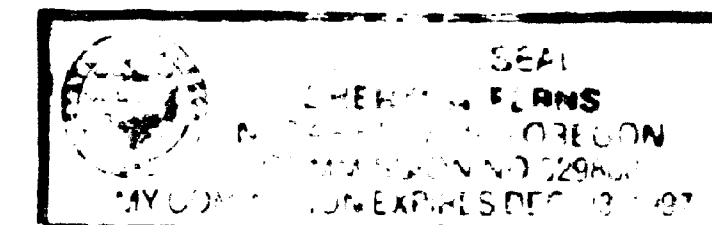

Cheryl A. Ferris
Notary

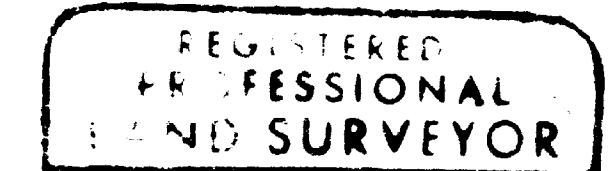
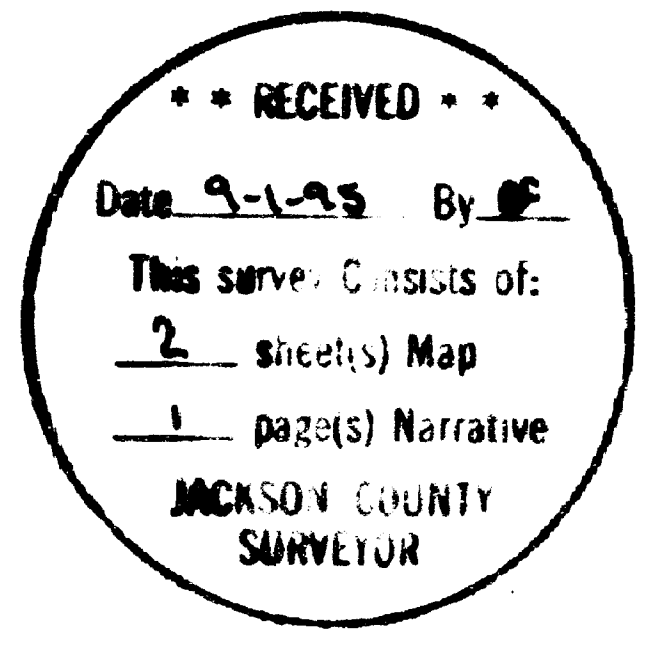

David M. Minner
DAVID M. MINNER
EXPIRES 12-31-96

I certify this plat to be an exact photocopy of the original
David M. Minner
SURVEYOR

SURVEY NO. 14650

**SURVEY NARRATIVE TO COMPLY WITH PARAGRAPH 209.250
OREGON REVISED STATUTES**

Survey for: Gregory Hornecker, et.al.
P.O. Box 670
Medford, Oregon 97501

Location: Tax Lot 1400 in the Northwest one-quarter of Section 19, Township 37 South, Range 1 West, Willamette Meridian, City of Medford, Jackson County, Oregon

Purpose: To survey, monument and record a Partition Plat (File No. LDP-95-15) per client's request

Procedure: Utilizing control established by this office per Survey No. 14203 and found monumentation per Surveys No. 9038 and 11416, I set monuments as shown on the accompanying Partition Plat.

Basis of Bearing: South line of Donation Land Claim No. 40 per Survey No. 14203

Date: June 5, 1995

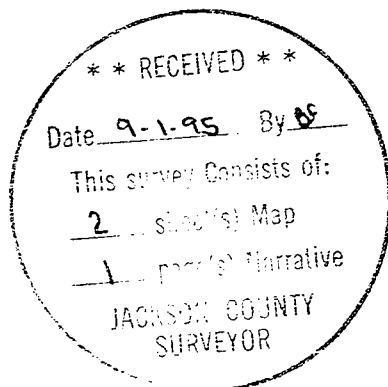

David M. Minneci
L.S. 2349 - Oregon
Expires 12/31/96
Hoffbuhr & Associates, Inc.
1062 East Jackson Street
Medford, Oregon 97504

BEARING LINE TABLE

NO.	BEARING	DISTANCE
E1	S00°44'00" W	114.21'
E2	S89°16'00" E	15.00'
E3	S00°44'00" W	10.00'
E4	N89°16'00" W	16.00'
E5	S00°44'00" W	29.00'
E6	N89°16'00" W	10.00'
E7	N00°44'00" E	24.00'
E8	N89°16'00" W	17.00'
E9	N00°44'00" E	10.00'
E10	S89°16'00" E	17.00'
E11	N00°44'00" E	119.21'
E12	S00°44'00" W	143.30'
E13	N89°16'00" W	6.34'
E14	S64°08'12" W	16.78'

PARTITION PLAT NO. P-69-1995
LAND PARTITION (LDP-95-14)

LOCATED IN:
 the Northwest 1/4 of Section 19,
 Township 37 South, Range 1 West, W.M.,
 Tax Lot 1400
 City of Medford, Jackson County, Oregon

FOR:
Gregory Hornecker et. al.
 P.O. Box 670
 Medford, Oregon 97501

APPROVALS:

CITY OF MEDFORD PLANNING

David M. Minnecci Director August 16, 1995 Date

Examined and approved this 10 day of August, 1995.

David M. Minnecci
 City Surveyor

RECORDER'S CERTIFICATE:
 FILED FOR RECORD THIS 01 DAY OF September 1995, AT 10:49 O'CLOCK, A.M.
 AND RECORDED AS PARTITION PLAT NO. P-69-1995 OF "RECORD OF PARTITION PLATS"
 IN JACKSON COUNTY, OREGON. (INDEX VOLUME 6 PAGE 69)

Ruth Ann S. Beckett County Clerk *Glenda E. Bartlett* Deputy

FILED IN THE OFFICE OF THE JACKSON COUNTY SURVEYOR AS NO. 14650

WATER RIGHTS STATEMENT: There are no Water Rights appurtenant to this property.

SURVEYOR'S CERTIFICATE

I, David M. Minnecci, a duly Registered Surveyor of the State of Oregon, do hereby certify that this map correctly represents a survey made by me and complies with regulations for Land Partitions and the following is an accurate description of the parent tract of land as set forth hereon:

Commencing at the Southeast corner of Donation Land Claim No. 40 in Township 37 South Range 1 West of the Willamette Meridian, Jackson County, Oregon; thence North 89°51'00" West, along the Southerly line of said Claim, 2864.55 feet; thence, leaving said Claim line, North 00°54'18" East 462.69 feet; thence North 00°50'47" East 220.89 feet; thence North 00°58'45" East 236.51 feet; thence North 01°00'11" East 80.94 feet to the INITIAL POINT OF BEGINNING; thence North 00°49'22" East 153.30 feet to the Southeast corner of that tract described in Document No. 88-20049, Official Records of said Jackson County; thence North 89°16'00" West, along the Southerly line of said tract, 586.87 feet (Record 587.00 feet) to the Easterly right-of-way line of Biddle Road; thence South 15°42'45" East, along said Easterly line, 144.87 feet; thence South 21°11'18" East 14.23 feet; thence, leaving said Easterly line, South 89°16'00" East 545.23 feet to the Initial Point of Beginning.

David M. Minnecci
 Surveyor

All taxes, fees, assessments or other charges as required by O.R.S. 92.005 have been paid as of this 17 day of August, 1995.

Ben Hubbey Assessor August 17 1995 Date
K. Narretiva Tax Collector 8-17-95 Date

HOFFBANK & ASSOCIATES, INC.
 1002 E. JACKSON MEDFORD, OREGON
 778-4841

By: *David M. Minnecci* RPLS No. 2340
 Scale: 1 inch = 80' June 8, 1995
 Book of Bearings: Survey Number 14288
 (South line S/LC NO. 40)

- = Set 5/8" x 24" iron pin with plastic cap stamped "D. MINNECCI LS 2348"
- ⊗ = Set 5/8" x 30" iron pin with plastic cap stamped "D. MINNECCI LS 2348"
- ⊗ = Found 5/8" iron pin with plastic cap stamped "D. MINNECCI LS 2348" (See Narrative)
- = Found monument as noted
- = Found brass cap monument
- S/N = Survey number
- PUE = Easement for public utilities, storm drainage, gas, water, electric, cable television and sanitary sewer construction and maintenance

(Not visited this Survey)

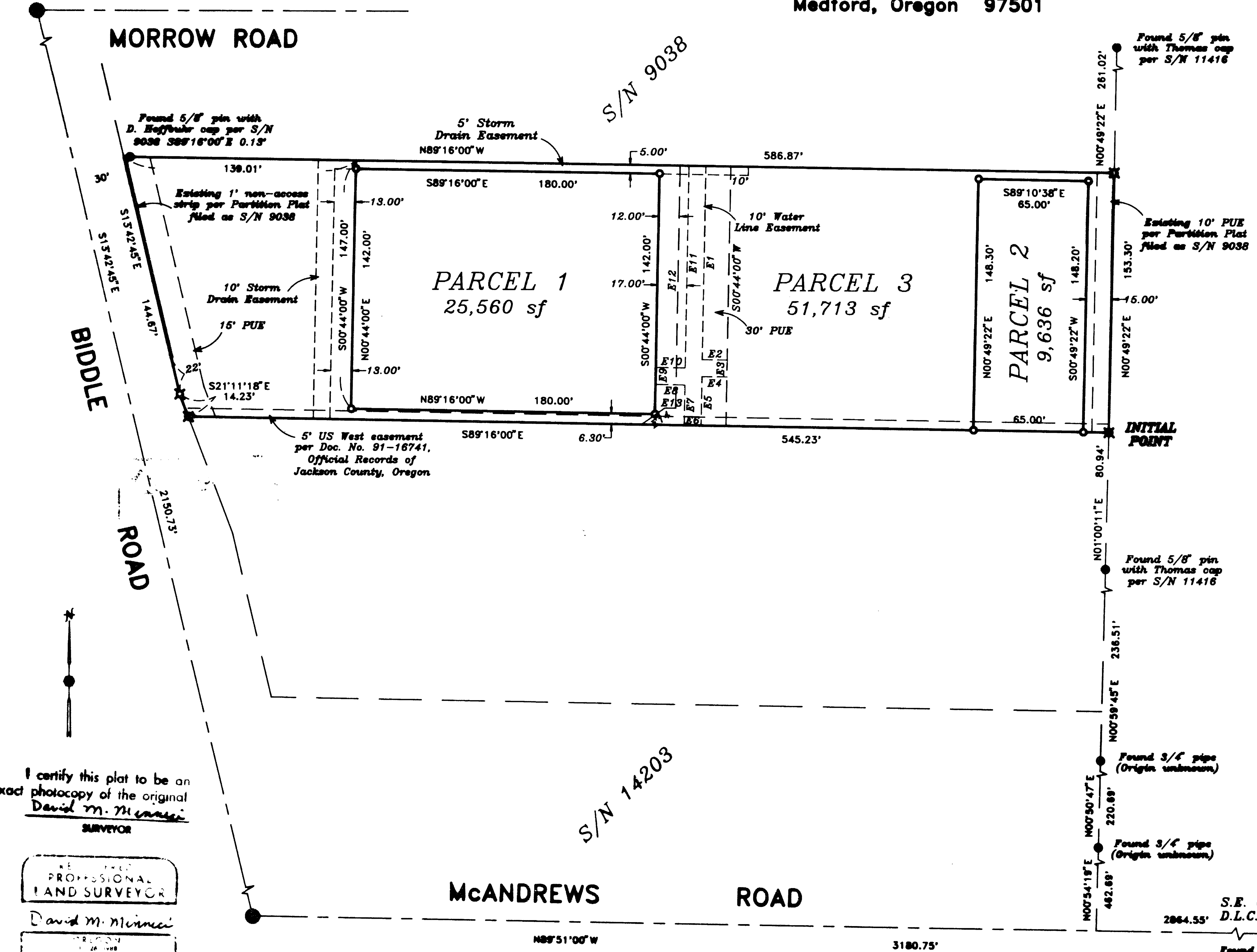

I certify this plat to be an exact photocopy of the original
David M. Minnecci
 SURVEYOR

PROFESSIONAL LAND SURVEYOR
David M. Minnecci
 D.M. MINNECCI

Expires 12-31-96

375 1W 1988 TL1400

NOTE:
 1.) Existing Reciprocal Easement Agreement per Document No. 94-10206, Official Records of Jackson County. (Location may vary)