

SURVEY FOR
 Nick Preboski
 835 Alder Creek Road
 Suite "B"
 Medford, Oregon
 97504

LOCATION
 SE 1/4 of Section 29,
 T.38S., R.1E., W.M.,
 Jackson County, Oregon

SURVEY BY
 Boyden Surveyors
 108 Mistletoe Street
 Medford, Oregon
 97501

DATE
 June 27, 1995

BASIS of BEARINGS
 North Boundary of Ashland Lane
 per F.S. No. 2641

- LEGEND**
- Fd. 3/4" Iron Pipe
Set on Filed Survey No. 2641
 - ✕ Found yellow cap monument marked
"Jackson Co. Public Works"
Set on Filed Survey No. 9883
 - Set 5/8" x 24" Rebar with red
plastic cap stamped "BOYDEN RLS 281"
W.C. 0.01' S. & 0.04' E. from true
corner

**** RECEIVED ****
 Date 7-18-95 By SK
 This survey Consists of:
 / sheet(s) Map
 / page(s) Narrative
JACKSON COUNTY
SURVEYOR

Scale: 1" = 200'

REGISTERED
PROFESSIONAL
LAND SURVEYOR

Mark E. Boyden

OREGON
 NOV. 9, 1851
MARK E. BOYDEN
 281

EXPIRES 12/31/95.

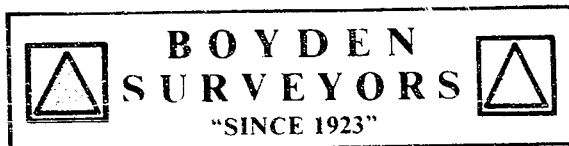

MARK E. BOYDEN
R.P.L.S. ORE. 281
108 MISTLETOE ST., MEDFORD, OREGON 97501
PHONE (503) 773-6000

SURVEY NO. 14582

SURVEY NARRATIVE TO COMPLY WITH O.R.S. 209.250

SURVEY FOR: NICK PREBOSKI
815 ALDER CREEK ROAD, SUITE "B"
MEDFORD, OREGON 97501

SURVEY BY: BOYDEN SURVEYORS
108 MISTLETOE STREET
MEDFORD, OREGON 97501

LOCATION: SE ¼ of Section 29,
Township 38 South, Range 1 East,
West Meridian, Jackson County,
Oregon

BASIS OF BEARINGS: North boundary of Ashland Lane per
Filed Survey #2641

DATE: JUNE 21, 1995

PURPOSE: To locate the existing corner
monuments set on Filed Survey No.
2641, and set the Northwest property
corner, which corner monument was
not found, all being described in
Instrument No. 92-13485, O.R. (as
recited from bearings and distances
from Filed Survey No. 2641).

PROCEDURE: With E.D.M. equipment, enclosed the
subject tract, tying in monuments found at the base
of Yewwood fence corner posts set in concrete as shown.
The Northwest property corner is also set at the base of a
Yewwood post in concrete, but the original monument was
not found.

