

MAP OF SURVEY

LOCATED in the NE 1/4 of Section 5 & the NW 1/4 of Section 4, T. 40 S., R. 3 E., W.M., in Jackson County, Oregon.

October 11, 1994

TYLER CREEK ROAD
(60' R/W)

Point 33' South of the South line of the NW 1/4 of the NE 1/4 per Deed Record

Doc. No. 95-01970
ADJUSTED TAX LOT 116
24.3 Acres ±

Doc. No. 95-01969
ADJUSTED TAX LOT 300
157.3 Acres ±

Section Corner
Fz. J.C.S.
Brass Cap

North
1/4 Corner
Section 4

North 1/16 Corner
Fd. 1" diam. l. Pipe
per S.N. 4269

LINE TABLE

NO.	BEARING	DISTANCE
1	N44°58'38"E	167.27'
2	S36°48'48"E	133.24'
3	S21°54'32"E	27.91'
4	S11°17'22"E	102.92'
5	S01°23'38"E	183.95'
6	S24°22'58"E	421.62'
7	S33°33'18"E	450.43'
8	S33°33'18"E	45.17'
9	S00°00'00"W	62.94'
10	N00°21'19"E	82.81'

SURVEYED FOR: Dean Shutt
P.O. Box 221209
Anchorage, Alaska 99522

SURVEYED BY: Edwards Surveying and Land Planning, Inc.
816 West 8th Street
Medford, Oregon 97501
Phone (503) 776-2313

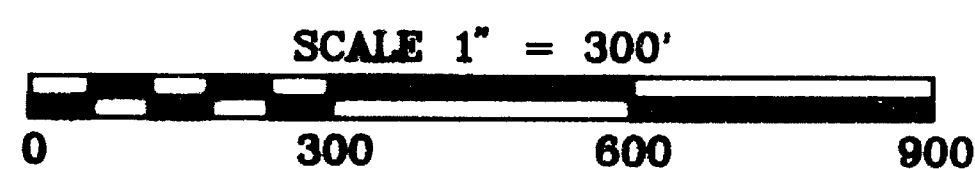

LEGEND

- o Indicates 5/8" x 24" steel pin w/red plastic cap mkd. "D.A. EDWARDS-LS 2339" set.
- () Denotes original Gov't survey record data.
- < > Denotes Deed Record data.

J.C.S. = Jackson County Surveyor
S.N. = Survey Number

BASIS OF BEARINGS: Survey Number 4269 as shown hereon.

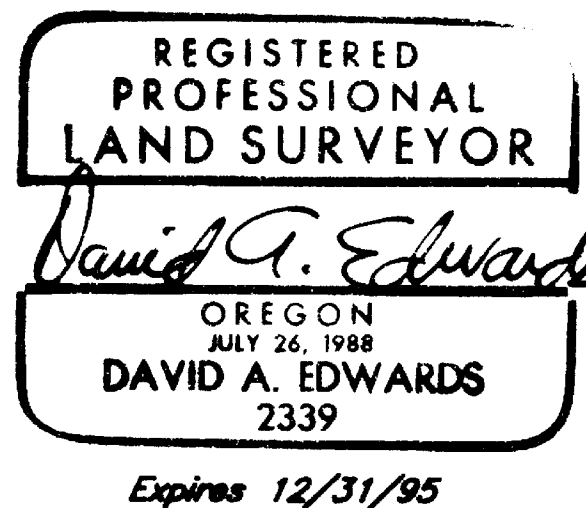
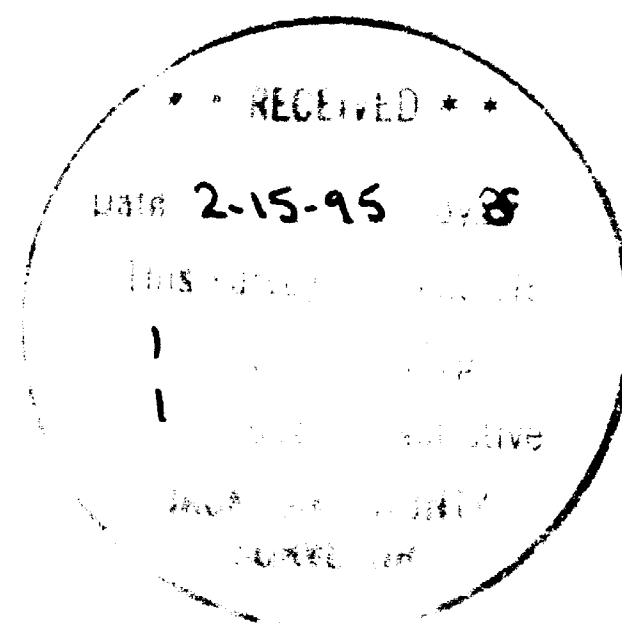

APPROVAL: 94-52-LLA

Approved by the Jackson County Department of Planning and Development.

By Bobbi Becker Date January 24, 1995

Edwards Surveying & Land Planning Inc.

816 West 8th Street
Medford, OR 97501
Tel.: (503) 776-2313
FAX: (503) 776-9978



223 SW "I" Street
Grants Pass, OR 97526
Tel.: (503) 471-7059
FAX: (503) 471-7809

SURVEYING • ENGINEERING • PLANNING

SURVEY NUMBER 14403

SURVEY NARRATIVE TO COMPLY WITH CHAPTER 209, PARAGRAPH 250,
OREGON REVISED STATUTES

SURVEY FOR: Dean Shutt
P.O. Box 221209
Anchorage, Alaska 99522

LOCATION: In the NE 1/4 of Section 5 and in the NW 1/4 of
Section 4, T. 40 S., R. 3 E., W.M., Jackson
County, Oregon.

PURPOSE: PROPERTY LINE ADJUSTMENT; County Planning Dept.
File 94-52-LLA: To locate and monument the
adjusted boundary between the subject
properties and to prepare new legal
descriptions of the adjusted tracts.

PROCEDURE: Utilizing for control the found monuments as
shown, set pins in the approximate center of
Soda Mountain Road for the new boundary. Using
deed record data and data from Survey Number
4269, prepared the necessary legal
descriptions. Monuments set on this survey
consist of 5/8" x 24" steel pins with red
plastic caps mkd. "D.A. EDWARDS-LS 2339".

BASIS OF
BEARINGS: Survey Number 4269 as shown.

EQUIPMENT: Nikon DTM-A5 Electronic Total Station.

DATE
COMPLETED: October 11, 1994.

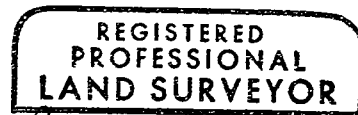
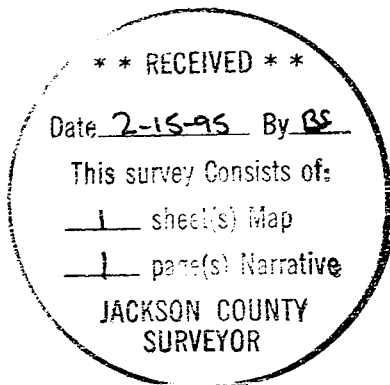

David A. Edwards

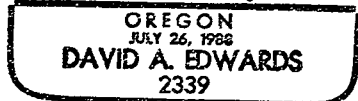

Expires 12/31/95