

SUBDIVISION OF SECTION 20
SCALE 1"=1000'

G.R. = Government Record
 Chs. = Chains

Proportional Sec. Cor.
 Set 2 1/2"x24" I. Pipe (exrg6")
 w/3"br. disc stamped:

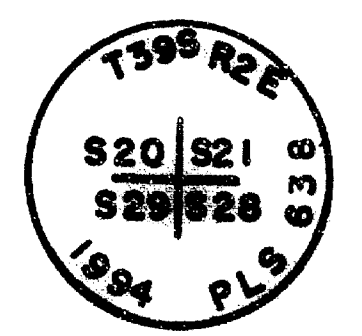

Referenced as follows:
 A 5/8" I. Pin bears N37°32'E
 65.26 ft.
 A 20 1/2" W. Oak bears S40°00'E
 40.2 ft. to bottom center
 A 12 1/2" W. Oak bears N18°00'W
 49.5 ft. to bottom center

SUBDIVISION OF NE 1/4 SW 1/4 OF SECTION 20
SCALE 1"=300'

SCALE 1"=200'
 (unless noted otherwise)

Basis of Bearings R.S. No. 5242

LEGEND

- = Set 5/8"x30" I. Pin (tagged P.L.S. 638) unless noted
- = Found 5/8" I. Pin per R.S. No. 8871
- ⊙ = Found 5/8" I. Pin per R.S. No. 5242
- G.R. J.C.O. = Official Records Jackson County Oregon
- D.R. J.C.O. = Deed Records Jackson County Oregon

MAP OF SURVEY

Located in the S.W.1/4 of Section 20, Twp. 39S, R2E
 For: JACK BEATON
 By: George Burrell, P.L.S., 1379 Brookdale Road
 Medford, Oregon 97504, Oct. 4, 1994

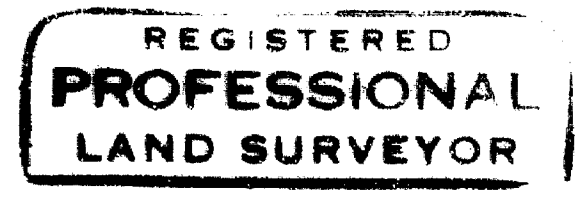
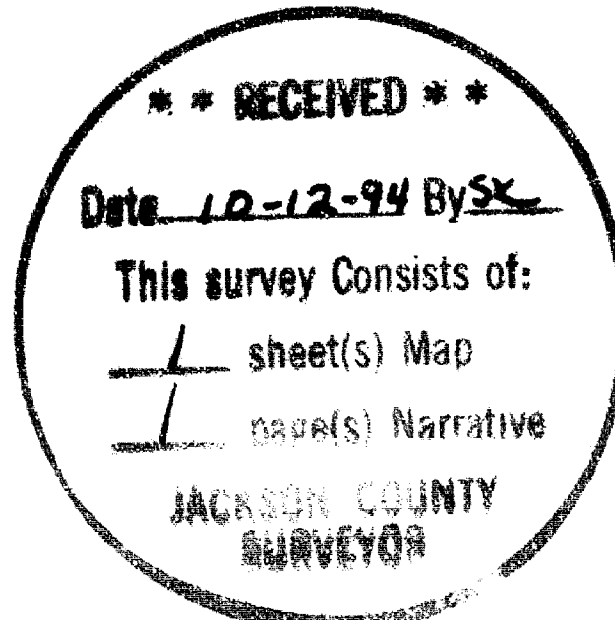

George Burrell
 OREGON
 JULY 10, 1964
 GEORGE B. BURRELL
 638

Exp. 12/31/95

SURVEY NARRATIVE TO COMPLY WITH O.R.S. 209.250

FOR:

Jack Beaton
 c/o John Archer
 1941 Siskiyou Blvd.
 Ashland, Oregon 97520

LOCATION:

The Southwest 1/4 of Section 20, Township 39 South, Range 2 East

PURPOSE:

To monument the clients West, South, East and a portion of his North boundary.

PROCEDURE:

The found monuments of Recorded Survey No. 5242 were held for control of the West boundary. The clients Southerly boundary was established through condemnation proceedings by the Bureau of Reclamation in 1958, (see Volume 458, Page 464, Parcel 2 of Deed Records) at which date they acquired said parcel 2 from Keith Corp and fenced said boundary. The description for this parcel begins at the South 1/4 corner of Section 20.

An analysis of the deed record calls from the proportional position for the South 1/4 corner as determined by me would locate the clients Southerly boundary considerably in error in relation to the Bureau of Reclamation fence. Using the record deed call to the West 1/4 corner of section 20, as shown on the accompanying map, and by holding 590.00 feet rather than 580.00 feet (a possible transposition?) on the course shown as North 55° 57' East, results in a location that fits the Bureau of Reclamation fence very well, and was adopted by me for monumenting said boundary.

The East boundary and a portion of the clients North boundary required that section 20 be subdivided. This was accomplished as follows: At the corner common to Sections 20, 21, 28 and 29 and the 1/4 corner common to Sections 28 and 29, no original or contemporary evidence could be found to reestablish said corners. Also, no evidence could be ascertained for the reestablishment of the 1/4 corner common to Sections 20 and 29, as this position is presently under the waters of Emigrant Lake. Therefor, the corner common to Sections 20, 21, 28 and 29, was proportioned and monumented as shown on the accompanying map. Section 20 was then subdivided as shown and monuments were set for corners along the clients East and a portion of his North boundary, from which I closed the West line of the S.E. 1/4 of the N.W. 1/4 upon the boundary line described in Document No. 81-17113 of the Official Records of Jackson County.

BY: George Burrell, P.L.S.
 1379 Brookdale Road
 Medford, Oregon 97504

Oct. 4, 1994

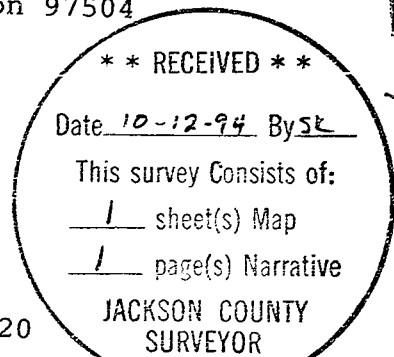
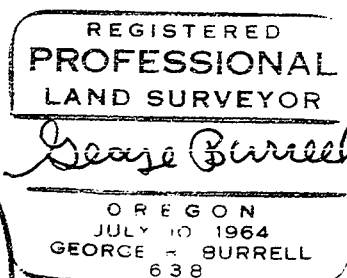

Exp. 12/31/95