

DIAMOND VILLAGE SUBDIVISION, UNIT NO. 2

Located in:

The S.E. and S.W. 1/4 of Section 36,
Donation Land Claim No. 82,
Township 37 South, Range 2 West, W.M.,
City of Medford, Jackson County, Oregon

*** DECLARATION ***

KNOW ALL MEN BY THESE PRESENTS, that VAN WEY HOMES, INC., an Oregon Corporation, is the owner in fee simple of the lands hereon described, and that they have subdivided the same into lots and streets as shown hereon, and the number of each lot and the course and length of all lines are plainly set forth, and that this plat is a correct representation of the subdivision, and we do hereby dedicate to the public for public use the streets shown hereon, together with those easements labeled as public utility easements, and we hereby grant to the City of Medford in fee simple, that area portrayed and designated hereon as a 1-foot street plug. By its approval of this plat, the City of Medford declares that upon dedication of the extension of the affected streets, it thereby dedicates the street plugs for public street purposes. We hereby designate said subdivision as DIAMOND VILLAGE SUBDIVISION, UNIT NO. 2.

STATE OF OREGON)
County of Jackson)

Wayne Van Wey
VAN WEY HOMES, INC.
Wayne Van Wey, President

This instrument was acknowledged before me this 2nd day of June, 1994, by Wayne Van Wey, known to me as the person who executed the within instrument on behalf of VAN WEY HOMES, an Oregon Corporation.

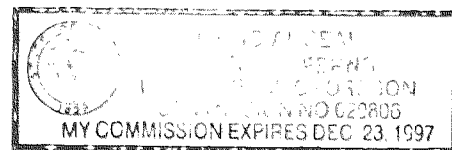

Cheryl A. Ferns

STATE OF OREGON)
County of Jackson)

Clayton R. Johnson
VAN WEY HOMES, INC.
Clayton R. Johnson, Vice President

This instrument was acknowledged before me this 2nd day of June, 1994, by Clayton P. Johnson, known to me as the person who executed the within instrument on behalf of VAN WEY HOMES, an Oregon Corporation.

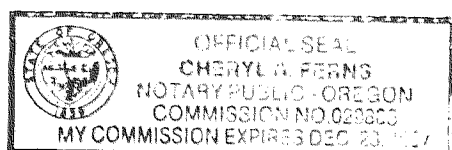

Cheryl A. Ferns

We, James E. Pope and Jean A. Pope, husband and wife, the undersigned beneficiary of a certain Trust Deed recorded November 13, 1992 as Document No. 92-34831, Official Records of Jackson County, Oregon, affecting the land described herein, hereby release from the lien of said Trust Deed all property shown hereon as dedicated to the public for public use.

Signed this 2nd day of June, 1994

Before me: James E. Pope
James E. Pope

Jean A. Pope
Jean A. Pope

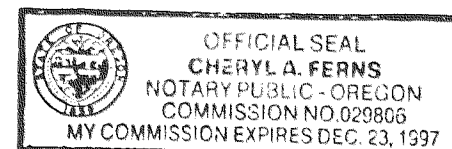

Cheryl A. Ferns

We, Bank of Southern Oregon, the undersigned beneficiary of a certain Trust Deed recorded April 22, 1994 as Document No. 94-15353, Official Records of Jackson County, Oregon, affecting the land described herein, hereby release from the lien of said Trust Deed all property shown hereon as dedicated to the public for public use.

Signed this 2 day of June, 1994

Before me: Anna T. Anispe
Anna T. Anispe
Title

Michael Hoyt
President
Title

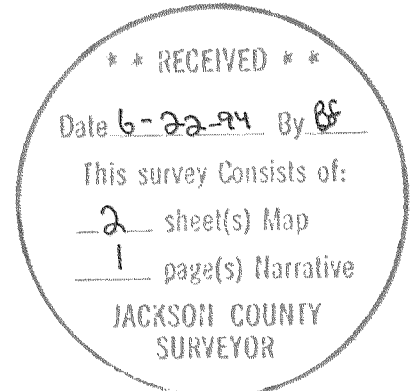
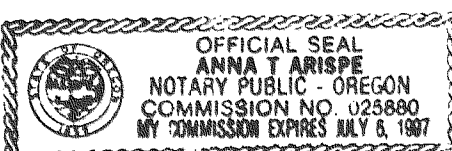

I certify this plat to be an exact photocopy of the original.
David M. Minnici
SURVEYOR



*** SURVEYOR'S CERTIFICATE ***

STATE OF OREGON)
County of Jackson)

I, David M. Minnici, a duly Registered Professional Land Surveyor of the State of Oregon, do hereby certify that I have correctly surveyed and marked with the proper monuments as provided by law the tract of land hereon shown and the plat is a correct representation of the same, and the following is an accurate description of the boundary lines:

Commencing at the Northwest corner of Donation Land Claim No. 82 in Township 37 South, Range 2 West, Willamette Meridian, Jackson County, Oregon; thence South 00°05'26" East, to and along the Westerly boundary of GEORGIANNA VILLAGE SUBDIVISION, according to the Official Plat thereof, now of record, 619.61 feet to the Southwest corner thereof, said point being marked by a brass disc in concrete for the INITIAL POINT OF BEGINNING of DIAMOND VILLAGE SUBDIVISION, UNIT NO. 2; thence South 89°57'08" East, along the Southerly boundary of said Subdivision, 369.31 feet to the Southeast corner thereof, said point being on the Westerly boundary of DIAMOND VILLAGE SUBDIVISION, UNIT NO. 1; thence, along the boundary of said DIAMOND VILLAGE SUBDIVISION the following courses: South 00°05'26" East 24.88 feet; thence South 89°57'08" East 368.33 feet; thence North 00°05'21" East 278.00 feet; thence, leaving said Subdivision boundary, South 89°57'08" East 463.28 feet; thence South 00°06'29" West 136.02 feet; thence South 87°39'10" West 140.54 feet; thence, along the arc of a 50.00 foot radius curve to the right (the long chord to which bears South 10°32'18" East 18.47 feet), an arc distance of 18.58 feet; thence South 00°06'29" West 279.70 feet; thence, along the arc of a 100.00 foot radius curve to the left (the long chord to which bears North 83°16'42" West 23.28 feet), an arc distance of 23.33 feet; thence North 89°57'42" West 670.00 feet; thence South 00°05'18" West 135.63 feet; thence North 89°57'42" West 369.73 feet to the Westerly line of Donation Land Claim No. 82; thence North 00°05'26" West, along said Westerly line, 319.73 feet to the Point of Beginning.

David M. Minnici
SURVEYOR

*** APPROVALS ***

MEDFORD CITY PLANNING:

I certify that, pursuant to authority granted in Ordinance No. 5785 this plat is hereby approved.

James M. Eimbeck
Planning Director

JUNE 17, 1994
Date

Examined and approved this 10th day of JUNE, 1994.

Robert Sewell
City Engineer

Paul D. [Signature]
City Surveyor

Examined and approved as required by O.R.S. 92.100 as of June 21st, 1994.

Ron Lundberg Deputy
Assessor, Department of Assessment

Examined and approved as required by O.R.S. 92.095 as of June 21, 1994.

Lynda Abbott Deputy
Tax Collector

WATER RIGHTS STATEMENT: There are no water rights appurtenant to this property.

For order of the County Court approving this plat see Volume _____, page _____ of County Commissioners Journal of Proceedings.

Filed for record this 22 day of June, 1994 at 4:11 O'Clock P.M. and recorded in Volume 19 of Plats at page 26 of records of Jackson County, Oregon.

Kathleen S. Beckett
County Clerk

Cheryl Augeris
Deputy

SURVEY NO. 14067

**SURVEY NARRATIVE TO COMPLY WITH PARAGRAPH 209.250
OREGON REVISED STATUTES**

Survey for: Van Wey Homes, Inc.
1762 E. McAndrews Road
Medford, Or. 97504

Location: Southeast and Southwest one-quarter (1/4) of Section 36, Township 37 South, Range 2 West, Willamette Meridian, City of Medford, Jackson County, Oregon

Purpose: To survey, monument and prepare a subdivision plat for DIAMOND VILLAGE SUBDIVISION, UNIT NO. 2 per client's request

Procedure: Utilizing control and monumentation established in performance of Surveys No. 13640 and 13660, I set monuments as shown on the accompanying plat.

Basis of Bearing: West line of Survey No. 13640

Date: May 16, 1994

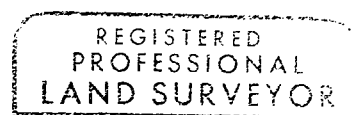
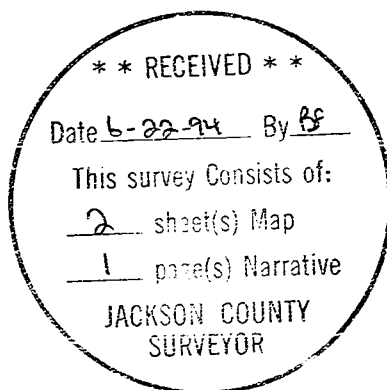

David M. Minneci

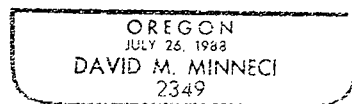

David M. Minneci
L.S. 2349 - Oregon
Expires 12/31/94
Hoffbuhr & Associates, Inc.
1062 East Jackson Street
Medford, Oregon 97504