

14053

**\*\* RECEIVED \*\***

Date 6-16-94 By ME

This survey Consists of:

- 1 sheet(s) Map
- 1 page(s) Narrative

JACKSON COUNTY  
SURVEYOR

REGISTERED  
PROFESSIONAL  
LAND SURVEYOR

*Mark E. Boyden*  
OREGON  
NOV. 6, 1981  
MARK E. BOYDEN  
281  
EXPIRES 12/31/95.

Survey for

Southern Oregon Historical Society  
106 N. Central Ave.  
Medford, Oregon  
97501

Location

E1/2 Sec. 21 and W1/2 Sec. 22,  
T37S, R. 2W., W.M., Jackson  
County, Oregon

Survey by

Boyden Surveyors  
108 Mistletoe St.  
Medford, Oregon  
97501

Date

June 10, 1994

Basis of Bearings

W. Bdry Filed Survey No. 1028

Legend

- Found monument as indicated
- Set 5/8" x 30" Rebar with red plastic cap marked "BOYDEN RLS 281"

NE COR  
DLC # 41  
Fd 2 1/2" BR. CAP 1 1/2" DEEP  
(CS 1987)

SW COR  
DLC # 69  
Fd 2 1/2" BR. CAP  
2" DEEP  
(CS 1985)

EAST 1228.40'

SOUTH  
644.97'

ROBERT D. HEFFERNAN JR. ET UX  
TRACT 1  
INS. # 92-02377, O.R.

MONUMENTED SOUTH SIDE OF EXISTING FENCE LINE

Y. CAP "FRIAR"  
ON 5/8" REBAR EXP. 2"

S2°20'40"W.,  
1.90'

SOUTHERN OREGON HISTORICAL SOCIETY  
INS # 82-16920 O.R.

- |                          |                          |
|--------------------------|--------------------------|
| ① S89°00'02" E., 45.85'  | ⑨ N87°33'58" E., 43.93'  |
| ② N89°24'07" E., 67.96'  | ⑩ S89°04'31" E., 218.97' |
| ③ N89°34'55" E., 326.60' | ⑪ S84°54'05" E., 13.74'  |
| ④ N89°57'35" E., 50.86'  | ⑫ S84°54'05" E., 20' ±   |
| ⑤ N89°20'50" E., 173.48' |                          |
| ⑥ N88°54'34" E., 81.87'  |                          |
| ⑦ N84°14'41" E., 182.94' |                          |
| ⑧ S88°45'29" E., 170.00' |                          |



Scale 1"=200'

372W - 22 TL 2800

14053

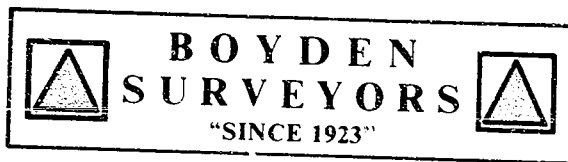

**MARK E. BOYDEN**  
R.P.L.S. ORE. 281  
108 MISTLETOE ST., MEDFORD, OREGON 97501  
PHONE (503) 773-6000

SURVEY NO. 14053

SURVEY NARRATIVE TO COMPLY WITH O.R.S. 209.250

SURVEY FOR: SOUTHERN OREGON HISTORICAL SOCIETY  
106 NORTH CENTRAL AVENUE  
MEDFORD, OREGON 97501

SURVEY BY: BOYDEN SURVEYORS  
108 MISTLETOE STREET  
MEDFORD, OREGON 97501

LOCATION: EAST-HALF OF SECTION 21, AND THE  
W. 1/2 OF SECT. 22, T. 37 S., R. 2 W.,  
W.M., JACKSON COUNTY, OREGON.

BASIS OF BEARINGS: WEST BOUNDARY OF FILED SURVEY  
NO. 1028

DATE: JUNE 10, 1994

PURPOSE: 1. To monument and memorialize the South side  
of an old existing fence line.

2. Prepare a description for the purpose of a  
proposed recorded boundary line agreement.

PROCEDURE: From monuments found, and utilizing EDM  
equipment, traversed to, along and from said fence line  
monumenting same at positions shown on the map to  
accompany this report. The yellow cap monument found  
near the West end of said fence line was set by Surveyor  
Friar for the Northwest corner of Instrument No. 82-16920,  
O.R. At this juncture in time, the Friar survey is still  
in progress.

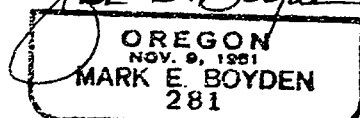
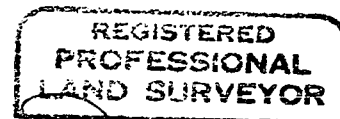
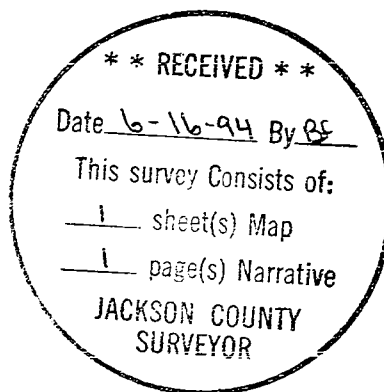

EXPIRES: 12/31/95.