

14051

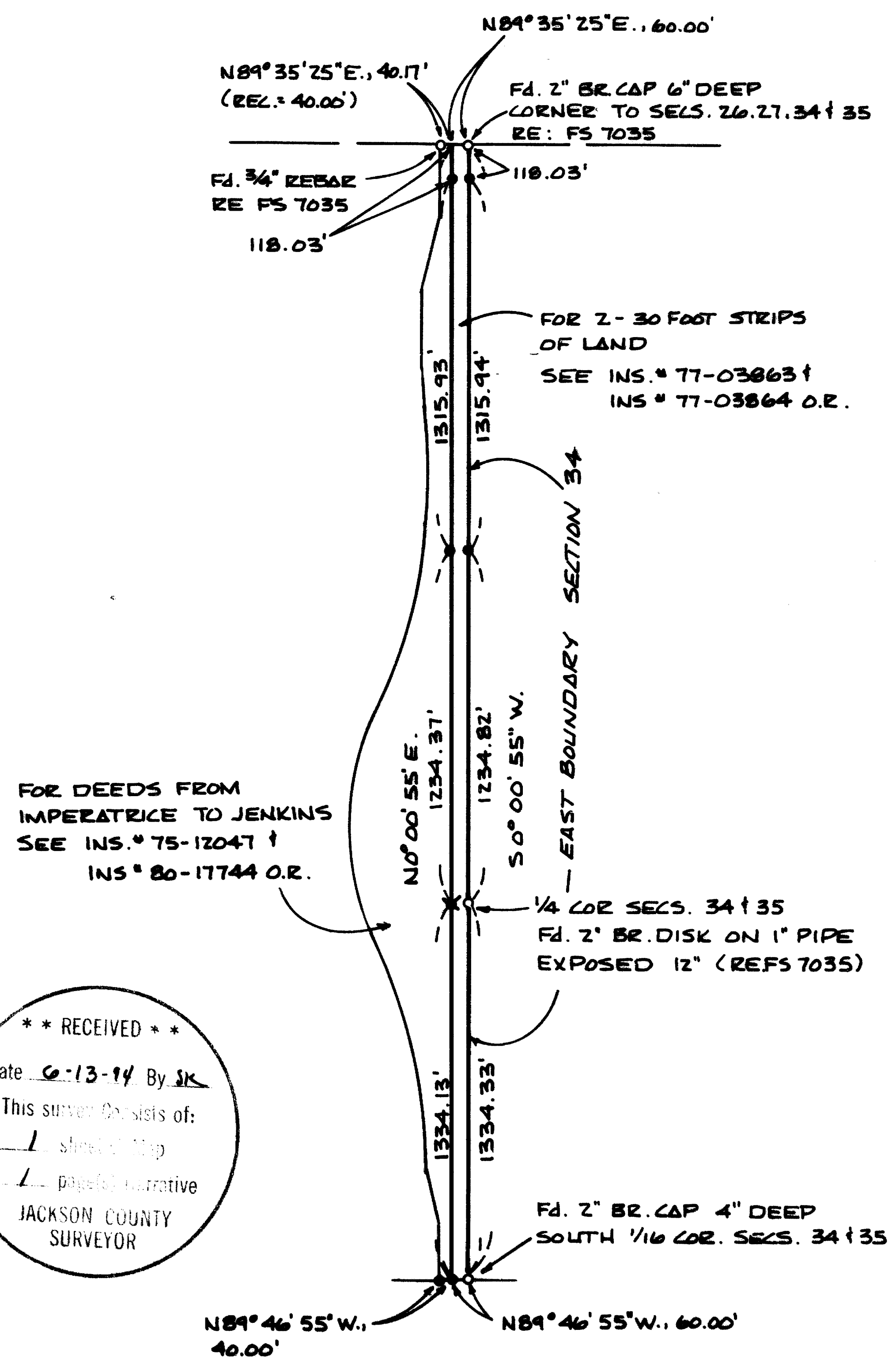
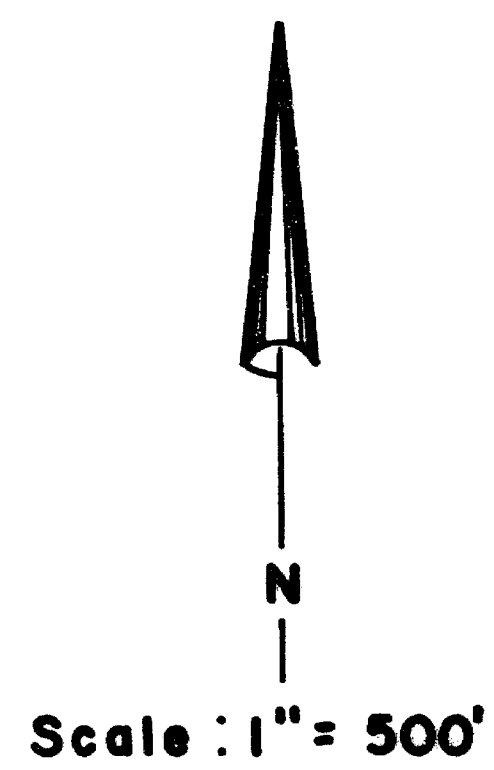

Survey for
Robert C. Jenkins
 83933 Cloud Nine Road
 Florence, Oregon
 97439

Location
 NE1/4 and the NE1/4 of the
 SE1/4 of Sec. 34, T.38S., R.1E., W.M.,
 Jackson County, Oregon

Survey by
Boyd Surveyors
 108 Mistletoe Street
 Medford, Oregon
 97501

Date
 June 10, 1994

Basis of Bearings
 Filed Survey No. 7035
 E. Bdry. Sec. 34 = Grid N1°30'35" E.
 -θ = 1°29'40" = True N0°00'55" E.

- Legend
- Found monument as indicated
 - Set 5/8" x 30" Rebar with red plastic cap marked "BOYDEN RLS 281"
 - ✱ Set 5/8" x 24" Rebar with red plastic cap marked "BOYDEN RLS 281" in mound of stone

REGISTERED
 PROFESSIONAL
 LAND SURVEYOR

Mark E. Boyden

OREGON
 NOV. 9, 1981
 MARK E. BOYDEN
 281
 Expires: 12/31/95.

** RECEIVED **

Date: 6-13-94 By: JK

This survey consists of:

- 1 sheet of map
- 1 physical narrative

JACKSON COUNTY
 SURVEYOR

381E.-34TL.103

14051

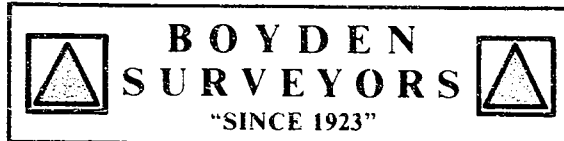

MARK E. BOYDEN
R.P.L.S. ORE. 281

108 MISTLETOE ST., MEDFORD, OREGON 97501
PHONE (503) 773-6000

SURVEY NO. 14051

SURVEY NARRATIVE TO COMPLY WITH O.R.S. 209.250

SURVEY FOR: ROBERT C. JENKINS
83933 CLOUD NINE ROAD
FLORENCE, OR 97439

SURVEY BY: BOYDEN SURVEYORS
108 MISTLETOE STREET
MEDFORD, OREGON 97501

LOCATION: NE ¼ AND NE ¼ OF THE SE ¼ OF SECTION
34, TOWNSHIP 38 SOUTH, RANGE 1 EAST,
W.M., JACKSON COUNTY, OREGON.

BASIS OF BEARINGS: EAST BOUNDARY OF SECTION 34
GRID BEARING = N. 1° 30' 35" E., -
θ = 1° 29' 40" = TRUE BEARING =
N. 0° 00' 55" E.

DATE: JUNE 10, 1994

PURPOSE: To monument a line 60 feet West from
the East boundary of said Section 34.
Also set a monument 100 feet West of the South one-
sixteenth corner common to Section 34 & 35,
T. 38 S., R. 1 E., W.M.

PROCEDURE: Found section line control corners as set on
Filed Survey NO. 7035.

Set monuments 60 feet West of said section line at
positions shown.

It should be noted that the monuments set 60 feet and
100 feet West from the South one-sixteenth corner between
Sections 34 and 35 were set near the existing "East-West"
fence line and were not intended to be on the true South
boundary of the NE ¼ of the SE ¼ of said Section 34.

