

72/1

Survey For
STATE GAME COMMISSION
Located in Secs. 19 & 30,
T. 36 S., R. 1 W., W.M.
By: Mark E. Boyden
March, 1960

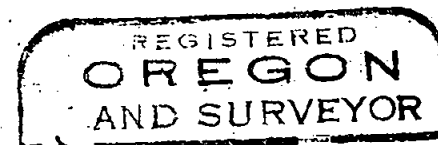
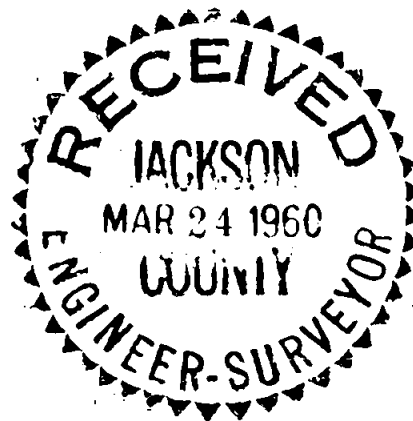
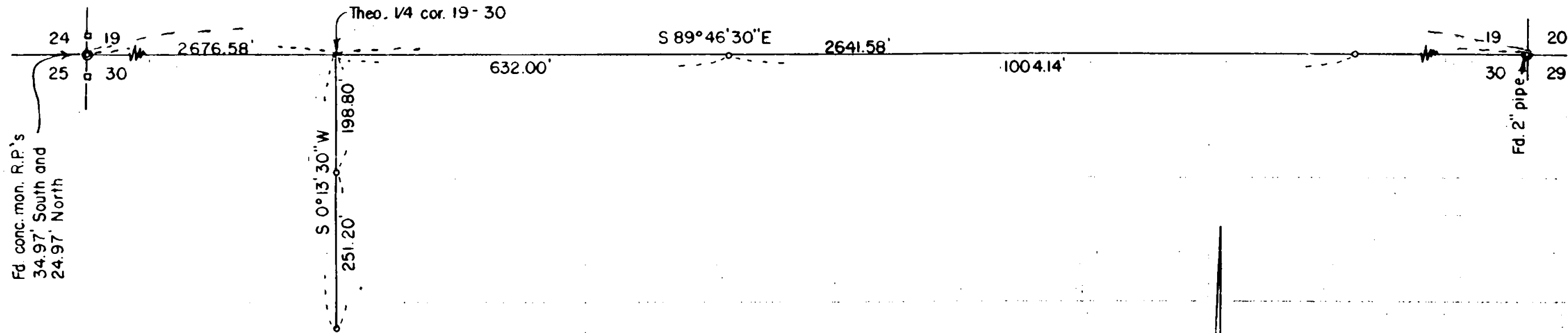

Mark E. Boyden
NOVEMBER 21, 51
MARK E. BOYDEN
281

SCALE: 1" = 200'
◦ Set 5/8" iron pin



1402

Survey Narrative to Comply with Paragraph 209.250,
Oregon Revised Statutes

FOR: State Game Commission

PURPOSE: To locate the $\frac{1}{4}$ corner common to Sections
19 and 30, Township 36 South, Range 1 West
and set iron pins, for line control only,
along said Section line as shown.

PROCEDURE:

Set up a 450' parallel offset Southerly from
said Section line and measured the overall distance,
turning the angles at the East and West ends of said
offset line. From this basic information, calculated
the position for said $\frac{1}{4}$ corner, setting $\frac{5}{8}$ " iron pins
as shown.

March 1960

