

**MAP OF SURVEY**  
 Located in the SW 1/4 of the SW 1/4 of Sec. 15,  
 T. 35 S., R 1 W., W.M Jackson County, Oregon.

SURVEY FOR:  
 Dan E. Bunn  
 P.O. Box 1084  
 Medford, OR 97501

SURVEY BY:  
 L.J. Friar & Associates, P.C.  
 Consulting Land Surveyors  
 304 South Holly Street  
 Medford, Oregon 97501  
 Phone: (503) 772-2782

- LEGEND:
- ⊙ - Found County Surveyor's brass capped monument & accessories.
  - - Found 5/8" iron pin w/ plastic cap mkd. L.J.FRIAR & ASSOC. per HIGHLAND HEIGHTS SUBDIVISION. Survey in progress.
  - - Found 5/8" iron pin per State Highway right-of-way.
  - ⊙ - Found 5/8" iron pin per RS 2896.
  - - Set 5/8" x 24" iron pin w/ plastic cap mkd. L.J.FRIAR & ASSOC.
  - ( ) - Record data per Deed & RS 2896.
- RS - Recorded Survey #.

BASIS OF BEARINGS: West line Section 15 per RS 12633.

DATE: January 28, 1994

SCALE: 1" = 100'

SURVEY NARRATIVE TO COMPLY WITH O.R.S. 209.250

PURPOSE: To survey and monument the boundary lines of the subject tract, to locate 3 wells and power pole and prepare legals for a water line and power easement to be granted to the adjoining property to the North.

PROCEDURE: Tied in pins set by RS 2896 into control established by this during the monumentation of HIGHLAND HEIGHTS SUBDIVISION, said Subdivision not yet recorded. Held deed angles and distances per Doc.#94-00366, to calculate the position of the subject tract's corners. Intersected the highway right-of-way and set 5/8" pin as shown. Tied in the 3 wells and the power pole as shown. These monuments found as well as those set are as shown hereon.

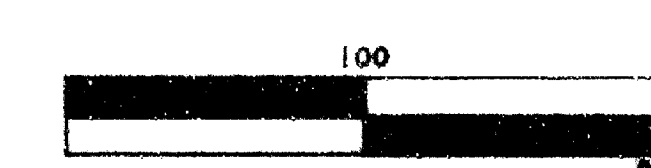

\*\* RECEIVED \*\*  
 Date 2-11-94 By JEF  
 This survey consists of:  
 sheets) Map  
 pages) Narrative  
 JACKSON COUNTY  
 SURVEYOR

REGISTERED  
 PROFESSIONAL  
 LAND SURVEYOR  
 James E. Friar  
 OREGON  
 JULY 17, 1986  
 JAMES E. FRIAR  
 2294  
 EXPIRES 6-30-96

351W15 TL1700

# Edwards Surveying & Land Planning Inc.

REL W. EDWARDS  
OREGON REG. 741  
ZONA REG. 9746



DAVID A. EDWARDS  
OREGON REG. 2339

REGISTERED LAND SURVEYORS  
823 WEST 8TH ST.  
MEDFORD, OREGON 97501  
(503) 776-2313 • (503) 471-7059

SURVEY NUMBER 13757

SURVEY NARRATIVE TO COMPLY WITH CHAPTER 209, PARAGRAPH 250,  
OREGON REVISED STATUTES

SURVEY FOR: Ed Harris  
3609 South Pacific Hwy.  
Medford, Oregon 97501

LOCATION: In the SW 1/4 of Section 15, T. 34 S.,  
R. 1 W., W.M., City of Shady Cove in Jackson  
County, Oregon.

PURPOSE: Land Partition; City of Shady Cove File No.  
MIP 93-10: To locate and monument the  
boundaries of Parcels 1 and 2 as shown on the  
accompanying plat and to prepare and record  
said plat for the purpose of creating said  
Parcels.

PROCEDURE: Utilizing for control the found monuments per  
Surveys Numbered 11799, 11868 and 13506 as well  
as data found in Document No. 90-00780,  
Official Records, computed the positions for  
the new corners. This office previously  
surveyed the outside boundary of the tract,  
having set witness monuments near the southerly  
line of Indian Creek Road. The road was now  
located and new monuments set for the corners  
as shown. The pin found near the Northwest  
corner of the tract, having been set by this  
office on S.N. 11799, has obviously been  
tampered with. The plastic cap is driven down  
over the top of the pin in the fashion that one  
would expect if a pin were knocked out and then  
driven into the ground with the cap on.  
Monuments set on this survey consist of 5/8" x  
30" steel pins with red plastic caps mkd. "D.A.  
EDWARDS-LS 2339".

BASIS OF BEARINGS: Station "MS-3" to "MS-4" with grid bearings  
decreased in azimuth by 1° 35' 00".

EQUIPMENT: Nikon DTM-10LG Electronic Total Station.

DATE COMPLETED: November 5, 1993

\*\* RECEIVED \*\*  
Date 12-13-93 By BE  
This survey consists of:  
1 sheet(s) Map  
1 page(s) Narrative  
JACKSON COUNTY  
SURVEYOR

REGISTERED  
PROFESSIONAL  
LAND SURVEYOR  
*David A. Edwards*  
OREGON  
JULY 26, 1988  
DAVID A. EDWARDS  
2339  
Expires 12/31/93

# Edwards Surveying & Land Planning Inc.

DARREL W. EDWARDS  
OREGON REG. 741  
ARIZONA REG. 9746



DAVID A. EDWARDS  
OREGON REG. 2339

REGISTERED LAND SURVEYORS  
823 WEST 8TH ST.  
MEDFORD, OREGON 97501  
(503) 776-2313 • (503) 471-7059

SURVEY NUMBER 13757

SURVEY NARRATIVE TO COMPLY WITH CHAPTER 209, PARAGRAPH 250,  
OREGON REVISED STATUTES

SURVEY FOR: Ed Harris  
3609 South Pacific Hwy.  
Medford, Oregon 97501

LOCATION: In the SW 1/4 of Section 15, T. 34 S.,  
R. 1 W., W.M., City of Shady Cove in Jackson  
County, Oregon.

PURPOSE: Land Partition; City of Shady Cove File No.  
MIP 93-10: To locate and monument the  
boundaries of Parcels 1 and 2 as shown on the  
accompanying plat and to prepare and record  
said plat for the purpose of creating said  
Parcels.

PROCEDURE: Utilizing for control the found monuments per  
Surveys Numbered 11799, 11868 and 13506 as well  
as data found in Document No. 90-00780,  
Official Records, computed the positions for  
the new corners. This office previously  
surveyed the outside boundary of the tract,  
having set witness monuments near the southerly  
line of Indian Creek Road. The road was now  
located and new monuments set for the corners  
as shown. The pin found near the Northwest  
corner of the tract, having been set by this  
office on S.N. 11799, has obviously been  
tampered with. The plastic cap is driven down  
over the top of the pin in the fashion that one  
would expect if a pin were knocked out and then  
driven into the ground with the cap on.  
Monuments set on this survey consist of 5/8" x  
30" steel pins with red plastic caps mkd. "D.A.  
EDWARDS-LS 2339".

BASIS OF  
BEARINGS: Station "MS-3" to "MS-4" with grid bearings  
decreased in azimuth by 1° 35' 00".

EQUIPMENT: Nikon DTM-10LG Electronic Total Station.

DATE  
COMPLETED: November 5, 1993

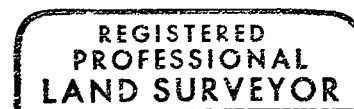
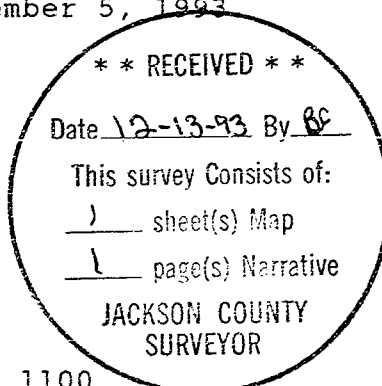

*David A. Edwards*



*Expires 12/31/97*