

Survey for Mr. W. Morrill.  
55 Mace Road  
Medford, Oregon.

Date of Survey February 13, 1960.

Purpose to stake the north 75 feet of the south 175.25 feet of Lot 5 Block 2 Valley Center Subdivision, in the City of Medford, Jackson County, Oregon.

REGISTERED  
OREGON  
LAND SURVEYOR

*L. N. Dow*

MAY 8, 1949  
L. N. DOW  
251

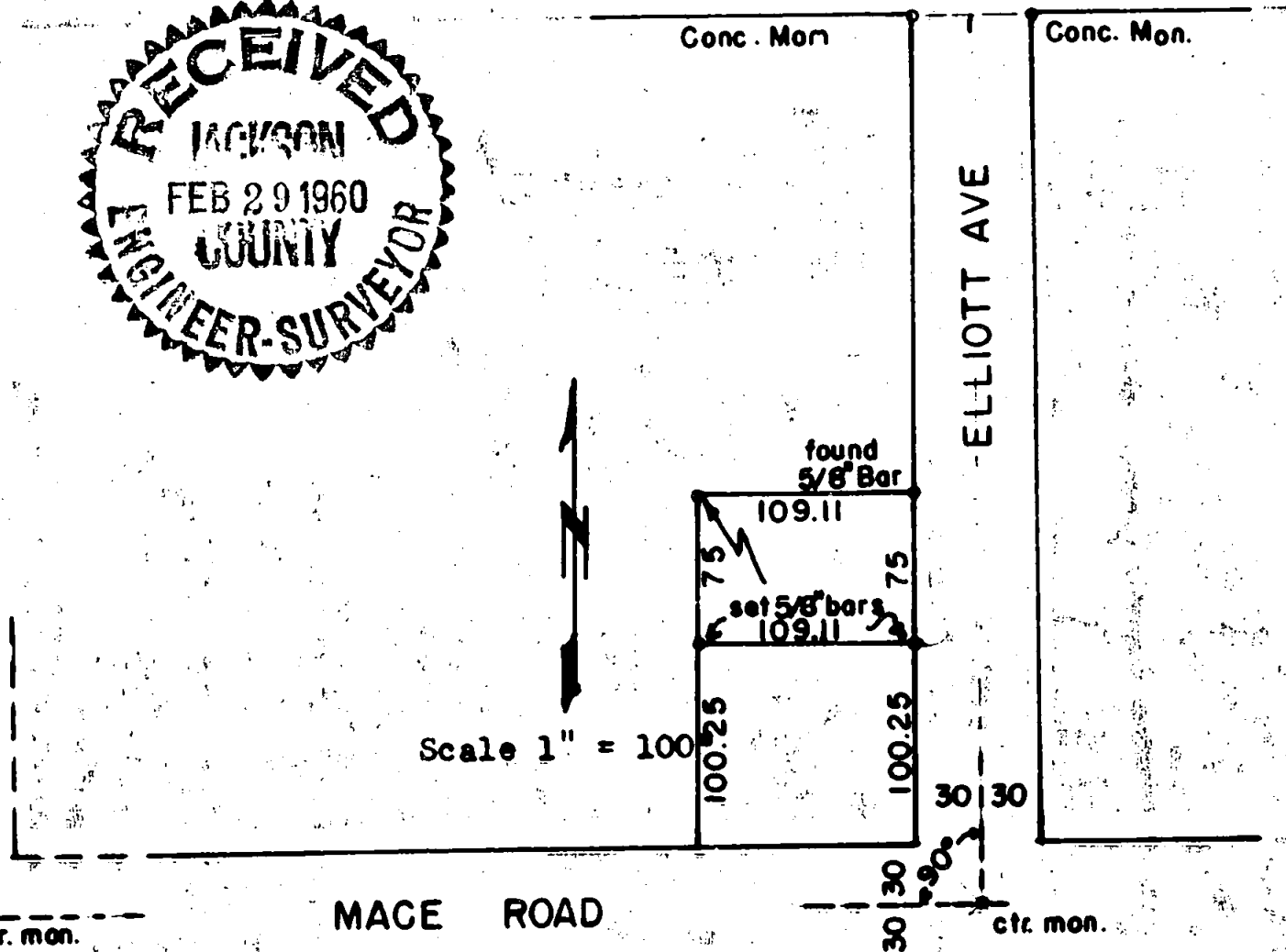
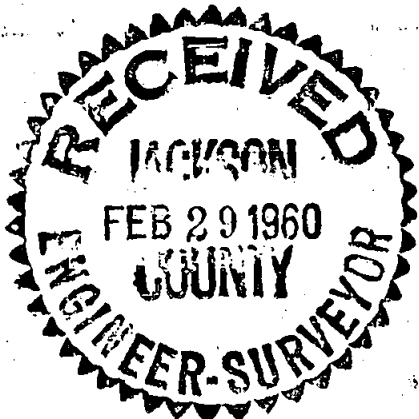

Written narrative to accompany plat for Survey NO.

Date of Survey February 13, 1960.

Located in Valley Center Subdivision, Medford, Oregon.

Purpose to stake out the North 75 feet of the South 175.25 feet of Lot 5 Block 2 Valley Center Subdivision.

Procedure: having the street center monuments located on Mace Avenue as shown, and the concrete monument on Elliott avenue at the north line of the Subdivision, I turned the angle for orientation and then staked the lot as shown on the plat.



*L. N. Dow*

