

MAP OF SURVEY

OF
 EXISTING MONUMENTS ON STEWART AVENUE
 BETWEEN PLUM STREET AND MYERS LANE
 LOCATED IN
 SECTION 31, T.37S. R.1W. AND SECTION 36,
 T.37S. R.2W. W.M.
 CITY OF MEDFORD, JACKSON COUNTY, OREGON

SURVEY BY:
 CITY OF MEDFORD
 SURVEY DIVISION
 411 WEST EIGHTH STREET
 MEDFORD, OREGON 97501

JULY 1990 TO SEPTEMBER 1992

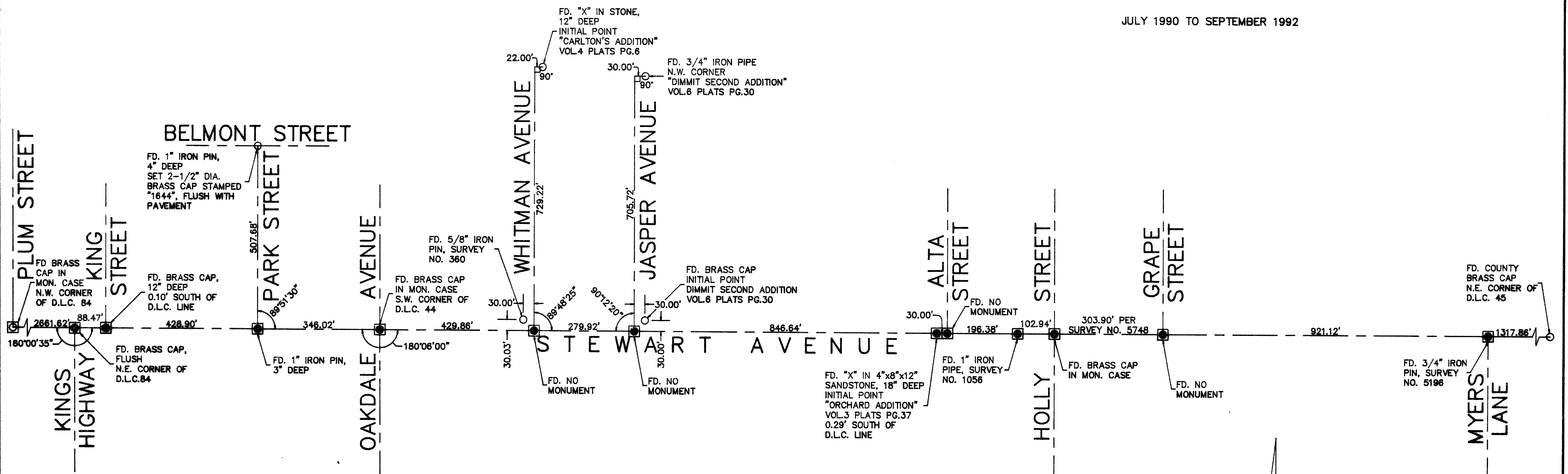

LEGEND

- FOUND MONUMENT AS NOTED
- FOUND MONUMENT AS NOTED, REPLACED WITH 2" PIPE AND 2-1/2" DIA. BRASS DISC STAMPED "1644" IN METAL MONUMENT CASE, FLUSH WITH PAVEMENT ON THE D.L.C. LINE.

SCALE: 1" = 200'

REGISTERED
 PROFESSIONAL
 LAND SURVEYOR

PAUL D. LEWIS
 JULY 4, 1978
 1644

EXPIRES 12-31-94

**** RECEIVED ****
 Date 4-1-93 By PL
 This survey consists of:
 1 sheet(s) Map
 1 page(s) Narrative
 JACKSON COUNTY
 SURVEYOR

SURVEY NO. 13437

SURVEY NARRATIVE TO COMPLY WITH O.R.S. 209.250

SURVEY FOR: CITY OF MEDFORD
411 W. 8TH STREET
MEDFORD, OR 97501

LOCATION: SECTION 31, TOWNSHIP 37 SOUTH, RANGE 1 WEST, AND
SECTION 36, TOWNSHIP 37 SOUTH, RANGE 2 WEST,
WILLAMETTE MERIDIAN, CITY OF MEDFORD, JACKSON
COUNTY, OREGON.

PURPOSE: TO PERPETUATE EXISTING CENTERLINE MONUMENTATION
ALONG STEWART AVE. FROM KINGS HIGHWAY TO MYERS
LANE, ALSO TO ESTABLISH MISSING CENTERLINE
MONUMENTS AT VARIOUS STREETS AS SHOWN ON THE
ACCOMPANYING MAP.

PROCEDURE: THE EXISTING MONUMENTS ALONG THE CENTERLINE OF
STEWART AVE. WERE TIED BY A FIELD TRAVERSE AND
THUS REFERENCED. SEE CITY FIELD BOOKS #1612,
1595, 1540, 1646, AND 1616. AFTER THE
RECONSTRUCTION OF STEWART AVE. MONUMENTS WERE SET
AS SHOWN ON THE ACCOMPANYING MAP. THE FOLLOWING
STREET CENTERS WERE NOT FOUND:

1. WHITMAN AVE. - CENTERLINE WAS ESTABLISHED
PER THE PROCEDURE ON FILED SURVEY #4770.
2. JASPER AVE. - CENTERLINE WAS ESTABLISHED
30.00 FEET WEST OF THE MONUMENTED WEST LINE
OF "DIMMIT SECOND ADDITION".
3. ALTA ST. - CENTERLINE WAS ESTABLISHED 30.00
FEET EAST OF THE INITIAL POINT OF "ORCHARD
ADDITION".
4. GRAPE ST. - CENTERLINE WAS ESTABLISHED
RECORD DISTANCE (303.90 FEET) EAST OF THE
CENTERLINE MONUMENT AT HOLLY PER FILED
SURVEY #5748.

SURVEY BY: CITY OF MEDFORD
SURVEY DIVISION
411 W. 8TH STREET
MEDFORD, OR 97501

DATE: JULY 1990 TO SEPTEMBER 1992

