

LEGEND

- FD. BRASS CAP PER JACKSON COUNTY REESTABLISHMENT BOOK, PG. 71
- FD. BRASS CAP PER JACKSON COUNTY REESTABLISHMENT BOOK, PG. 22
- ⊙ FD. BRASS CAP PER JACKSON COUNTY REESTABLISHMENT BOOK, PG. 68
- ⊕ FD. BRASS CAP PER JACKSON COUNTY REESTABLISHMENT BOOK, PG. 112
- FD. BRASS CAP PER JACKSON COUNTY REESTABLISHMENT BOOK, PG. 85
- SET 5/8" X 30" REBAR WITH YELLOW PLASTIC CAP MARKED " TEMPLIN LS2359 "
- △ CALCULATED POSITION
- () RECORD BEARING/DISTNCE PER R.S. 9204

BEARINGS BASED UPON RS 9204

** NARRATIVE IS SEPARATE DOCUMENT **

36 - 2W - 25B TL 2200

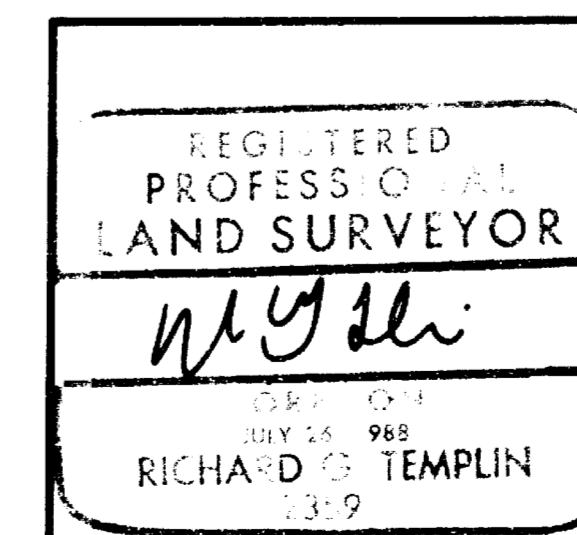
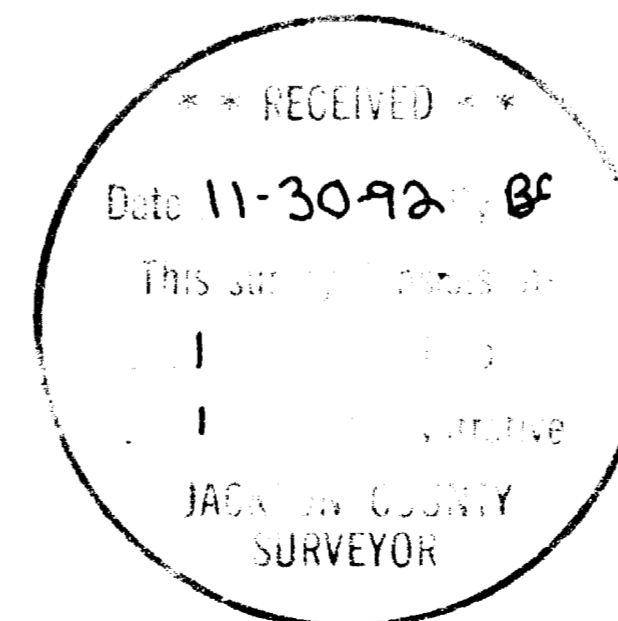

RICHARD TEMPLIN LAND SURVEYING
 2042 SANDRA PL 776-0991 & 474-7720 MEDFORD, OREGON

MAP OF SURVEY
 LOCATED IN
 SE1/2 OF THE SE1/4 OF THE SE1/4 OF THE NW1/4
 OF SECTION 25, T.36S., R.2W., W.M.
 JACKSON COUNTY, OREGON

SURVEYED FOR: MR. H. D. LOONEY 2221 CRESTON CT. MEDFORD, OREGON 97504
 DATE: NOV. 2, 1992

RICHARD G. TEMPLIN
PROFESSIONAL LAND SURVEYOR
2042 Sandra Pl.
Medford, Oregon 97504
(503) 776-0991 • 474-7720

NARRATIVE

Survey No. **13264**

SURVEY FOR: Mr. H.D. Looney
2221 Creston Ct.
Medford, Oregon 97504

LOCATION: SE 1/2 of the SE 1/4 of the SE 1/4 of the NW 1/4
of Section 25, Township 36 South, Range 2 West,
of the Willamette Meridian, Jackson County,
Oregon.

PURPOSE: To survey and the mark the Deed corners of O.R.
92-23665 of the Official Records, Jackson County,
Oregon.

DATE: November 2, 1992

BASIS OF Bearings based upon R.S. 9204; the North-South
centerline of Section 25.

PROCEDURE: Tied the NW corner of Section 25, N 1/4, E 1/4,
S 1/4 and the W 1/4 of said Section 25. A 5/8"
iron rod was set for the Center 1/4 of Section 25
per R.S. 9204, but was not found on this survey.
I calculated the position of said C 1/4 and then
subdivided the NW 1/4 to establish the NE corner
of the S 1/2 of the S 1/2 of the SE 1/4 of the NW
1/4. I then computed the Deed corners of O.R. 92-
23665 and set as shown.

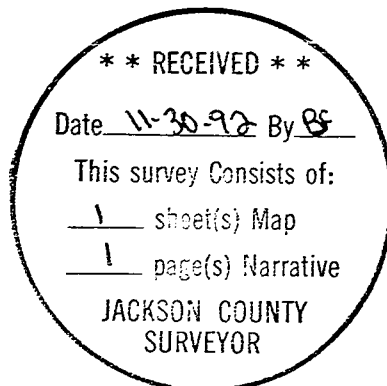

MSL

