

LEGEND

- SET 5/8" X 30" REBAR WITH YELLOW PLASTIC CAP MARKED "TEMPLIN LS2359"
- FD. 5/8" IRON ROD WITH YELLOW PLASTIC CAP UNREADABLE, PER RS 11004 WHICH BEARS N 59° 48' 19" E 0.22' FROM DEED CORNER
- ⊙ FD. BRASS CAP MONUMENT, SSE CORNER D.L.C. 40, PER JACKSON COUNTY REESTABLISHMENT BOOK
- ⊠ FD. BRASS CAP WITNESS MONUMENT TO SW CORNER D.L.C. 40, PER JACKSON COUNTY REESTABLISHMENT BOOK, PG. 51
- △ CALCULATED POSITION
- [] RECORD BEARING/DISTANCE PER RS 11004
- *— INDICATES EXISTING FENCE

BEARINGS BASED UPON RS 11004

** NARRATIVE IS SEPARATE DOCUMENT **

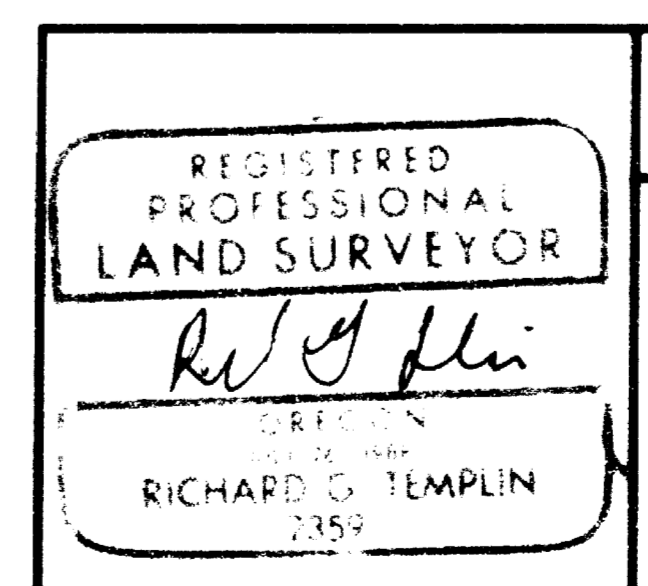
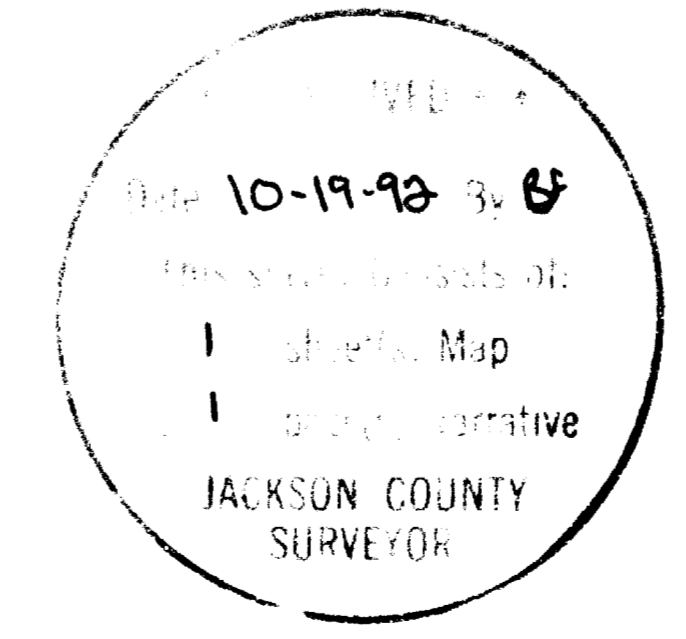

RICHARD TEMPLIN LAND SURVEYING
 2042 SANDRA PL 776-0991 & 474-7720 MEDFORD, OREGON

MAP OF SURVEY
 LOCATED IN
 LOT 1 OF RIVERDALE TRACTS SUBDIVISION
 W 1/2 OF SECTION 21, T.36S., R.4W., W.M.
 JACKSON COUNTY, OREGON

SURVEYED FOR: SHERM HEATER REALTORS DATE: OCT. 5, 1992
 707 NE 7TH ST.
 GRANTS PASS, OREGON 97528

RICHARD G. TEMPLIN
PROFESSIONAL LAND SURVEYOR

2042 Sandra Pl.
Medford, Oregon 97504
(503) 776-0991 • 474-7720

NARRATIVE

Survey No. 13204

SURVEY FOR: Sherm Heater Realtors
707 NE 7th Street
Grants Pass, Oregon 97526

LOCATION: A portion of Lot 1, of "RIVERDALE TRACTS
SUBDIVISION", in the W 1/2 of Section 21,
Township 36 South, Range 4 West, of the
Willamette Meridian, Jackson County, Oregon.

PURPOSE: To survey and the mark deed corners of O.R. 88-
09455 and the West line of O.R. 90-22262, of the
Official Deed Records of Jackson County, Oregon.

DATE: October 5, 1992

BASIS OF BEARING: Bearings based upon R.S. 11004, as
shown.

PROCEDURE: Located and tied the SSE corner of D.L.C. # 40,
the Witness corner to the SW corner of D.L.C. #
40 and monuments set on R.S. 11004. The SW corner
of Lot 1, "RIVERDALE TRACTS SUBDIVISION " was
reported found on R.S. # 4435. Since then said SW
corner has been destroyed. Holding the calculated
position of said SW corner, according to RS 4435,
I went Deed distances along the South line of DLC
40 to the calculated deed corner positions. I
then held the Deed call of North 38°30'00" West,
from said Deed corners of O.R. 88-09455 and
intersected the North right of way line of Rogue
River Highway. The North right of way was
established by pulling 30.00 feet from the
physical centerline. I then projected the East
and West lines of O.R. 88-09455 to a bearing
intersection from the said calculated SW corner
of Lot 1, setting the NE and NW Deed corner of
said O.R. 88-09455. The West line of line of O.R.
90-22262 was established by the same procedure,
setting the SW and NW Deed corners.

** RECEIVED **

Date 10-19-92 By BT

This survey Consists of:

1 sheet(s) Map

1 page(s) Narrative

JACKSON COUNTY
SURVEYOR

REGISTERED
PROFESSIONAL
LAND SURVEYOR

M G L

OREGON
JULY 26, 1988
RICHARD G. TEMPLIN
2359