

**LEGEND**

- o = Found 5/8" iron pin
- ▲ = Record subdivision monument searched for, not found
- = Set 5/8"x24" iron pin with orange plastic cap marked "R ROBERTS LS 1656"
- PP = proportional measurement
- DR = Deed record
- wit mon = Witness monument

Basis of brg: VAWTER SUBDIVISION

Approved by the Jackson County Planning Department

By: Carol Parker Date: June 30, 1992

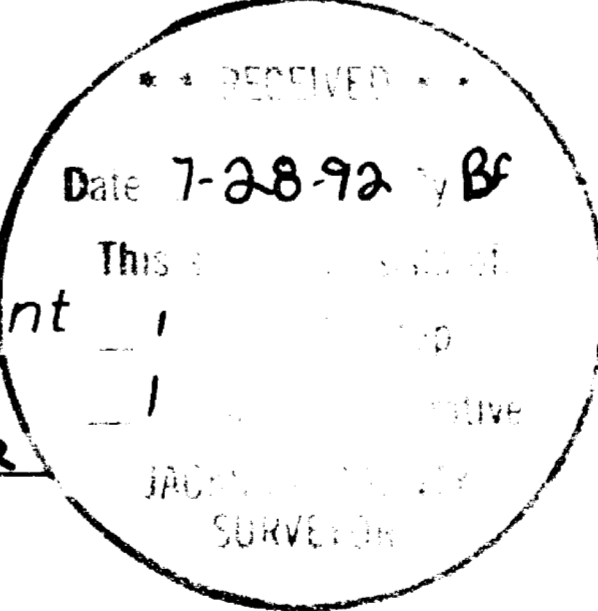

**LANDMARK SURVEYING**

205 West Ninth St.  
Medford, Oregon  
Tel 772-2071

(91-058)

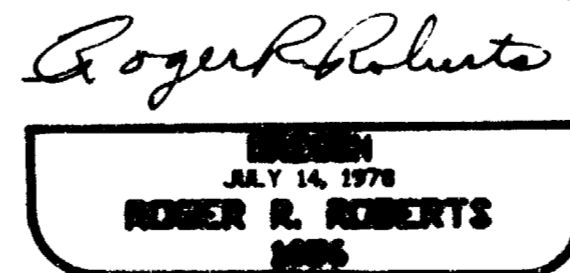
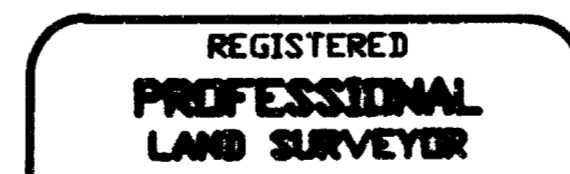

**PROPERTY LINE ADJUSTMENT**

located in  
LOT 1 of VAWTER SUBDIVISION  
Southwest 1/4 of Sec 1, T38S, R2W, WM.  
Jackson County, Oregon

for  
Ernest & Muriel Gallo and Gary & Barbara Hoque  
1389 South Stage Rd. 2745 Dark Hollow Rd.  
Medford, Oregon Medford, Oregon

June 25, 1992

SURVEY NO. 13089

SURVEY NARRATIVE TO COMPLY WITH PARAGRAPH 205.250  
OREGON REVISED STATUTES

SURVEY FOR: Ernest & Muriel Gallo Gary & Barbara Hoque  
1389 South Stage Road and 2745 Dark Hollow Road  
Medford, Oregon Medford, Oregon

LOCATION: VAWTER SUBDIVISION, in the southwest quarter of  
Section 1, in Township 38 South, Range 2 West, WM.,  
Jackson County, Oregon.

PURPOSE: Property line adjustment - monument a new common  
line between the adjoining parcels and prepare the  
necessary metes & bounds descriptions.

PROCEDURE: A search for monuments along the northerly boundary  
of VAWTER SUBDIVISION as shown on Surveys No. 1109,  
2285 and 4091 indicated that they may have been  
destroyed by utility installation along the  
southerly boundary of the right of way of South  
Stage Road. Also, a search for monuments along the  
southerly boundary of Surveys No. 4091 and 1109  
indicated that they may have been destroyed or  
buried by maintenance of the irrigation canal. The  
two monuments found as shown along the easterly  
side of Survey No. 2285 were used to protract the  
location of the subdivision boundaries. The  
resulting subdivision lines as shown on the map may  
be subject to revision upon recovery of additional  
control.

The present right of way boundary of Dark  
Hollow Road was determined from monumentation  
established on Survey No. 5966, by the Jackson  
County Department of Public Works. The acreages  
shown for the two tax lots were determined using  
this right of way boundary.

Basis of bearing: VAWTER SUBDIVISION bearing, using  
monumentation as established by Survey No.  
2285 along the easterly boundary of Lot 3.

Date: June 25, 1992

\*\* RECEIVED \*\*  
Date 7-28-92 By RR  
This survey consists of:  
1 sheet(s) Map  
1 page(s) Narrative  
JACKSON COUNTY  
SURVEYOR

REGISTERED  
PROFESSIONAL  
LAND SURVEYOR

*Roger R. Roberts*

OREGON  
JULY 14, 1978  
ROGER R. ROBERTS  
1656

Roger R. Roberts  
LANDMARK SURVEYING  
205 West Ninth Street  
Medford, Oregon 97501