

**EASEMENT DATA**

- ① S. 5° 37' 32" W., 8.96'
- ② West, 3.96'
- ③ S. 88° 30' E., 84.88'
- ④ N. 88° 30' W., 94.12'
- ⑤ North, 3.06'
- ⑥ S. 0° 15' 23" W., 5.03'

# PARTITION PLAT NO. P-41-1992

A MINOR LAND PARTITION located in the NE 1/4 of Section 25, T. 36 S., R. 3 W., W. M., Jackson County, Oregon.

March 25, 1992

SURVEY FOR: Billy & Joan Voss  
9975 Blackwell Road  
Central Point, Oregon

SURVEY BY: Edwards Surveying and Land Planning Inc.  
823 W. 8th Street  
Medford, Oregon 97501  
Phone: (503) 776-2313

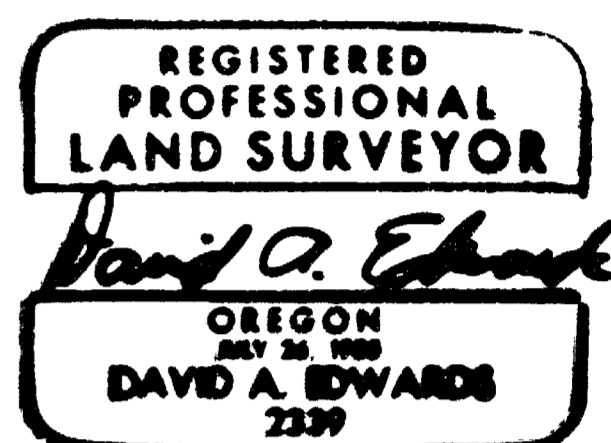

### SURVEYOR'S CERTIFICATE

I, David A. Edwards, a Registered Professional Land Surveyor of the State of Oregon, do hereby certify that I have correctly surveyed and marked with the proper monuments as provided by law, the tract of land as shown hereon and that this plat is a correct representation of said tract and that the following is an accurate description of the boundary lines:

Commencing at the Southwest corner of Lot 18, HAPPY HOLLOW SUBDIVISION in Jackson County, Oregon, according to the official plat thereof, now of record; thence North 0° 06' 35" East (record North), along the West line of said Lot, 265.13 feet to a 5/8 inch steel pin marking a point on the Northerly right of way line of Interstate Highway Number 5, said point being also the INITIAL POINT; thence continue North 0° 06' 35" East (record North), along said West line of Lot 18, 440.51 feet to a 5/8 inch steel pin, said pin being on the South line of Blackwell Road; thence along said South line, along the arc of a 2894.79 foot radius curve to the left, being concave to the North and having a long chord which bears South 85° 35' 49" East 304.417 feet, a distance of 304.558 feet to a 5/8 inch steel pin; thence leaving said South line South 0° 32' 22" West 336.16 feet to a 5/8 inch steel pin; thence West 17.79 feet to a 5/8 inch steel pin; thence South 0° 06' 18" West 179.11 feet to a 5/8 inch steel pin marking a point on said Northerly right of way line of Interstate Highway Number 5; thence North 70° 53' 00" West 299.61 feet to the INITIAL POINT.

I certify this plat to be an exact photocopy of the original.

David J. Edwards  
Surveyor

### DECLARATION

KNOW ALL MEN BY THESE PRESENTS, that we, Billy R. Voss, Joan L. Voss, Derwin F. Voss, Lois Voss and Marie Louise Talbitzer are the owners in fee simple of the lands designated hereon as Parcels 1 and 2 and being more particularly described in the "Surveyor's Certificate" and that we have caused the partitioning as shown hereon. We do hereby create the mutual access, overhead utility, well access, underground power and water line, and 10 foot square well easements as shown hereon.

There are no water rights appurtenant to this property.

IN WITNESS WHEREOF, we have set our hands and seals this 3rd day of April, 1992.

Billy R. Voss Billy R. Voss      Joan L. Voss Joan L. Voss      Derwin F. Voss Derwin F. Voss      Lois Voss Lois Voss

STATE OF OREGON) County of Jackson ) SS April 3 A.D. 1992 Before me:

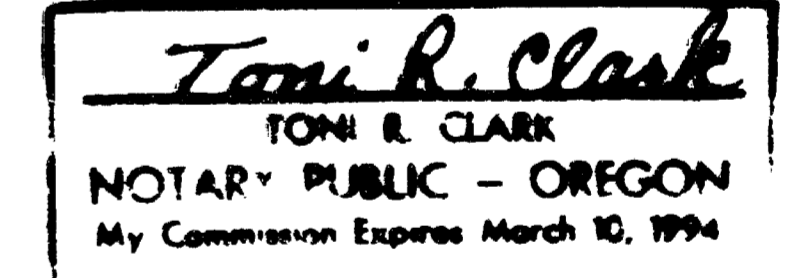

Personally appeared before me the above named Billy R. Voss and Joan L. Voss and Derwin F. Voss and Lois Voss and acknowledged the foregoing instrument to be their voluntary act and deed.

Marie Louise Talbitzer Marie Louise Talbitzer

STATE OF CALIFORNIA) County of Butte ) SS April 14 A.D. 1992 Before me:

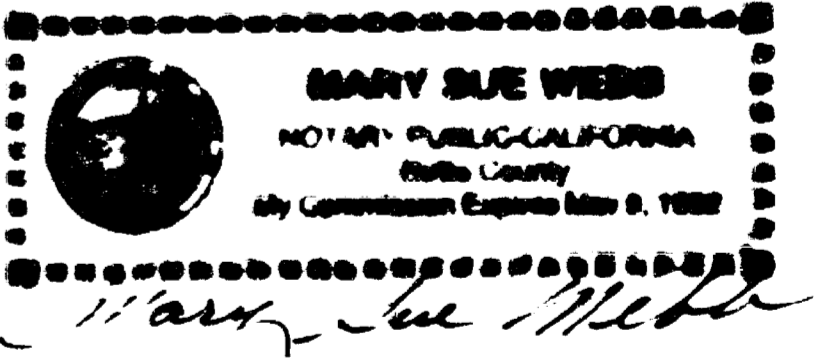

Personally appeared before me the above named Marie Louise Talbitzer and acknowledged the foregoing instrument to be her voluntary act and deed.

APPROVALS 92-03-MP Approved by the Jackson County Department of Planning and Development. By [Signature] Date: April 15, 1992

EXAMINED and approved this 15 day of April, 1992. [Signature] Jackson County Surveyor

### RECORDER'S CERTIFICATE

Filed for record this 16 day of April, 1992, at 2:30 o'clock, P. M. and recorded as Partition Plat No. P-41-1992 of the records of partition plats of Jackson County, Oregon. Index Volume 3 Page 41 County Surveyor File No. 12941

Kathleen S. Bickett County Clerk      Glenda E. Bickett Deputy

- LEGEND**
- Indicates 5/8" diam. Steel Pin w/ plastic cap fd. per R.S.N. 12924 unless noted otherwise.
  - Indicates 5/8" x 24" Steel Pin w/ plastic cap mtd. "D.A. EDWARDS-LS 2339" set unless noted otherwise.
  - ( ) Denotes Record Data per R.S.N. 7972 except where noted.
  - R.S.N. = Recorded Survey Number      x—x—x Fence Line      — Utility Pole
- SCALE: 1" = 60'      BASIS OF BEARING: R.S.N. 12924 as shown hereon.

RECEIVED  
Date 4-16-92 By [Signature]  
This survey consists of:  
1 sheet(s) Map  
1 page(s) Narrative  
JACKSON COUNTY SURVEYOR

# Edwards Surveying & Land Planning Inc.

DARREL W. EDWARDS  
OREGON REG. 741  
ARIZONA REG. 9746



DAVID A. EDWARDS  
OREGON REG. 2339

REGISTERED LAND SURVEYORS  
823 WEST 8TH ST.  
MEDFORD, OREGON 97501  
(503) 776-2313 • (503) 471-7059

SURVEY NUMBER 12941

SURVEY NARRATIVE TO COMPLY WITH CHAPTER 209, PARAGRAPH 250,  
OREGON REVISED STATUTES

**SURVEY FOR:** Billy and Joan Voss  
9975 Blackwell Road  
Central Point, Oregon 97502

**LOCATION:** In the NE 1/4, Sec. 25, T. 36 S. R. 3 W., W.M.,  
Jackson County, Oregon.

**PURPOSE:** Minor land Partition: Planning Dept. file No.  
92-03-MP; To locate and monument a new boundary  
between Parcels 1 and 2, as shown on the  
accompanying plat, to create certain easements  
and to create said Parcels by the recording of  
said plat.

**PROCEDURE:** Utilizing existing control points and data  
established by this office during the execution  
of Recorded Survey Number 12924, computed and  
monumented the new boundary as shown. Document  
Number 92-08704 contains a legal description  
prepared by myself for the purpose of a  
boundary line adjustment. This document created  
the parent tract in the configuration shown.  
Monuments set on this survey consist of 5/8" x  
24" or 30" steel pins with red plastic caps  
mkd. "D.A.EDWARDS-LS 2339".

**BASIS OF  
BEARINGS:** East line per R.S.N. 12924 as shown.

**EQUIPMENT:** Nikon NTD-4 Semi-automatic theodolite/E.D.M.

**DATE  
COMPLETED:** March 25, 1992

