

Survey for :

Janet N. Miller  
120 Stanford Ave.  
Medford, Oregon 97504

Location

Lots 2+3 Block 1 of HILLCREST HEIGHTS (Recorded) in D.L.C.# 62, SW 1/4 of Sec. 22, T.37S., R.1W., W.M. Medford, Oregon

Survey by :

Boyd Surveyors  
108 Mistletoe St.  
Medford, Oregon 97501

Legend

- Found 5/8" Iron pin unless otherwise indicated
- ⊙ Found Br. Disk in monument case
- Set 5/8"x 24" Rebar with red plastic cap marked "BOYDEN RLS 281"

Basis of Bearings

F.S. # 9158

Date

April 6, 1992

Scale : 1" = 50'

\*\* RECEIVED \*\*  
Date 4-7-92 By BF  
This survey consists of:  
— sheet(s) Map  
— page(s) Narrative  
JACKSON COUNTY SURVEYOR

REGISTERED PROFESSIONAL LAND SURVEYOR  
*Mark E. Boyden*  
OREGON NOV. 9, 1957  
MARK E. BOYDEN 281

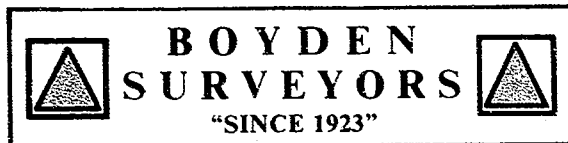

MARK E. BOYDEN  
R.P.L.S. ORE. 281

108 MISTLETOE ST., MEDFORD, OREGON 97501  
PHONE (503) 773-6000

SURVEY NO. 12936

SURVEY NARRATIVE TO COMPLY WITH O.R.S. 209.250

SURVEY FOR: JANET N. MILLER  
120 STANFORD AVENUE  
MEDFORD, OR 97504

SURVEY BY: BOYDEN SURVEYORS  
108 MISTLETOE STREET  
MEDFORD, OR 97501

LOCATION; Lots 2 & 3, HILLCREST HEIGHTS  
(Recorded) in D.L.C. No. 62  
in the SW 1/4 of Section  
22, T. 37 S., R. 1 W., W.M., City of  
Medford, Oregon.

BASIS OF BEARINGS: FILED SURVEY NO. 9158

DATE: APRIL 6, 1992

PURPOSE: To monument the Westerly boundary of  
tract described in Instrument NO.  
88-02082, Official Records.

PROCEDURE: In late 1987, a preliminary survey  
was made for Mrs. Miller, enclosing the outside boundaries of  
Block 1 of HILLCREST HEIGHTS (Recorded). Ties were made to  
monuments set on said HILLCREST HEIGHTS, BEL AIR HEIGHTS and  
centerline monuments set by the City of Medford for Hillcrest  
Road.

From said data, and with the approval of the Medford  
Planning staff, the original lot lines were adjusted and  
deeds recorded (See Ins. # 88-02080 to 88-02082, Official  
Records).

Having recently sold "Adjusted Lot 3", the Westerly  
boundary was requested to be monumented.

From our previous data from the 1987 survey and Filed  
Survey No. 11178, monumented said boundary as described and  
as shown on the map to accompany this report.

