

SURVEY NO. 12801

SURVEY NARRATIVE TO COMPLY WITH PARAGRAPH 209.250
OREGON REVISED STATUTES

SURVEY FOR: Buster Norton
P.O. Box 558
Mammoth Lakes, California 93546

LOCATION: In the Northwest one-quarter of Section 15,
Township 38 South, Range 1 West, Willamette
Meridian, in the City of Phoenix, Jackson
County, Oregon

PURPOSE: To survey and monument a lot line adjustment
per client's request

PROCEDURE: Utilizing a one second theodolite and
electronic distance measuring equipment,
control established for Survey Number 11753
was extended to include found monuments as
shown on the attached map. Locations were
then computed for the lot line adjustments
and monuments set as shown.

BASIS OF BEARING: Recorded Survey No. 10212

DATE: November 4, 1991

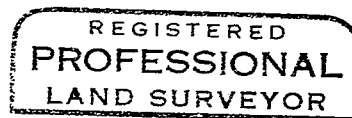
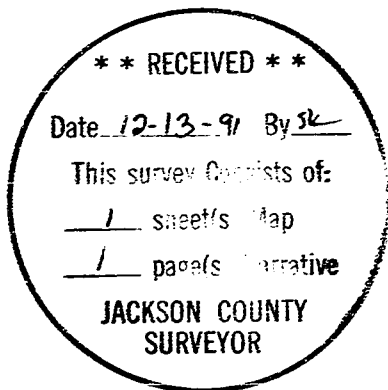

Douglas C. McMahan

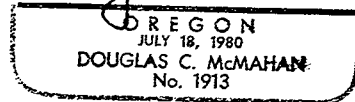

Douglas C. McMahan
Hoffbuhr & Associates, Inc.
219 N. Oakdale
Medford, Oregon