

12725

WEST 301.87'

PLAT OF SURVEY

LOCATED IN THE SE 1/4 OF SEC. 31, T. 36 S.,
R. 1 W., W.M., JACKSON COUNTY,
OREGON. OCTOBER 21, 1991

SURVEY BY: EDWARDS SURVEYING AND
LAND PLANNING INC.
823 W. 8th STREET
MEDFORD, OR 97504
(503) 776-2313

SURVEY FOR: CHESTER ERNST
1163A PROGRESS WAY
MEDFORD, OR 97504
(503) 826-5721

Doc. No.
77-24593

REGISTERED
PROFESSIONAL
LAND SURVEYOR

David A. Edwards

OREGON
ART 26 1988
DAVID A. EDWARDS
2339

** RECEIVED **
Date 11-13-91 By SE
This survey consists of:
1 sheet(s) Map
1 page(s) Narrative
JACKSON COUNTY
SURVEYOR

SCALE
1"=100'

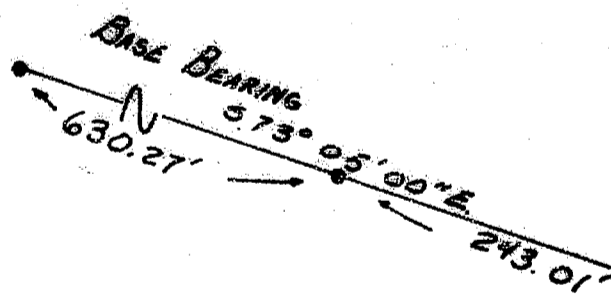

LEGEND

- INDICATES 5/8" REBAR FD. PER. R.S.N. 2506
 - INDICATES 5/8" x 24" STEEL PIN W/ PLASTIC CAP MKD. "D.A. EDWARDS- LS 2339" SET.
- R.S.N. = RECORDED SURVEY NUMBER
BASIS OF BEARING: R.S.N. 2506
X—X FENCE LINE

FD. 5/8" SLICK PIN PER
R.S.N. 648, WHICH BEG.
N. 0° 20' 40" W., 2912.14' AND
S. 87° 45' 30" W., 1257.16'
FROM THE 1/4" I. PIN
IN MON. CASE AT
THE SE COR. OF
SEC. 31.

SOUTH 927.78'



A=12° 01' 00"
R=940'
L=197.15'
LC=5.79° 05' 30" W
196.78'

573° 05' 00" E
3.08'

JUSTICE ROAD

12725

T36-1W-31 T.L. 3234

Edwards Surveying & Land Planning Inc.

DARREL W. EDWARDS
OREGON REG. 741
ARIZONA REG. 9746



DAVID A. EDWARDS
OREGON REG. 2339

REGISTERED LAND SURVEYORS
823 WEST 8TH ST.
MEDFORD, OREGON 97501
(503) 776-2313 • (503) 471-7059

12725

SURVEY NUMBER

SURVEY NARRATIVE TO COMPLY WITH CHAPTER 209, PARAGRAPH 250,
OREGON REVISED STATUTES

SURVEY FOR: Chester Ernst
1163A Progress Way
Medford, Oregon 97504

LOCATION: In the SE 1/4 of Section 31, T. 36 S.,
R. 1 W., W.M., Jackson County, Oregon.

PURPOSE: To locate and monument the boundaries of that
tract described in Document Number 77-24593,
Official Records, as shown on the
accompanying plat.

PROCEDURE: Utilizing for control monuments of record per
Recorded Surveys Numbered 648 and 2506, as well
as data found in the above noted deed, computed
the boundaries of the tract. The missing
monuments were then reset per deed record.
Monuments set on this survey consist of a 5/8"
x 24" steel pin with red plastic cap mkd.
"D.A. EDWARDS-LS 2339".

**BASIS OF
BEARINGS:** Recorded Survey Number 2506 as shown.

EQUIPMENT: Nikon NTD-4 Semi-automatic theodolite/E.D.M.

**DATE
COMPLETED:** October 21, 1991

