

# PLAT OF SURVEY

LOCATED in the NE 1/4 of Section 13,  
T. 38 S., R. 2 W., W.M., Jackson County,  
Oregon.

May 23, 1991

SURVEYED FOR: *Eise Nijse*  
4958 Pioneer  
Medford, Oregon 97501

SURVEYED BY: *Edwards Surveying and Land Planning Inc.*  
823 W. 8th Street  
Medford, Oregon 97501  
Phone: (503) 776-2313

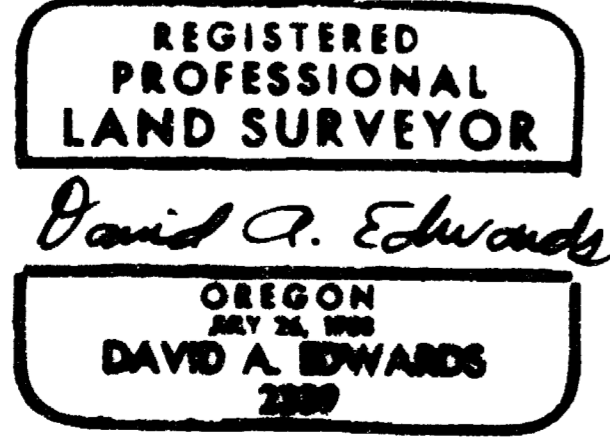

6-21-91 SC

- LEGEND**
- Indicates 5/8" diam. I. Pin per R.S.N. 4044 found unless otherwise noted.
  - ✕ Indicates 5/8" I. Pin w/cap per R.S.N. 6977 found.
  - Indicates 5/8" x 24" steel pin w/plastic cap mkd. "D.A. EDWARDS-RPLS 2339" set.
  - ( ) Denotes Deed Record Data except where noted.
  - x-x-x- Fence Line
  - J.C.S. = Jackson County Surveyor
  - R.S.N. = Recorded Survey Number
  - SCALE: 1" = 100'
  - BASIS OF BEARINGS: R.S.N. 4044

# Edwards Surveying & Land Planning Inc.

DARREL W. EDWARDS  
OREGON REG. 741  
ARIZONA REG. 9746



DAVID A. EDWARDS  
OREGON REG. 2339

REGISTERED LAND SURVEYORS  
823 WEST 8TH ST.  
MEDFORD, OREGON 97501  
(503) 776-2313 • (503) 471-7059

SURVEY NUMBER 12560

SURVEY NARRATIVE TO COMPLY WITH CHAPTER 209, PARAGRAPH 250,  
OREGON REVISED STATUTES

SURVEY FOR: Else Nijse  
4958 Pioneer Rd.  
Medford, Oregon 97501

LOCATION: In the NE 1/4 of Section 13, T. 38 S.,  
R. 2 W., W.M., Jackson County, Oregon.

PURPOSE: To locate and monument the boundaries of that  
tract described in Doc. No. 69-06672, official  
records, less exception, as shown on the  
accompanying plat.

PROCEDURE: Utilizing for control monuments of record per  
recorded suveys numbered 4044 and 6977, as well  
as data found in the above noted document,  
computed the boundaries of the subject tract.  
Ties were made to the physical center line of  
the T.I.D. irrigation canal in order to compute  
and monument the Southeasterly boundary of the  
tract described in Vol. 502, Pg. 105. Monuments  
set on this survey consist of 5/8" x 24" steel  
pins with red plastic caps mkd. "D.A. EDWARDS-  
RPLS 2339".

BASIS OF BEARINGS: Recorded survey Number 4044 as shown.

EQUIPMENT: Nikon NTD-4 Semi-automatic theodolite/E.D.M.

DATE COMPLETED: May 23, 1991

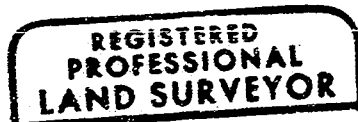
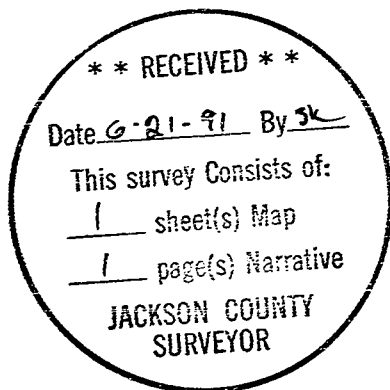

*David A. Edwards*

