

# PLAT OF SURVEY

LOCATED in the NE 1/4 of Section 17,  
T. 33 S., R. 1 W., W.M., in Jackson  
County, Oregon.

March 28, 1991

SURVEYED FOR: *Guy and Ruby Harris*  
5015 Hwy. 227  
Trail, Oregon 97541

SURVEYED BY: *Edwards Surveying and Land Planning Inc.*  
1014 East Pine Street  
Central Point, Oregon 97502  
Phone: (503) 664-1539

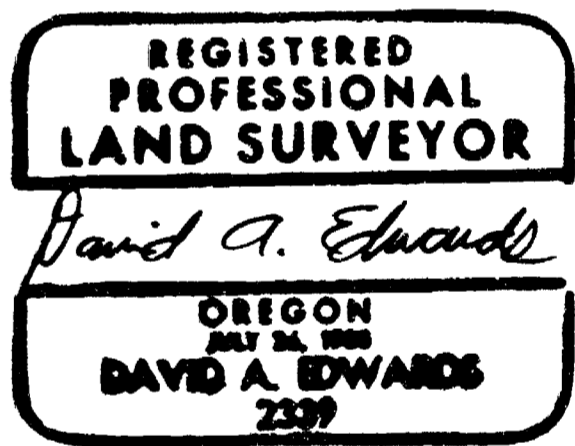
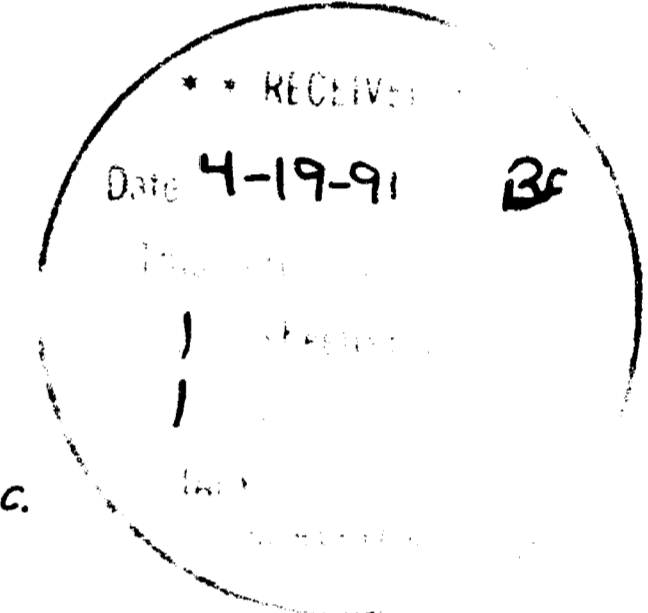

### LEGEND

- Indicates monument found as noted.
- Indicates 5/8" x 30" steel pin w/plastic cap mkd." D.A. EDWARDS-RPLS 2339 " set.
- [ ] Denotes record data per B.L.M. resurvey
- ( ) Denotes record data as noted.
- x-x- Fence Line

SCALE: 1" = 400'

BASIS OF BEARINGS: South line, SE 1/4, Section 17 per R.S.N. 11027.

# Edwards Surveying & Land Planning Inc.

DARREL W. EDWARDS  
OREGON REG. 741  
ARIZONA REG. 9746



DAVID A. EDWARDS  
OREGON REG. 2339

REGISTERED LAND SURVEYORS  
823 WEST 8TH ST.  
MEDFORD, OREGON 97501  
(503) 776-2313 • (503) 471-7059

SURVEY NUMBER 12480

## SURVEY NARRATIVE TO COMPLY WITH CHAPTER 209, PARAGRAPH 250, OREGON REVISED STATUTES

**SURVEY FOR:** Guy and Ruby Harris  
5015 Hwy. 227  
Trail, Oregon 97541

**LOCATION:** In the NE 1/4 of Section 17, T. 33 S., R. 1 W.,  
W.M., Jackson County, Oregon.

**PURPOSE:** To locate and monument the SW and NW corners of  
tax lot 1800, to mark the true West and South  
boundaries of said parcel and to set witness  
monuments on the North and South boundaries  
near the West line of Hwy. 227 as shown on the  
accompanying plat.

**PROCEDURE:** An open control traverse was executed which  
tied in the West and south 1/4 corners, the NE  
Section corner and the "line monument" on the  
South line of Section 17 per R.S.N. 11027. A  
closed traverse was executed to tie in the  
North 1/4 corner. Part of this closed loop was  
run along the West and South lines of the  
subject property. Computations were then made  
to allow for the subdivision of the NE 1/4 of  
Section 8 as shown.

Jackson County Surveyor's office file No.  
81-19 provides information regarding the two  
monuments which have been set for the SE corner  
of Section 8. After due consideration it was  
decided to accept the B.L.M. monument, both at  
the NE Sec. corner and the North 1/4 corner. A  
review of other Section lines in the immediate  
vicinity shows that this NW'y bearing in the  
East half of the Sections is somewhat  
representative of Nathaniel Ford's work.

Bearing trees were scribed according to the  
1973 Manual, measured to center of tree at root  
crown and are situated as follows:

At the CN 1/16 corner of Section 17:  
A 4" diam. Fir bears N. 25° E., 12.17 ft.  
A 5" diam. Fir bears S. 80° W., 13.44 ft.

Monuments set on this survey consist of 5/8" x  
30" steel pins with red plastic caps mkd.  
"D.A. EDWARDS-RPLS 2339".

**BASIS OF  
BEARINGS:** South line, SE 1/4, Sec. 17, per R.S.N. 11027.

**EQUIPMENT:** Nikon NTD-4 Semi-automatic theodolite/E.D.M.

**DATE  
COMPLETED:** March 28, 1991

T33-1W-17 Tax Lot 1800

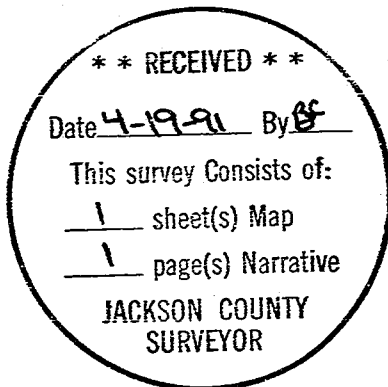

REGISTERED  
PROFESSIONAL  
LAND SURVEYOR

*David A. Edwards*

OREGON  
JULY 26, 1988  
DAVID A. EDWARDS  
2339