

GARY D. KAISER
R.P.L.S. ORE. 803
C.W.R.E. ORE. 73

KAISER SURVEYING
108 MISTLETOE STREET
MEDFORD, OREGON 97501

PHONE
MEDFORD (503) 779-8040
SHADY COVE (503) 878-3995

SURVEY NO. 12159

SURVEY NARRATIVE TO COMPLY WITH O.R.S. 209.250

SURVEY FOR: MARJORIE CONGER
1836 HYBISCUS ST.
MEDFORD, OREGON 97504

SURVEY BY: KAISER SURVEYING
108 MISTLETOE STREET
MEDFORD, OR 97501

LOCATION: SE ¼ OF SECTION 10,
T. 33 S., R. 2 E., W.M.,
JACKSON COUNTY, OREGON

BASIS OF BEARINGS: FILED SURVEY NO. 10728 WITH GRID
BEARINGS DECREASED IN AZIMUTH BY
1° 25' 00".

DATE: AUGUST 17, 1990

PURPOSE: To monument the NW corner of tract
described in Inst. No. 89-29775 O.R.
and to set a witness corner on the
West boundary of said tract near the
edge of the Canyon wall.

PROCEDURE: Utilizing found monuments as shown
set on Filed Survey Nos. 1098 and 10728 for control, the
desired monumentation was accomplished.

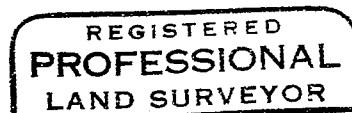
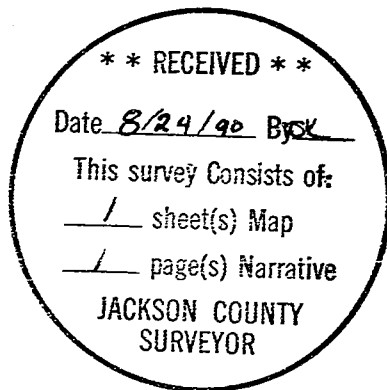

G. O. Ka

