

AFFIDAVIT OF CORRECTION  
Doc. No. 01-04887 (SN 11893)

**LEGEND**

- ⊙ = Found brass disc monument
- = Found 5/8" iron pin
- x- = Wire fenceline
- - - = wrought iron fenceline
- = Set 5/8"x24" iron pin with orange plastic cap marked "Roberts LS 1656"

REGISTERED  
**PROFESSIONAL**  
LAND SURVEYOR

*Roger R. Roberts*

OREGON  
JULY 14, 1978  
**ROGER R. ROBERTS**  
1634

MAP OF SURVEY  
for  
**EARL RADER**

located in  
SUNSET PARK  
Northeast 1/4 of Sec 35  
T 37S, R 2 W, WM.,  
Jackson County, Oregon  
(90-004)

BY: Roger R. Roberts  
Hoffbuhr & Assoc., Inc.  
Medford, Oregon  
February 7, 1990

**\*\* RECEIVED \*\***

Date 2/12/90 By SK

This survey consists of:

1 sheet(s) Map

1 page(s) Narrative

**JACKSON COUNTY SURVEYOR**

SURVEY NO. 11893

SURVEY NARRATIVE TO COMPLY WITH PARAGRAPH 209.250  
OREGON REVISED STATUTES

SURVEY FOR: Earl Rader  
1010 Lozier Lane  
Medford, Oregon

LOCATION: A portion of Blocks 4 and 5 of SUNSET PARK,  
in the northeast quarter-section of Section 35,  
Township 37 South, Range 2 West, W.M.  
Jackson County, Oregon

PURPOSE: To determine the client's ownership and monument  
those corners designated by the client, as shown  
on the attached map

PROCEDURE: The south and east boundaries of Donation Land  
Claim No. 77 were retraced and used to control the  
exterior boundaries of SUNSET PARK. In reviewing  
the previous surveys of record within the  
subdivision, it became apparent that there have  
been problems in attempting to determine the  
location of the north boundary of the subdivision.  
The methods used by these prior surveys were used  
to maintain conformity. Therefore, the sub-  
division boundary and lots and blocks were  
determined by record distances from the south and  
east boundaries of Donation Land Claim No. 77,  
using parallel bearings.

The 2.00 ft. witness monument set on Survey  
No. 5544 near the southeast corner of Lot 2 of  
Block 5 could not be found. The monument set at  
the southwest corner of Lot 3 of Block 5 on the  
same survey may still be in place, but not  
apparent. There appears to be several feet of  
fill material in this area.

Basis of bearing: Survey No. 525, along the  
south boundary of Donation Land Claim No. 77.

February 12, 1990

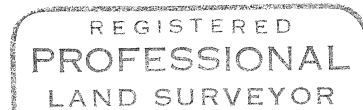
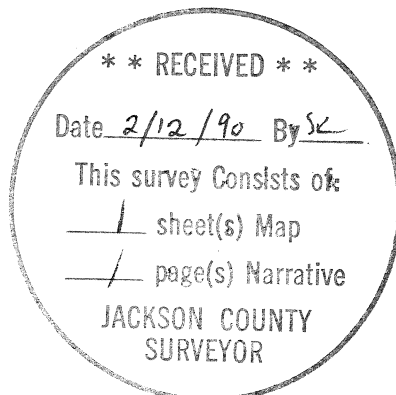

*Roger R. Roberts*

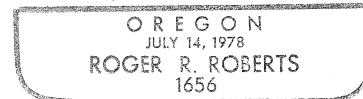

Roger R. Roberts  
Hoffbuhr & Assoc. Inc.  
219 North Oakdale Ave.  
Medford, Oregon 97501

AFFIDAVIT OF CORRECTION

Be it hereby noted with regard to Survey No. 11893 as filed with the Office of the Jackson County Surveyor, the following corrections should be made to the map of said survey:

The bearing of the south boundary of Donation Land Claim No. 77, as shown on the map, should be corrected to read N 89°52'30" E. The following lines, intended to be parallel with said south boundary, should also be corrected to read N 89°52'30" E:

- The south boundary of 3<sup>rd</sup> Street
- The north and south boundaries of Westdale Place and vacated 4<sup>th</sup> Street
- In Block 4 of Sunset Park, the south boundary of Lots 1, 2, and 3 (being the same as the north boundary of Lots 4, 5, and 6).
- In Block 5 of Sunset Park, the south boundary of Lots 1, 2, and 3 (being the same as the north boundary of Lots 4, 5, and 6).

Date: January 29, 2001  
Surveyor: Roger R. Roberts

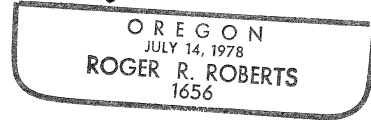
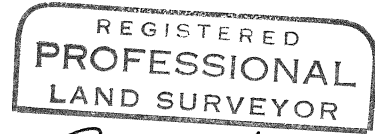

STATE OF OREGON  
County of Jackson SS

Personally appeared the above named Roger R. Roberts, Registered Professional Land Surveyor, who acknowledged the foregoing to be his voluntary act and deed, before me this 29 day of January 2001

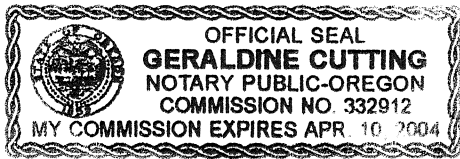

Geraldine Cutting  
Notary Public for the State of Oregon

I, Gerard J. Floyd, Curry County Surveyor, acting on behalf of the Jackson County Surveyor, hereby certify that I have examined this Affidavit of Correction and that the changes are permitted in accordance with Chapter 209, Paragraph 255, Oregon Revised Statutes.

G. J. Floyd  
Gerard J. Floyd, Curry County Surveyor

FEB 2<sup>nd</sup> 2001  
Date

Jackson County, Oregon  
Recorded  
OFFICIAL RECORDS

FEB 07 2001  
2:40 PM  
Arthur S. Roberts  
COUNTY CLERK