

MINOR LAND PARTITION

FOR: MRS. KITTIE DECKER
950 CLAY STREET
ASHLAND, OREGON

LOCATED IN: LOTS 13 & 14 BELLEVUE (A RECORDED SUBD.)
IN THE CITY OF ASHLAND
SW 1/4 SEC. 14, T.39S., R.1E., W.M.
JACKSON COUNTY, OREGON

SCALE: 1" = 50'

APPROVALS:

EXAMINED AND APPROVED THIS 22nd DAY OF May, 1989.

James H. Carlson
CITY SURVEYOR

WE CERTIFY THAT PURSUANT TO AUTHORITY GRANTED TO US BY THE ASHLAND PLANNING COMMISSION IN OPEN MEETING OF April 11, 1989, THIS MAP IS HEREBY APPROVED DATED THIS 22nd DAY OF May, 1989 (SEE FILE NO. 89-056).

Ned C. Benson PRESIDENT
John Ferguson SECRETARY

RECORDER'S CERTIFICATE:

FILED FOR RECORD THIS THE 31 DAY OF May, 1989 AT 3:09 O'CLOCK P.M.
AND RECORDED IN VOLUME 9 PAGE 93 OF MINOR LAND PARTITIONS IN JACKSON COUNTY, OREGON.

Kathleen S. Beckett COUNTY CLERK
Joy A. Ramirez DEPUTY

WATER RIGHTS STATEMENT:

INSTRUMENT NO. 89-11273 OFFICIAL RECORDS.

SURVEYOR'S CERTIFICATE:

I, MARK E. BOYDEN, A DULY REGISTERED SURVEYOR OF THE STATE OF OREGON, DO HEREBY CERTIFY THAT THIS MAP CORRECTLY REPRESENTS A SURVEY MADE BY ME AND COMPLIES WITH THE REGULATIONS FOR MINOR LAND PARTITIONS.

Mark E. Boyden
SURVEYOR

SURVEY BY:

BOYDEN SURVEYORS
108 MISTLETOE STREET
MEDFORD, OREGON
BY: MARK E. BOYDEN - RLS 281

LEGEND

- = SET 5/8" X 24" REBAR WITH RED PLASTIC CAP MARKED "BOYDEN RLS 281"
- = FOUND YELLOW PLASTIC CAPPED MON. MARKED "FLATEBO RCE 7971" S.N. 7007
- ⊕ = FOUND MONUMENT AS INDICATED
- S.N. = SURVEY No.

DATE

MAY 16, 1989

REGISTERED PROFESSIONAL LAND SURVEYOR

Mark E. Boyden
MAY 16 1989

BASIS OF BEARINGS

NOAA. (PER S.N. 5955)

I HEREBY CERTIFY THAT THIS IS A PHOTOCOPY OF THE ORIGINAL PLAT

Mark E. Boyden
SURVEYOR

RECEIVED
Date 5-31-89 By 2
This survey consists of:
1 sheets of plat
1 Certified Narrative
JACKSON COUNTY SURVEYOR

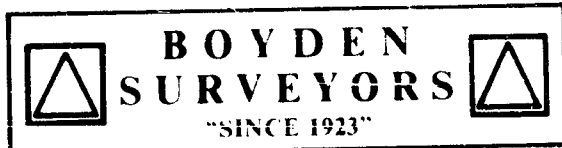

MARK E. BOYDEN
R.P.L.S. ORE 281

108 MISTLETOE ST., MEDFORD, OREGON 97501
PHONE (503) 773-6000

GARY D. KAISER
R.P.L.S. ORE 803

SURVEY NO. 11615

SURVEY NARRATIVE TO COMPLY WITH O.R.S. 209.250

SURVEY FOR: MRS. KITTIE DECKER
950 Clay Street
Ashland, Oregon, 97520

SURVEY BY: BOYDEN SURVEYORS
108 Mistletoe Street
Medford, Oregon, 97501

LOCATION: SW ¼, Sec. 14, Lots 13 & 14 BELLEVUE
(recorded) City of Ashland, Jackson
County, Oregon.

BASIS OF BEARINGS: Filed Survey No. 5955

DATE: May 16, 1989

PURPOSE: To monument and describe the Kittie Decker property described in Jackson County Title Co. Policy No. 102960, dated March 7, 1972, excepting therefrom Parcel No. 1 of Minor Land Partition No. 336 (Filed Survey No 7007) as described in Instrument No. 79-09068 of the Official Records of Jackson County, Oregon, for a Minor Land Partition in two parcels.

PROCEDURE:

Utilizing E.D.M. equipment, tied to existing monumentation as shown. Lots 13 & 14 of BELLEVUE (recorded) were located with plat record distances, utilizing the center of the concrete pavement of Siskiyou Boulevard (see Filed Survey No. 4033) and the east boundary of Clay Street per Filed Survey No. 5955. Minor differences with Filed Survey No. 7007 were found and reported as shown.

Set additional monuments at positions shown.

