

11522

SURVEY FOR

RAYMOND G. HILTON
3288 OLD MILITARY ROAD
CENTRAL POINT, OREGON

SURVEY BY

BOYDEN SURVEYORS
108 MISTLETOE ST.
MEDFORD, OREGON

LOCATION

S.E. 1/4 OF SECTION 8,
T. 37 S., R. 2 W., W.M.
JACKSON COUNTY, OREGON

DATE

MARCH 1, 1989

1/4 CORNER
FD. 1" G.I.P. W/
2 1/2 BR. CAP
C. S. 1987

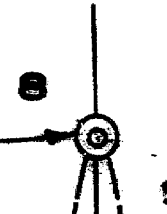

1172.53'

1334.62'

FD. 5/8" I. PIN
S.N. 1747

0.07'

S. 1/16 CORNER
SET 1" x 36" G.I.P. W/
PL. CAP MARKED "KAISER"
R L S 803"

WITNESS CORNER
SET 5/8" x 24" REBAR W/
PL. CAP MARKED "KAISER"
R L S 803"

S 89° 26' W
797.00'

N 0° 14' 10" W

BOUNDARY LINE AGREEMENT

INST. NO. 89-01642 O.R.

OLD MILITARY (COUNTY) ROAD

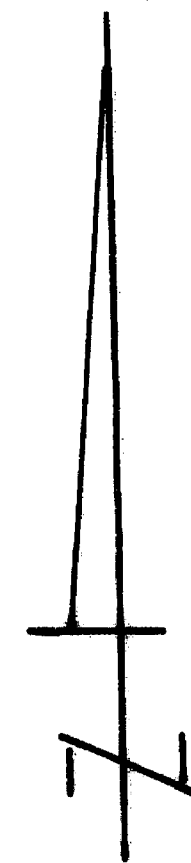

SCALE : 1" = 100'

SEC. CORNER
FD. 2" G.I.P. W/
3" BR. CAP
C. S. 1982

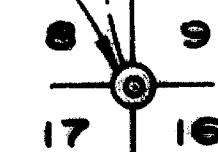

BASIS OF BEARINGS

FILED SURVEY NO. 1747

** RECEIVED **

Date 3-2-89 By SK

This survey consists of:

1 sheet(s) Map

1 page(s) Narrative

JACKSON COUNTY
SURVEYOR

REGISTERED
PROFESSIONAL
LAND SURVEYOR

G. D. Kaiser

OREGON
JULY 16, 1987
GARY D. KAISER
NO. 800

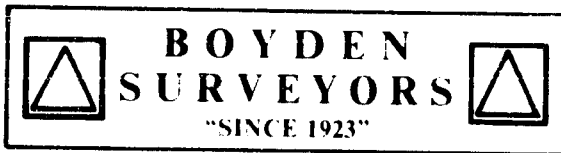

MARK E. BOYDEN
R.P.L.S. ORE 281

108 MISTLETOE ST., MEDFORD, OREGON 97501
PHONE (503) 773-6000

GARY D. KAISER
R.P.L.S. ORE 803

SURVEY NO. 11522

SURVEY NARRATIVE TO COMPLY WITH O.R.S. 209.250

SURVEY FOR: RAYMOND G. HILTON
3288 Old Military Road
Central Point, Oregon

SURVEY BY: BOYDEN SURVEYORS
108 Mistletoe street
Medford, Oregon

LOCATION: SE ¼ of Section 8, T.37S., R.2W., W.M.,
in Jackson County, Oregon

BASIS OF BEARINGS: Filed Survey NO. 1747

DATE: March 1, 1989

PURPOSE: To monument that boundary established
by agreement and recorded in Instrument
No. 89-01642 O.R. The true Easterly
right-of-way line of Old Military
(County) Road was not determined on this
survey, therefore a witness corner was
set for the Westerly terminus of said
agreement boundary.

PROCEDURE:

An E.D.M. traverse was initiated at the quarter corner common to Sections 8 & 9 running to the corner common to Section 8, 9, 16 & 17 and the desired boundary was monumented as shown on the annexed map.

At the South 1/16 corner common to Sections 8 & 9 set a 1" x 36" galvanized iron pipe 33" in the ground with plastic cap "Kaiser R.L.S. 803". From which:

The Southeast corner of a concrete garage bears North 66° 59' West, 175.3 feet.

The center of an unmarked 22" yellow pine bears North 15° 45' West, 43.7 feet.

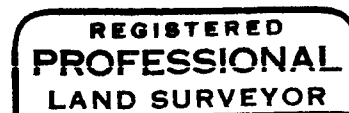
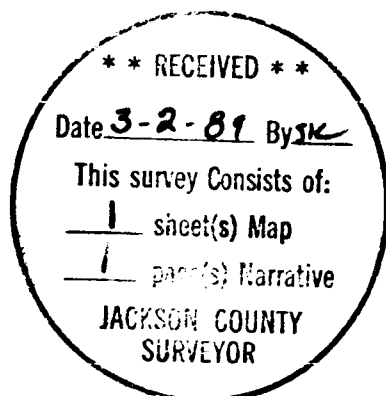

Gary D. Kaiser

