

T.32S.
JACKSON CO. KLAMATH CO.
R.4E. R.5E. (UNSURVEYED)

① EAST 1/4 S12 ONLY
FOUND A JACKSON COUNTY SURVEYOR MONUMENT
ACCESSORIES FOUND:
42" FIR, S.66°50'E., 10.20 FT., SCRIBING BT VISIBLE
11" FIR, S.02°41'E., 22.78 FT., SCRIBING CS BT VISIBLE
22" CEDAR, N.68°55'W., 70.65 FT., SCRIBING CS BT VISIBLE

② NORTHEAST SECTION CORNER S13
SET A 2-1/2" X 32" IRON POST 32" IN THE GROUND, MARKED AS SHOWN:
ACCESSORIES MARKED:
65" CEDAR, S.58°58'W., 106.73 FT., SCRIBED - T32SR4ES13LS1071 BT
27" FIR, N.67°02'W., 35.02 FT., SCRIBED - T32SR4ES12LS1071 BT

③ ANGLE POINT NO. 1380
SET A 2-1/2" X 32" IRON POST 32" IN THE GROUND, MARKED AS SHOWN:
ACCESSORIES MARKED:
34" FIR, S.31°19'E., 15.5 FT., SCRIBED - SLW 1380 LS1071 BT
9" HEMLOCK, S.56°25'W., 29.00 FT., SCRIBED - SLW 1380 LS1071 BT
5/8" DIA. IRON PIN, S.25°54'E., 6.67 FT.

④ EAST 1/4 S13 ONLY
SET A 2-1/2" X 32" IRON POST 30" IN THE GROUND, MARKED AS SHOWN:
ACCESSORIES MARKED:
13" HEMLOCK, S.51°47'W., 33.68 FT., SCRIBED - 1/4S13 LS1071 BT
24" FIR, N.42°36'W., 53.40 FT., SCRIBED - 1/4S13 LS1071 BT

⑤ SE SECTION CORNER S13
FOUND JACKSON COUNTY SURVEYOR MONUMENT
ACCESSORIES FOUND:
13" FIR SNAG, N.50°39'E., 17.00 FT., SCRIBING 32S R5E S18 BT VISIBLE
8" HEMLOCK, S.07°21'E., 70.36 FT., SCRIBING CS BT VISIBLE
BRUSHY STUMP, S.42°45'W., 20.27 FT., LOOSE FACE SCRIBED SR4ES24 VISIBLE
23" FIR, N.73°40'W., 75.86 FT., SCRIBING CS BT VISIBLE
9" HEMLOCK, N.88°28'W., 13.44 FT., PARTIAL SCRIBING VISIBLE. THIS TREE HAS A BRUSHY TOP.

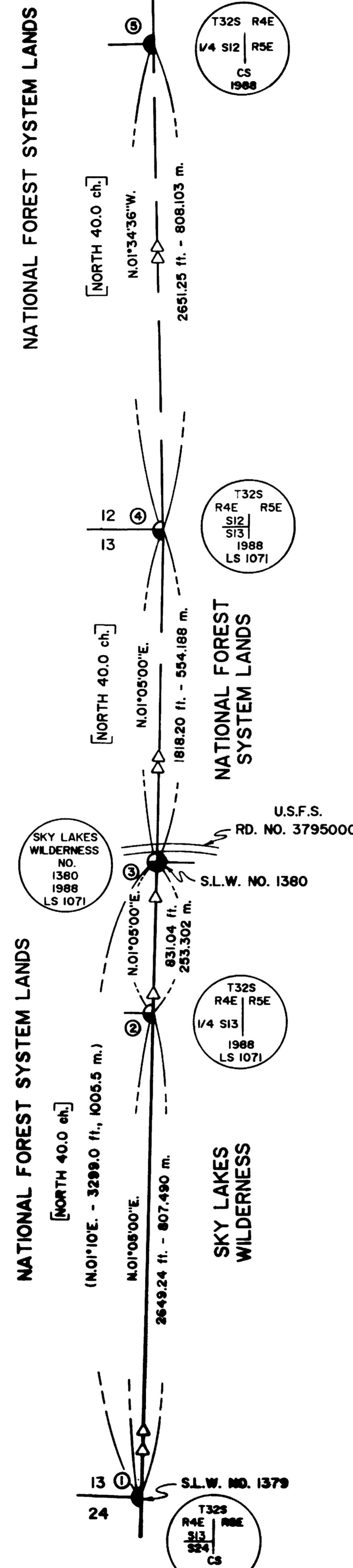

PURPOSE

THE PURPOSE OF THIS SURVEY WAS TO REESTABLISH CERTAIN CORNER POINTS AND TO MARK AND POST A PORTION OF THE SKY LAKES WILDERNESS BOUNDARY, MORE PARTICULARLY DESCRIBED AS FOLLOWS:

BEGINNING AT THE NORTHEAST CORNER FOR SECTION 24, SAID POINT KNOWN AS S.L.W. NO. 1379, T.32S., R.4E., THENCE N.01°10'E., 3299 FT. (1005.5 m.) ALONG THE EAST SECTION LINE FOR SECTION 13, T.32S., R.4E., TO A POINT ON THE SOUTH EDGE OF THE ROAD PRISM OF U.S.F.S. ROAD NO. 3795000. SAID ANGLE POINT KNOWN AS S.L.W. NO. 1380.

HISTORY OF SURVEYS

THE EAST BOUNDARY OF RANGE 4 EAST, TOWNSHIP 32 SOUTH, W.M., WAS SURVEYED BY THE U.S. DEPUTY SURVEYOR RUFUS MOORE UNDER CONTRACT NO. 504 DATED MAY 27, 1884. CORNERS NO. 1 AND 5 WERE REMONUMENTED FROM EVIDENCE BY THE JACKSON COUNTY SURVEYOR. NO OTHER SURVEYS ARE OF RECORD.

PROCEDURE

PRIOR TO COMMENCEMENT OF THIS SURVEY AN INVESTIGATION OF CERTAIN CORNER POINTS WAS PERFORMED. CORNERS NO. 1 AND 5 WERE VERIFIED AS BEING ORIGINAL, REMONUMENTED CORNERS. CORNERS NO. 2 AND 4 COULD NOT BE FOUND. HOWEVER, USING THE ORIGINAL TOPOGRAPHIC CALLS AND FURTHER INVESTIGATION, A LOCUS OF THE ORIGINAL LINE WAS ESTABLISHED. BLAZED TREES DATING TO THE TIME OF THE ORIGINAL SURVEY WERE FOUND AT VARIOUS LOCATIONS. UTILIZING ALL OF THESE RECOVERED BLAZED TREES, AND ALSO UTILIZING THE TOPOGRAPHIC CALLS MADE BY SURVEYOR MOORE, CORNERS NO. 2 AND 4 WERE REESTABLISHED BY PROPORTIONATE MEASUREMENT. CORNER NO. 3 (WHICH IS DESCRIBED AS S.L.W. NO. 1380) WAS ESTABLISHED ON THE EAST BOUNDARY OF SECTION 13, AT THE INTERSECTION OF THE SOUTH EDGE OF THE ROAD PRISM FOR U.S.F.S. ROAD 3795000. SAID POINT IS ON THE TOP OF THE CUT BANK, 14 FEET SOUTH OF THE APPROXIMATE CENTERLINE OF U.S.F.S. ROAD NO. 3795000.

EQUIPMENT

EQUIPMENT UTILIZED THROUGHOUT THIS SURVEY INCLUDES: A WILD T-2 THEODOLITE, A SOKKISHA RED 2L DISTANCE METER AND A FENNEL FT3 NO. 135-286 NORTH SEEKING GYRO.

LEGEND

- FOUND JACKSON COUNTY SURVEYOR BRASS CAP MONUMENT
● SET 2-1/2" DIA. X 32" LONG IRON POST WITH A 2-1/2" DIA. BRASS CAP ATTACHED.
--- LINE POSTED WITH 6 FOOT ALUMINUM POSTS WITH ALUMINUM WILDERNESS BOUNDARY SIGNS ATTACHED. TREES ON WILDERNESS SIDE WITHIN 2 FEET OF THE BOUNDARY WERE BLAZED WITH A SINGLE BLAZE AND TWO HACK MARKS. TREES FACING THE WILDERNESS WERE NOT BLAZED.
--- CALCULATED LINE FROM TRAVERSE SURVEY
△ FOUND BLAZED TREES DATED TO THE ORIGINAL 1884 SURVEY
S.L.W. SKY LAKES WILDERNESS
[] PUBLIC LAND SURVEY SYSTEM RECORD
() SKY LAKES WILDERNESS RECORD

MAP OF SURVEY FOR ROGUE RIVER NATIONAL FOREST

P.O. BOX 520
MEDFORD, OREGON
DECEMBER 5, 1988

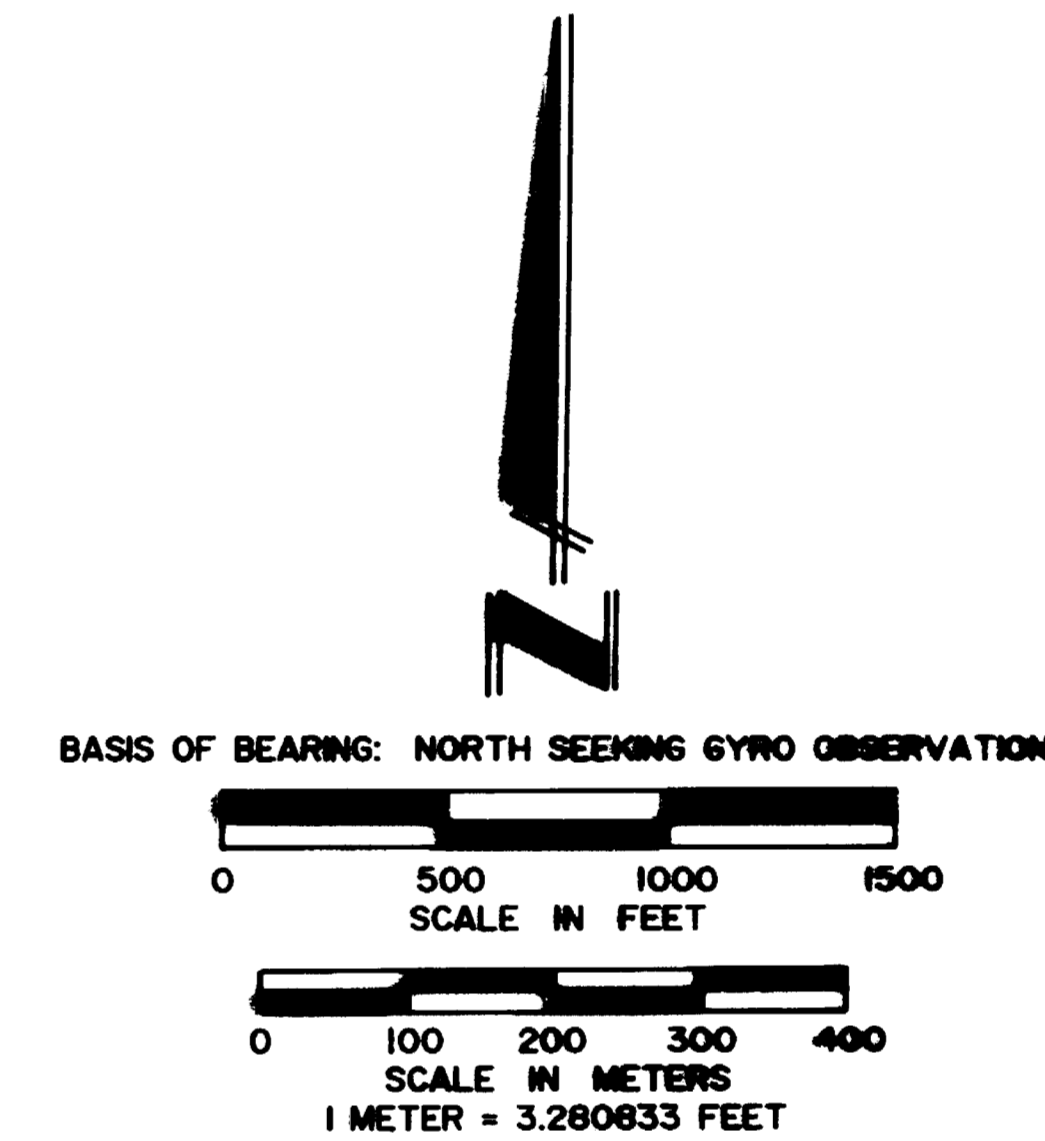

CERTIFICATE OF SURVEY

I, HAROLD L. CENTER, REGISTRATION NO. 1071, REGISTERED PROFESSIONAL LAND SURVEYOR, STATE OF OREGON, HEREBY CERTIFY THAT THIS PLAT CORRECTLY REPRESENTS A SURVEY MADE BY ME OR UNDER MY DIRECT SUPERVISION IN CONFORMANCE WITH THE LAWS OF THE STATE OF OREGON AT THE REQUEST OF THE UNITED STATES FOREST SERVICE.

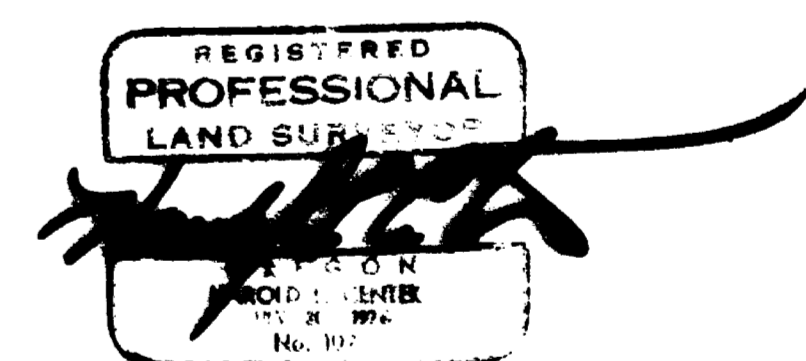
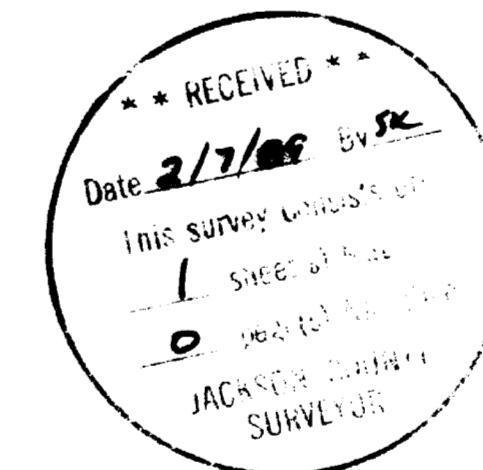

PROJECT NO. 88-1
U.S. DEPARTMENT OF AGRICULTURE
FOREST SERVICE
REGION 6 - ROGUE RIVER NATIONAL FOREST
DEPENDENT RESURVEY AND ESTABLISHMENT OF A PORTION OF THE SKY LAKES WILDERNESS BOUNDARY SECTION 13, T.32S., R.4E., W.M. JACKSON COUNTY, OREGON

REVIEWED BY: [Signature] DATE: 1/2/89
REVIEWED BY: [Signature] DATE: 1/2/89