

11319

SURVEY NARRATIVE

SURVEY in the Northwest Quarter of Section 27, Township 36 South, Range 4 West of the Willamette Meridian, Jackson County, Oregon.

SURVEY FOR: Walter Doucett
P.O. Box 1153
Rogue River, Ore. 97537

SURVEY BY: Robert Mason
415 Surrey Dr.
Grants Pass, Ore.

PURPOSE OF SURVEY: To locate and monument the Doucett property and to mark portions of the lines as requested.

PROCEDURE: Bearings are based on the West line of Sec. 27 per Survey No. 2047

The description calls for the North and South lines to be parallel and to terminate on the West at the West line of Section 27, and on the East on the West lines of parcels described in Vol. 391 at Pg. 365 and Vol. 358 at Pg. 401 of J.C. Deed Records.

These two parcels appear to be lots in the "Walter H. Jones" un-recorded subdivision. The calls are generally to "iron pipe" monuments. I computed the position of these monuments that would control the easterly terminus of the East-West lines. One point fell in a newly constructed driveway and the second was approximately 1.45 feet west of the intersection of the three fence lines shown on the plat.

Since Schiefflin Gulch Road lies West of the calculated position of these controlling corners, I placed the Easterly corners of the Doucett Property, West of the controlling lines, allowing for a 40 foot wide road. Said road to run parallel to the described lines of said "Walter H. Jones" subdivision.

SURVEYED September 3, 1988.

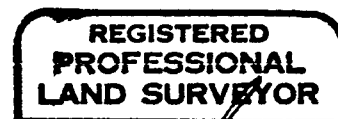
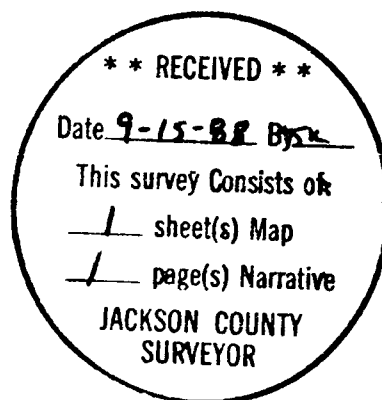

Robert Mason

