

Survey for Mr. Howard & Mr. Nissen, Crater Lake Ave, Medford, Oregon.
Date May 1958 Scale 1" = 50'

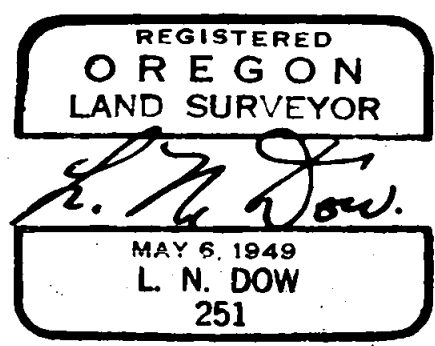
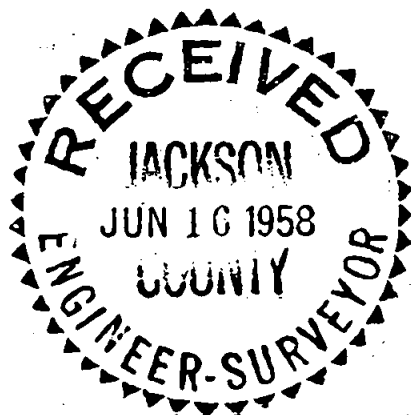

JACKSON ST

HOWARD AVE

center found

BENNETT AVE

60'

CRATER LAKE AVE

Mon. found

center int set

D.L.C. cor. found

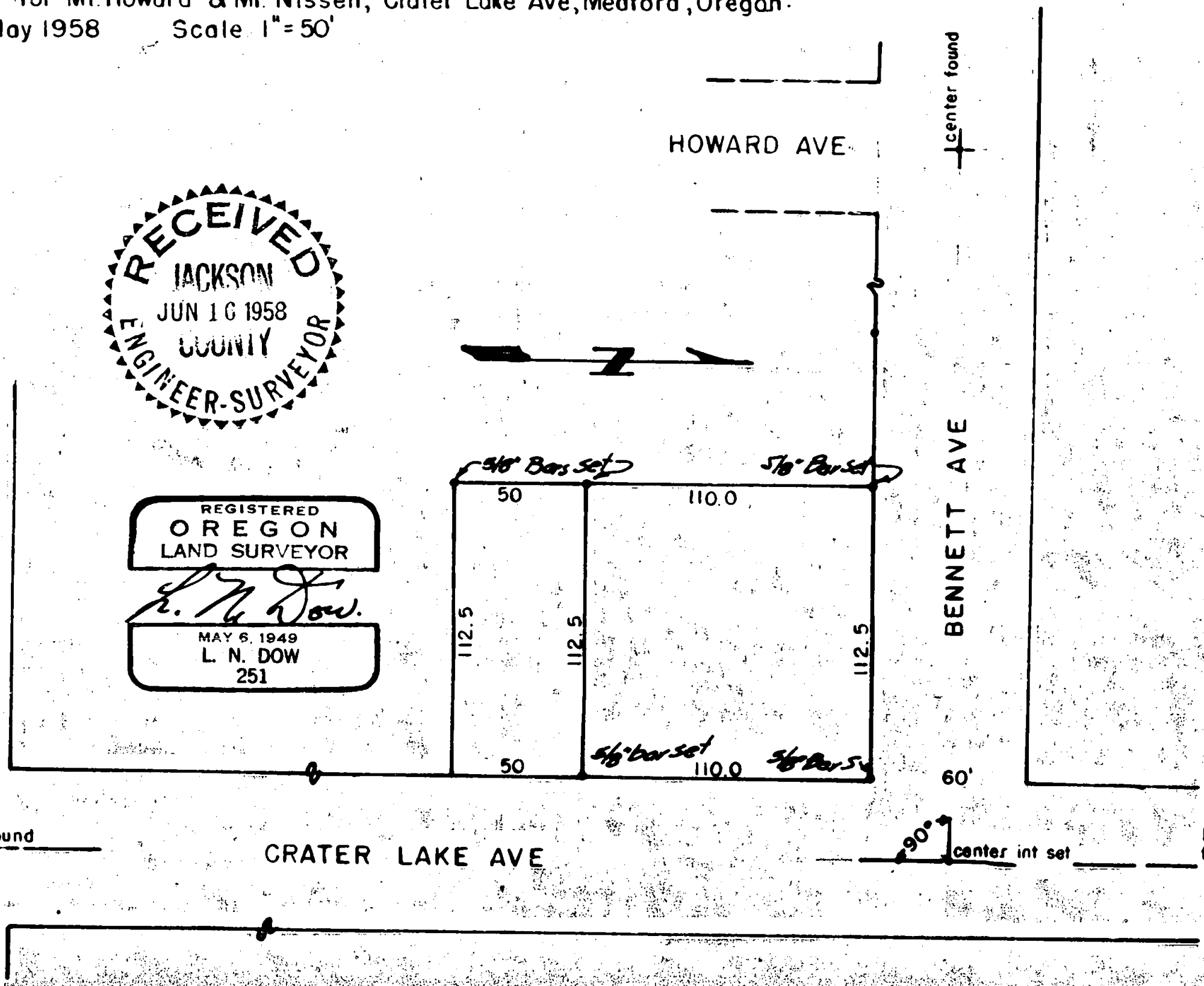

Written narrative to accompany plat for Survey No.

Survey for Mr. Howard and Mr. Missen.

Metes and Bounds property corner Crater Lake Ave and Howard St.
Medford, Jackson County, Oregon.

Date of Survey May 1958.

Having the street center monument on the D.L.C. Line at Jackson Street, and the D.L.C. Corner to the north we ran an intersection of the center of Crater Lake Avenue with the center of Bennett Street and turned the angle at this intersection for control. We then staked the property as shown on the plat setting 5/8 bars at corners as shown.

