

11174

- INDICATES FOUND MONUMENT.
- INDICATES SET 5/8" x 30" IRON ROD WITH YELLOW PLASTIC CAP MARKED "OREGON STATE PARKS".
- ▶ INDICATES SET ORANGE CARSONITE POST WITH DECAL MARKED "PROPERTY BOUNDARY STATE PARK LAND BEHIND THIS SIGN".
- ✓ INDICATES STATE PARK BOUNDARY.
- ( ) INDICATES RECORD INFORMATION.
- ② INDICATES OREGON CORNER RESTORATION FORM WITH CORRESPONDING NUMBER.

NOTE SEE ACCOMPANYING OREGON CORNER RESTORATION FORMS

**NARRATIVE**

THE PURPOSE OF THIS SURVEY WAS TO ESTABLISH THE BOUNDARY OF CASEY STATE PARK, WHICH IS THE SOUTH ONE-HALF OF THE N.E. QUARTER OF SECTION 33, T. 33 S., R. 1 E., W. M. OF JACKSON COUNTY. CONTROL WAS ESTABLISHED WITH A PENTAX, PX-10 D, TOTAL STATION. BEARINGS ARE FROM A SOLAR OBSERVATION, LOCAL HOUR ANGLE METHOD. THE PARKS SURVEY CREW, M. BRADETICH-B. BITTNER-S. DEJANAKUL, FOUND AND TIED ALL THE NECESSARY CORNERS TO SUBDIVIDE THE QUARTER SECTION TO THE CONTROL AND SUBDIVIDED AS PER MANUAL.

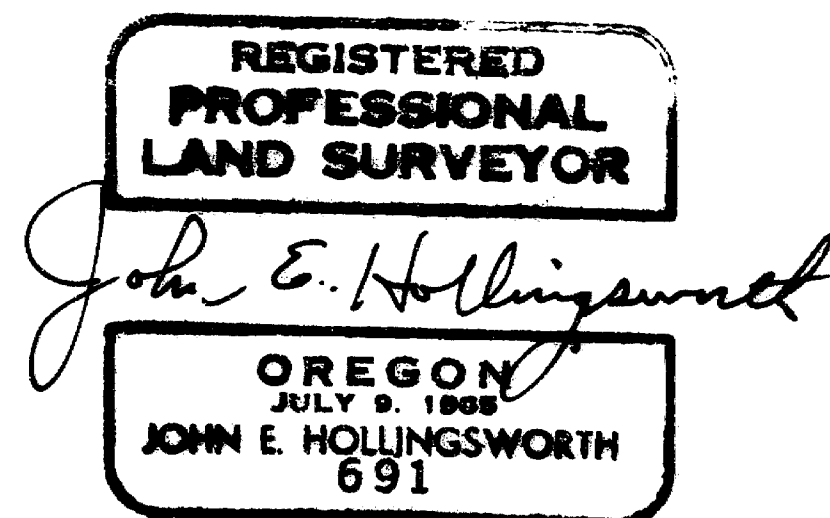

OREGON STATE PARKS  
525 TRADE ST. S.E.  
SALEM, OR. 97310

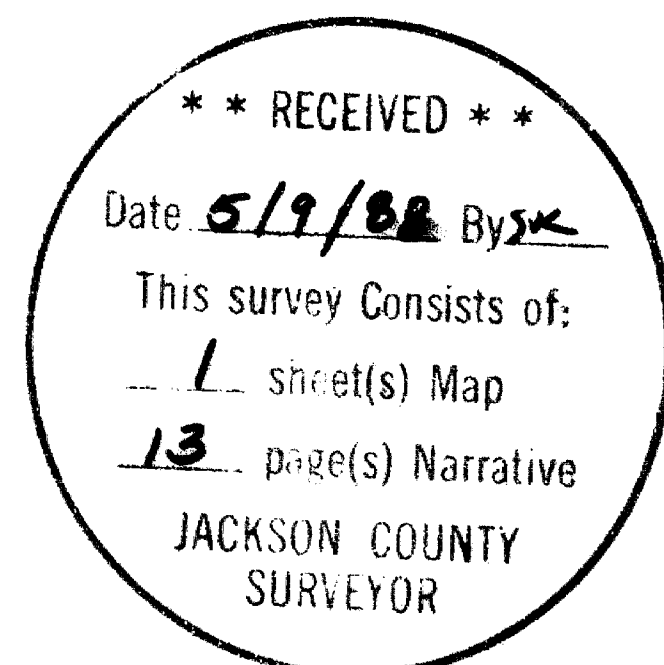

OREGON STATE PARKS & RECREATION DIVISION SURVEY  
CASEY STATE PARK  
N.E. 1/4 SEC. 33, T. 33 S., R. 1 E., W. M.  
JACKSON COUNTY

SCALE: 1" = 400'

MARCH 23, 1988

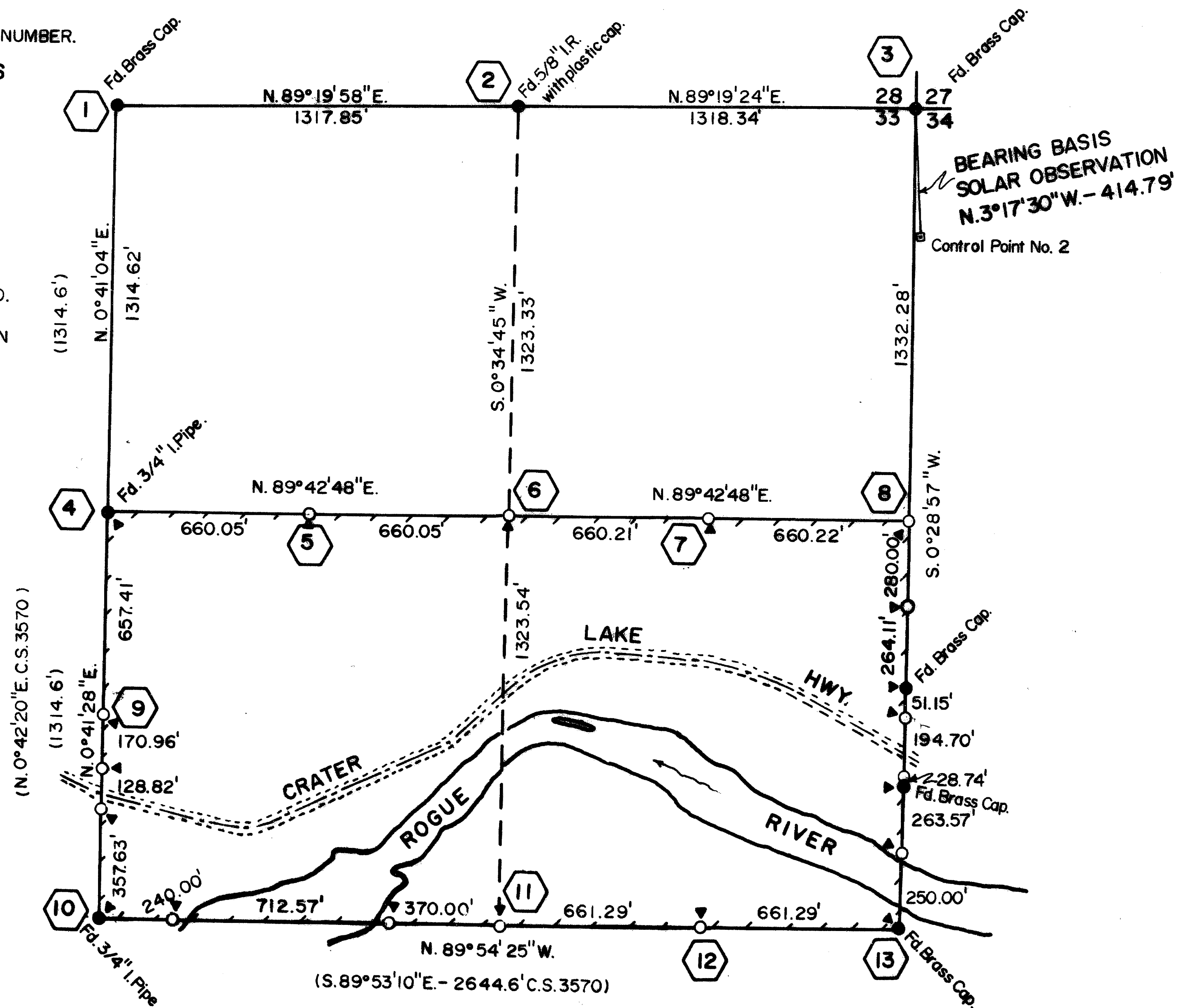

11174

OREGON CORNER RESTORATION FORM

Section 33 Township 33S Range 1E

County Jackson Date 1/5/68

Corner Designation

C-E-E 1/64  
Corner

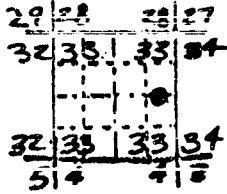

- Condition Report Only
- Not Found
- Renewed
- Unrecorded
- Surveyed In
- Referenced Out

Previous Renewals/Surveys, etc.

None.

Monument(s) & Accessories Found: (Condition and Source)

None.

Monument Detail

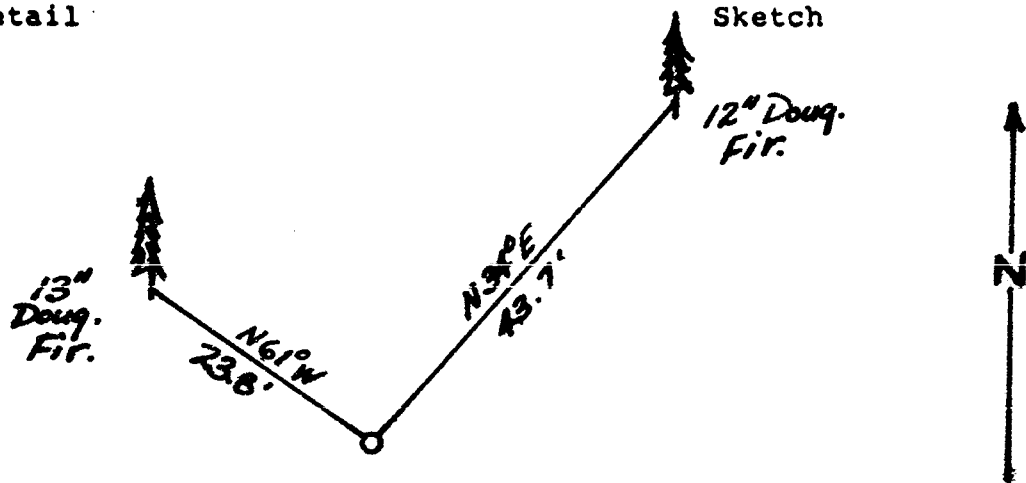
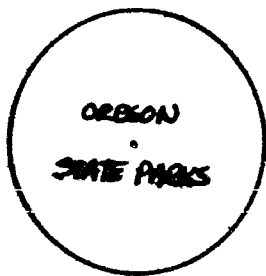

Monument Set (Procedures and Description)

Set 5/8"x30" iron rod with yellow plastic cap marked "Oregon State Parks" protruding 0.2' above ground.  
Set orange Carsonite post marked "Property Boundary - State Park Land Behind this Sign" 2.0' north.

New Accessories

12" Douglas fir, N34°E, 43.7, blazed and scribed "CEE 1/64 BT", Oregon State Parks corner tag attached.  
13" Douglas fir, N61°W, 23.8', blazed and scribed "CEE 1/64 RS691BT", Oregon State Parks corner tag attached.

Location & Comments

Casey State Park.  
Drawings not to scale.  
Bearings by hand compass, distance by steel tape.

Compass Declination 18½°E

Firm/Agency Oregon State Parks & Recreation Div.

Address 525 Trade Street SE Salem OR 97310

Party Chief M. Bradetich

Notes M. Bradetich

Witness B. Bittner

Seal

**REGISTERED PROFESSIONAL LAND SURVEYOR**

*John E. Hollingsworth*

OREGON  
JULY 9, 1968  
JOHN E. HOLLINGSWORTH  
691

OREGON CORNER RESTORATION FORM

Section 33 Township 33S Range 1E

County Jackson Date 1/5/88

Corner Designation

CE 1/16  
Corner

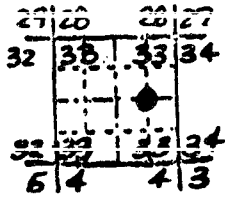

- Condition Report Only
- Not Found
  - Renewed
  - Unrecorded
  - Surveyed In
  - Referenced Out

Previous Renewals/Surveys, etc.

None.

Monument(s) & Accessories Found: (Condition and Source)

None.

Monument Detail

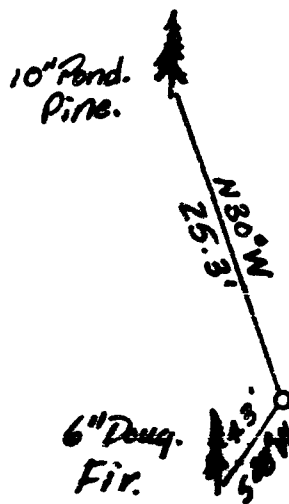
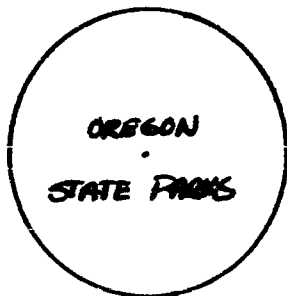

Sketch

Monument Set (Procedures and Description)

Set 5/8"x30" iron rod with yellow plastic cap marked "Oregon State Parks" protruding 0.3' above ground.  
 Set orange Carsonite post marked "Property Boudanry - State Park Land Behind this Sign" 2.0' north.

New Accessories

6" Douglas fir, S38°W, 4.3', blazed and scribed "CE 1/16 RS691BT", Oregon State Parks corner tag attached.  
 10" Ponderosa pine, N30°W, 25.3'- blazed and scribed "CE 1/16 BT", Oregon State Parks corner tag attached.

Location & Comments

Casey State Park.  
 Drawings not to scale.  
 Bearings by hand compass. Distance by steel tape.

Compass Declination 18 1/2°E

Firm/Agency Oregon State Parks & Recreation Div.

Address 525 Trade Street SE Salem OR 97310

Party Chief M. Bradetich

Notes M. Bradetich

Witness B. Bittner, S. Dejanakul

Seal

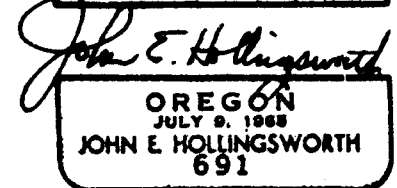
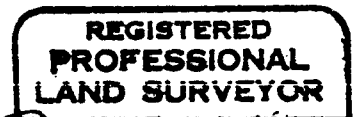

OREGON CORNER RESTORATION FORM

Section 33 Township 33S Range 1E

County Jackson Date 1/5/88

Corner Designation

*Center-Quarter  
Corner*

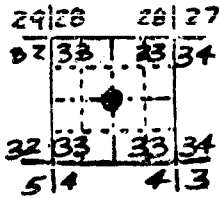

- Condition Report Only
- Not Found
- Renewed
- Unrecorded
- Surveyed In
- Referenced Out

Previous Renewals/Surveys, etc.  
CS 3570.

Monument(s) & Accessories Found: (Condition and Source)

Found 3/4" iron pipe flush with ground, 1.0' east of north/south running fence.  
 Found 15" black oak, S23°E, 117.4', double-blazed, healed over.  
 Found 20" black oak, S78°W, 44.6', double-blazed, healed over (part of twin oak--other half, 11").

Monument Detail

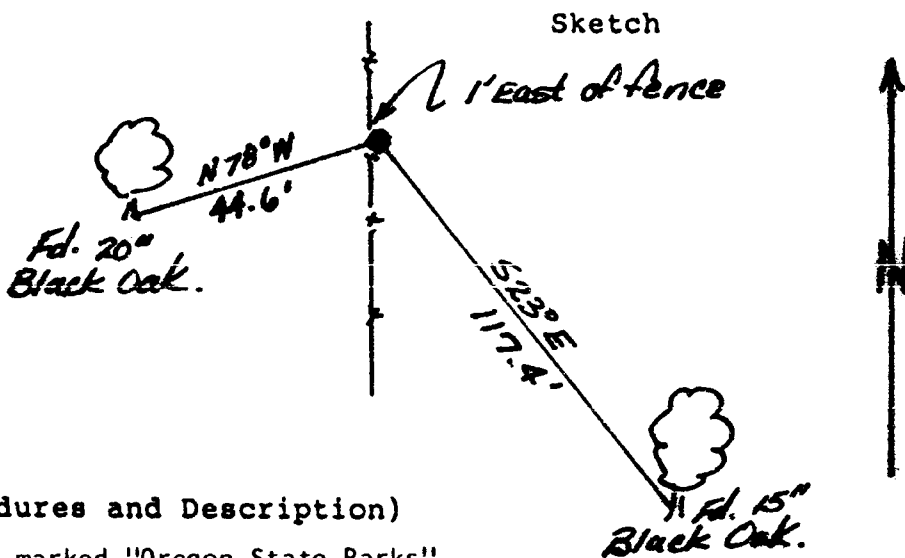

Monument Set (Procedures and Description)

Set yellow plastic cap marked "Oregon State Parks" in iron pipe.

New Accessories

Set orange Carsonite post marked "Property Boundary - State Park Land Behind this Sign" 2.0' northeast.  
 Attached Oregon State Parks corner tags to both BT's.

Location & Comments

Casey State Park.  
 Drawings not to scale.  
 Bearings by hand  
 compass. Distance by EDM.

Compass Declination 18 1/2°E  
 Firm/Agency Oregon State Parks & Recreation Div.  
 Address 525 Trade Street SE Salem OR 97310

Party Chief M. Bradetich  
 Notes M. Bradetich  
 Witness B. Bittner, S. Dejanakul, A. Slack

Seal



OREGON CORNER RESTORATION FORM

Section 33 Township 33S Range 1E

County Jackson Date 12/18/88

Corner Designation

C-S-N 1/64  
Corner

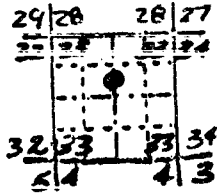

- Condition Report Only
- Not Found
  - Renewed
  - Unrecorded
  - Surveyed In
  - Referenced Out

Previous Renewals/Surveys, etc.  
None.

Monument(s) & Accessories Found: (Condition and Source)  
None.

Monument Detail

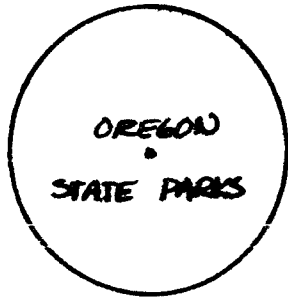

Sketch

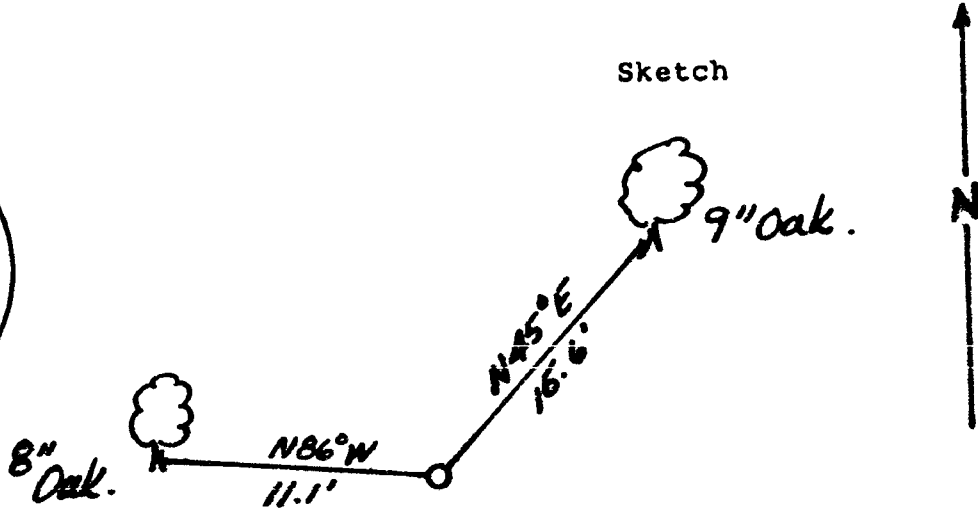

Monument Set (Procedures and Description)

Set 5/8"x30" iron rod with yellow plastic cap marked "Oregon State Parks" protruding 0.3' above ground.  
Set orange Carsonite post marked "Property Boundary - State Park Land Behind this Sign" 2.0' east.

New Accessories

9" oak, N45°E, 15.6', blazed and scribed "CSN 1/64 BT", Oregon State Parks corner tag attached.  
8" oak, N86°W, 11.1', blazed and scribed "CSN 1/64 RS691BT", Oregon State Parks corner tag attached.

Location & Comments

Casey State Park.  
Drawings not to scale.  
Bearings by hand compass, distance by steel tape.

Compass Declination 18½°E  
Firm/Agency Oregon State Parks & Recreation Div.  
Address 525 Trade Street SE Salem OR 97310  
Party Chief M. Bradetich  
Notes M. Bradetich  
Witness A. Slack, B. Bittner, S. Dejanakul

Seal

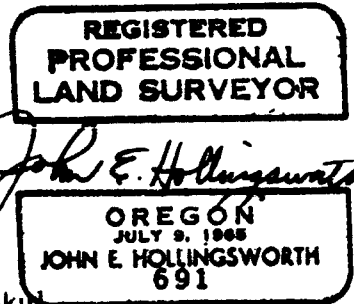

OREGON CORNER RESTORATION FORM

Section 33 Township 33S Range 1E

County Jackson Date 12/18/87

Corner Designation

*N. 1/16 Corner*

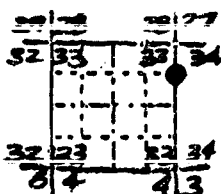

- Condition Report Only
- Not Found
  - Renewed
  - Unrecorded
  - Surveyed In
  - Referenced Out

Previous Renewals/Surveys, etc.

Oregon State Highway survey, 1936 (?).

Monument(s) & Accessories Found: (Condition and Source)

None.

Monument Detail



Sketch

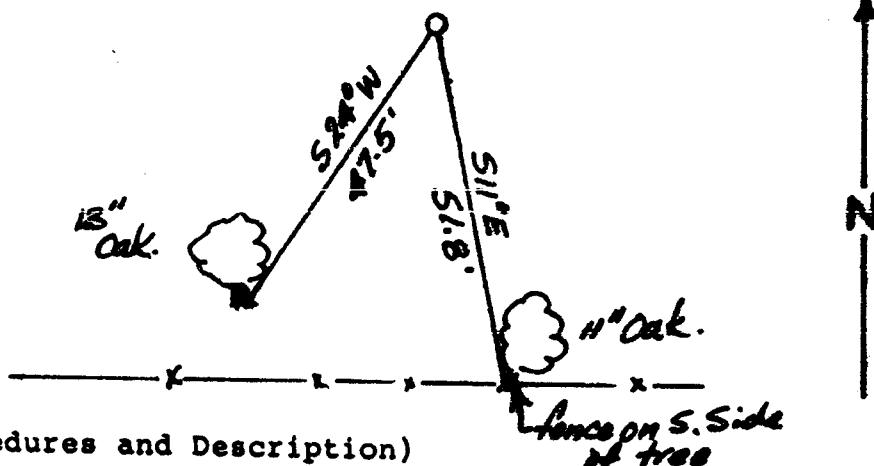

Monument Set (Procedures and Description)

Set 5/8"x30" iron rod with yellow plastic cap marked "Oregon State Parks" in a small mound of stones.

Set orange Carsonite post marked "Property Boundary - State Park Land Behind this Sign" 2.0' southwest.

New Accessories

11" oak, S11°E, 51.8', blazed and scribed "N 1/16 S34BT", Oregon State Parks corner tag attached. Oak has east/west-running fence attached to its south face. 13" oak, S24°W, 47.5', blazed and scribed "N 1/16 S33RS691BT" Oregon State Parks corner tag attached.

Location & Comments

Casey State Park.  
Drawings not to scale.  
Bearings by hand compass,  
distance by steel tape.

Compass Declination 18½°E  
 Firm/Agency Oregon State Parks & Recreation Div.  
 Address 525 Trade Street SE Salem OR 97310  
 Party Chief M. Bradetich  
 Notes M. Bradetich  
 Witness B. Bittner, S. Dejanakul

Seal

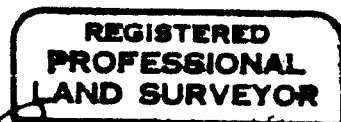

*John E. Hollingsworth*

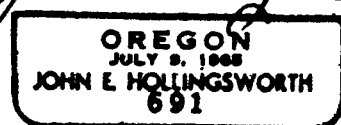

OREGON CORNER RESTORATION FORM

Section 33 Township 33S Range 1E

County Jackson Date 12/18/87

Corner Designation

C-E-NE 1/64  
Corner

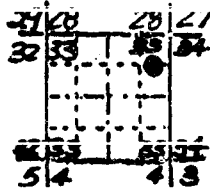

- Condition Report Only
- Not Found
- Renewed
- Unrecorded
- Surveyed In
- Referenced Out

Previous Renewals/Surveys, etc.

None.

Monument(s) & Accessories Found: (Condition and Source)

None.

Monument Detail

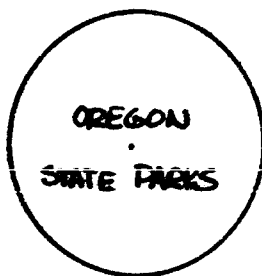

Sketch

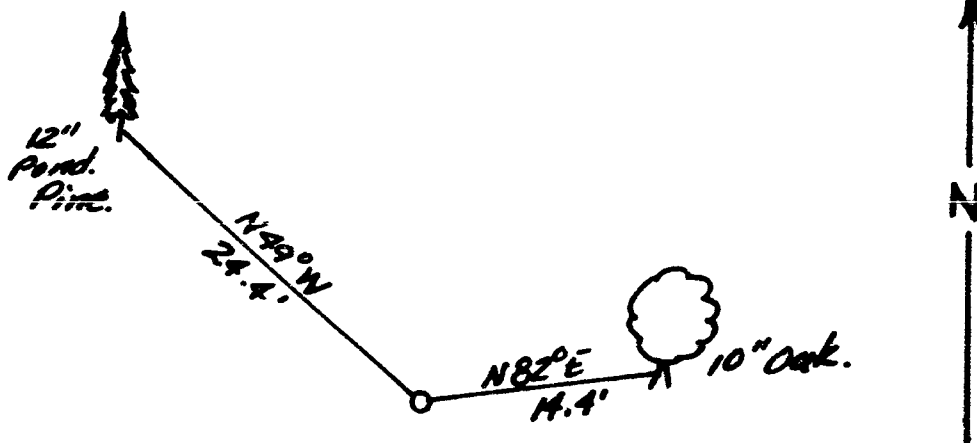

Monument Set (Procedures and Description)

Set 5/8"x30" iron rod with yellow plastic cap marked, "Oregon State Parks" in a small mound of stones.  
Set orange Carsonite post marked "Property Boundary - State Park Land Behind this Sign" 2.0' south.

New Accessories

10" oak, N82°E, 14.4', blazed and scribed "CENE 1/64 RS691BT", Oregon State Parks corner tag attached.  
12" Ponderosa pine, N49°W, 24.4', blazed and scribed "CENE 1/64 BT", Oregon State Parks corner tag attached.

Location & Comments

Casey State Park.  
Drawings not to scale.  
Bearings by hand compass.  
Distance by steel tape.

Compass Declination 18½°E  
Firm/Agency Oregon State Parks & Recreation Div.  
Address 525 Trade Street SE Salem OR 97310  
Party Chief M. Bradetich  
Notes M. Bradetich  
Witness B. Bittner, S. Dejanakul

Seal

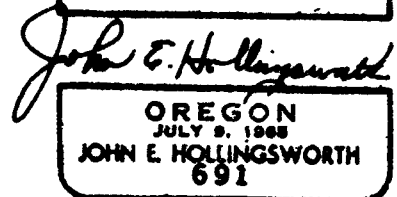
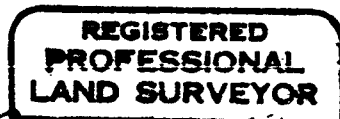

OREGON CORNER RESTORATION FORM

Section 33 Township 33S Range 1E

County Jackson Date 12/18/87

Corner Designation

NE 1/16 Corner

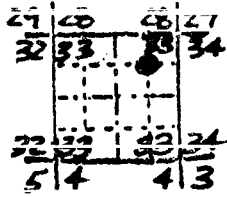

- Condition Report Only
- Not Found
- Renewed
- Unrecorded
- Surveyed In
- Referenced Out

Previous Renewals/Surveys, etc.

None.

Monument(s) & Accessories Found: (Condition and Source)

None.

Monument Detail

Sketch

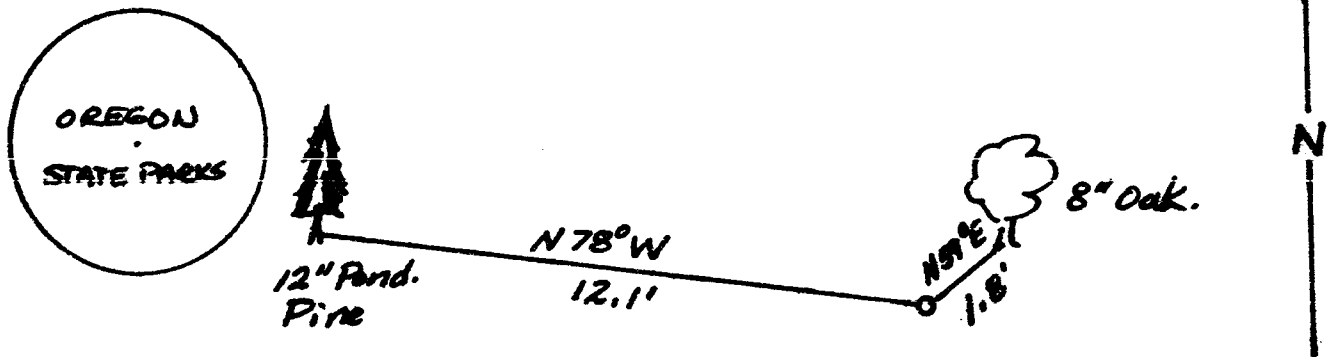

Monument Set (Procedures and Description)

Set 5/8"x30" iron rod with yellow plastic cap marked "Oregon State Parks" in a mound of stones 2.5'x3.5'x1.6' high.  
 Set orange Carsonite post marked "Property Boundary - State Park Land Behind this Sign" 2.2' south.

New Accessories

8" oak, N59°E, 1.8', blazed and scribed "NE 1/16 RS691BT", Oregon State Parks corner tag attached.  
 12" Ponderosa pine, N78°W, 12.1', blazed and scribed "NE 1/16 BT", Oregon State Parks corner tag attached.

Location & Comments

Casey State Park.  
 Drawings not to scale.  
 Bearings by hand compass,  
 distance by steel tape.

Compass Declination 18 1/2°E  
 Firm/Agency Oregon State Parks & Recreation Div.  
 Address 525 Trade Street SE Salem OR 97310

Party Chief M. Bradetich  
 Notes M. Bradetich  
 Witness B. Bittner, S. Dejanakul

Seal

REGISTERED  
 PROFESSIONAL  
 LAND SURVEYOR

*John E. Hollingsworth*

OREGON  
 JULY 9, 1908  
 JOHN E. HOLLINGSWORTH  
 691



OREGON CORNER RESTORATION FORM

Section 33 Township 33S Range 1E

County Jackson Date 12/18/87

Corner Designation

C-W-NE 1/64  
Corner

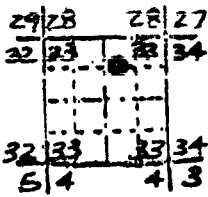

- Condition Report Only
- Not Found
- Renewed
- Unrecorded
- Surveyed In
- Referenced Out

Previous Renewals/Surveys, etc.  
None.

Monument(s) & Accessories Found: (Condition and Source)  
None.

Monument Detail

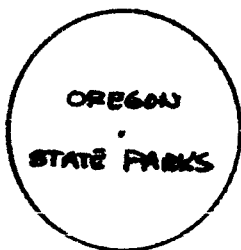

Sketch

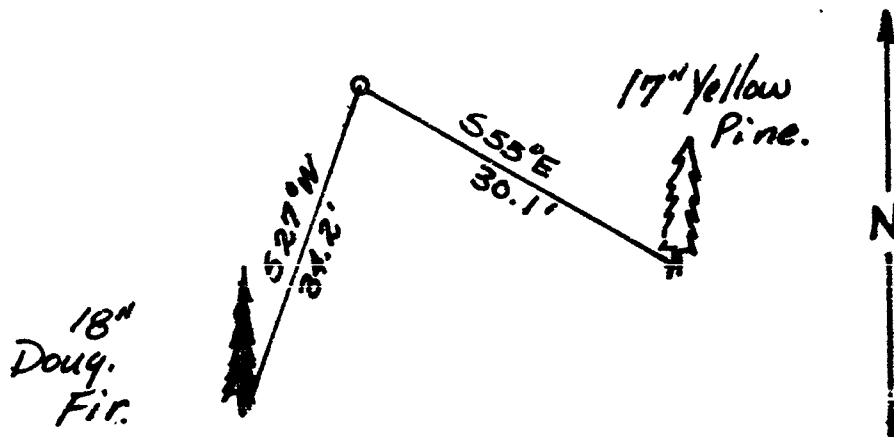

Monument Set (Procedures and Description)

Set 5/8" x 30" iron rod with yellow plastic cap marked "Oregon State Parks" in a small mound of stones.  
Set orange Carsonite post marked, "Property Boundary - State Park Land Behind this Sign" 2.0' south.

New Accessories

17" yellow pine, S55°E, 30.1', blazed and scribed "CWNE 1/64 BT", Oregon State Parks corner tag attached.  
18" Douglas fir, S27°W, 34.2', blazed and scribed "CWNE 1/64 RS691BT", Oregon State Parks corner tag attached.

Location & Comments

Casey State Park.  
Drawings not to scale.  
Bearings by hand compass,  
distance by steel tape.

Compass Declination 18½°E  
Firm/Agency Oregon State Parks & Recreation Div.  
Address 525 Trade Street SE  
Salem OR 97310  
Party Chief M. Bradetich  
Notes M. Bradetich  
Witness B. Bittner, S. Dejanakul

Seal

REGISTERED  
PROFESSIONAL  
LAND SURVEYOR

*John E. Hollingsworth*

OREGON  
JULY 9, 1968  
JOHN E. HOLLINGSWORTH  
691

OREGON CORNER RESTORATION FORM

Section 33 Township 33S Range 1E

County Jackson Date 1/5/88

Corner Designation

*C.N. 1/16 Corner*

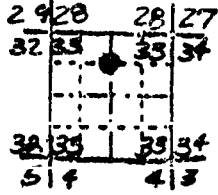

- Condition Report Only
- Not Found
- Renewed
- Unrecorded
- Surveyed In
- Referenced Out

Previous Renewals/Surveys, etc.  
C.S. 3570.

Monument(s) & Accessories Found: (Condition and Source)

Found 3/4" iron pipe protruding 0.9' above ground in a small mound of stones.  
Found 26" black oak, N46°E, 24.3', double blazed, healed over.  
Found 15" black oak, N41°W, 52.8', double blazed, healed over.

Monument Detail

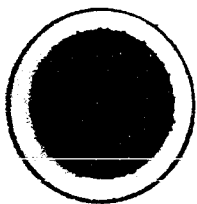

Sketch

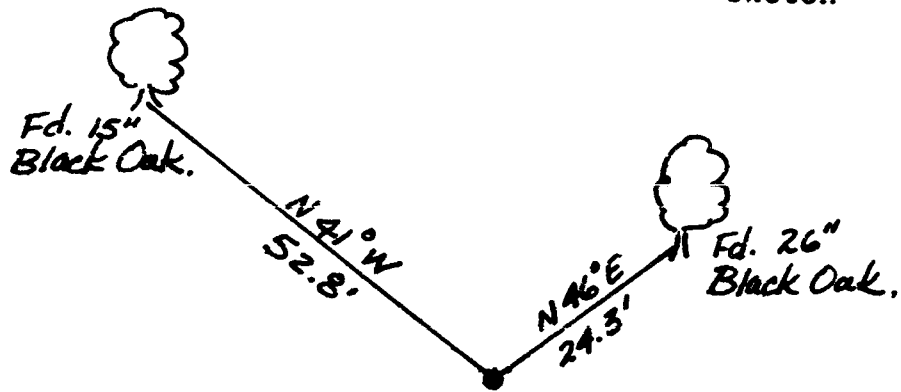

Monument Set (Procedures and Description)

None.

New Accessories

Attached Oregon State Parks corner tags to both BT's. Set orange Carsonite post marked "PROPERTY BOUNDARY - STATE PARK LAND BEHIND THIS SIGN" 2' southeast.

Location & Comments

Casey State Park.  
Drawings not to scale.  
Bearings by hand  
compass. Distance by  
EDM.

Compass Declination 18 1/2°E  
Firm/Agency Oregon State  
Parks & Recreation Div.  
Address 525 Trade Street SE  
Salem OR 97310

Party Chief M. Bradetich  
Notes M. Bradetich

Witness B. Bittner, S. Dejanakui

Seal



OREGON CORNER RESTORATION FORM

Section 33 Township 33S Range 1E

County Jackson Date 1/5/88

Corner Designation

*Section Corner*

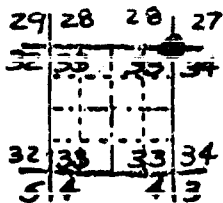

- Condition Report Only
- Not Found
- Renewed
- Unrecorded
- Surveyed In
- Referenced Out

Previous Renewals/Surveys, etc.

Oregon State Highway 1936, BLM 1974, C.S. 9503.

Monument(s) & Accessories Found: (Condition and Source)

- Found: 3/4" brass cap on 2" outside diameter iron pipe in a mound of stones, 1 1/2" iron pipe sits alongside the brass cap to the south.
- Found: 10" white oak, N83°E, 106.5', blazed, healed over, Jackson Co. bearing tree tag attached.
- Found: 12" white oak, S71°E, 75', blazed, rotted out, Jackson Co. bearing tree tag attached (Bearing on tag is N71E).
- Found: 9" white oak, S32°W, 70.8', double blazed, partially healed, scribing visible "T33SR1ES33 1358BT", corner tag attached.
- Found: white oak, N57°W, 110', double blazed, healed over, Jackson Co. bearing tree tag attached.

Monument Detail

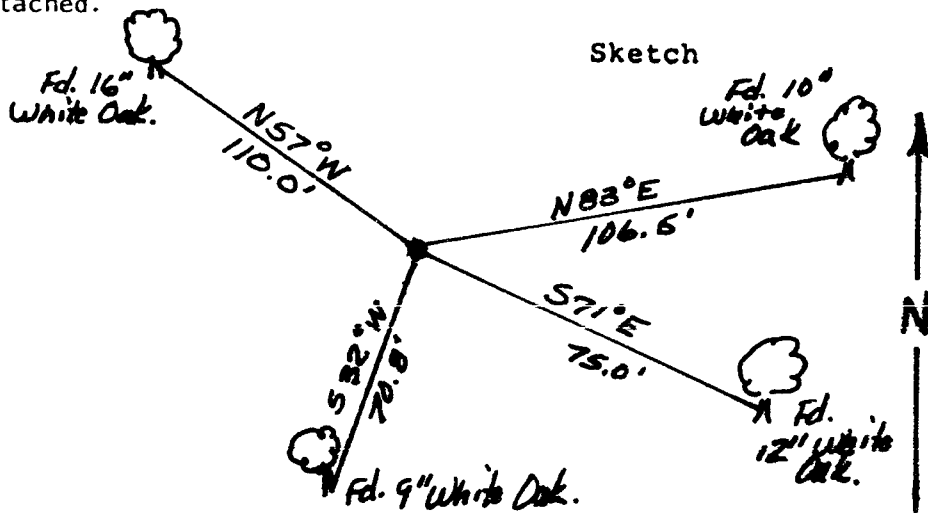
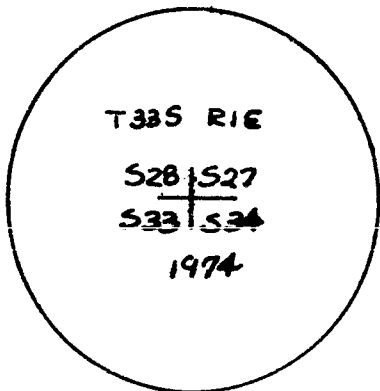

Monument Set (Procedures and Description)

None.

New Accessories

None.

Location & Comments

Casey State Park.  
Drawings not to scale.  
Bearings by hand  
compass. Distance  
by EDM.

Compass Declination 18 1/2°E

Firm/Agency Oregon State  
Parks & Recreation Div.

Address 525 Trade Street SE  
Salem OR 97310

Party Chief M. Bradetich

Notes M. Bradetich

Witness B. Bittner, S. Dejanakul

Seal

REGISTERED  
PROFESSIONAL  
LAND SURVEYOR

*John E. Hollingsworth*

OREGON  
JULY 9, 1988  
JOHN E. HOLLINGSWORTH  
691

OREGON CORNER RESTORATION FORM

Section 33 Township 33S Range 1E

County Jackson Date 1/5/88

Corner Designation

*E. 1/16 Corner*

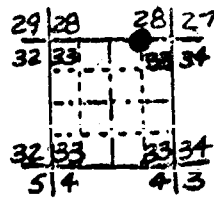

- Condition Report Only
- Not Found
- Renewed
- Unrecorded
- Surveyed In
- Referenced Out

Previous Renewals/Surveys, etc.

C.S. 9503.

Monument(s) & Accessories Found: (Condition and Source)

Found: 5/8" iron rod with yellow plastic cap in a small mound of stones 18" north of an E/W fence.

Found: 9" white oak, S33°W, 79.3', double blazed, scribbing visible, "E 1/16 S33 1358BT" corner tag attached.

Found: 15" yellow pine, N85°W, 121.6', double blazed, pitched over, scribbing partially visible, "E 1/16 S28 1358BT" corner tag attached.

Monument Detail

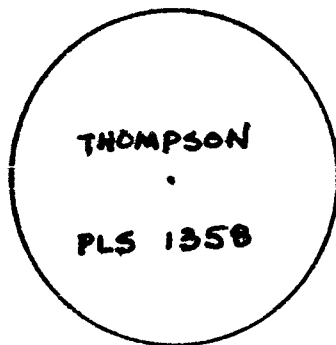

Sketch

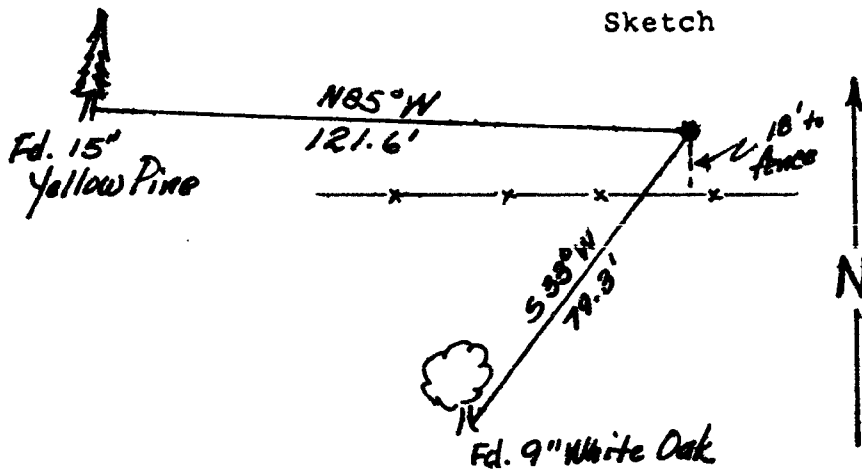

Monument Set (Procedures and Description)

None.

New Accessories

None.

Location & Comments

Casey State Park.  
Drawings not to scale.  
Bearings by hand  
compass. Distance  
by EDM.

Compass Declination 18½°E

Firm/Agency Oregon State  
Parks & Recreation Div.

Address 525 Trade Street SE  
Salem OR 97310

Party Chief M. Bradetich

Notes M. Bradetich

Witness B. Bittner, S. Dejanakul

Seal

REGISTERED  
PROFESSIONAL  
LAND SURVEYOR

*John E. Hollingsworth*

OREGON  
JULY 9, 1983  
JOHN E. HOLLINGSWORTH  
691

OREGON CORNER RESTORATION FORM

Section 33 Township 33S Range 1E

County Jackson Date 1/5/88

Corner Designation

Quarter  
Corner

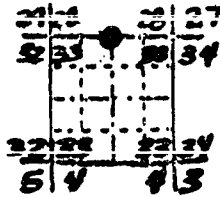

- Condition Report Only
- Not Found
- Renewed
- Unrecorded
- Surveyed In
- Referenced Out

Previous Renewals/Surveys, etc.

First re-establishment 9/11/67, C.S. Mark E. Boyden CS3570.

Monument(s) & Accessories Found: (Condition and Source)

Found: 2 1/2" brass cap on 1" outside diameter iron pipe protruding 0.6' above ground in a small mound of stones. Found 20" white oak, N19°E, 10.1', blaze chopped out and rotted, no scribe visible, witness tree tag and rusted corner tag attached. Found 15" white oak, S69°E, 45.4', double blazed, healed over, witness tree tag attached. Found 27" white oak, S22°E, 16.3', blaze chopped out and rotted, no scribe visible, witness tree tag attached, X-blaze on N&S sides of tree. Found 15" fir snag, N43°W, 23', double blazed, partially healed, some scribe visible, witness tree tag attached.

Monument Detail

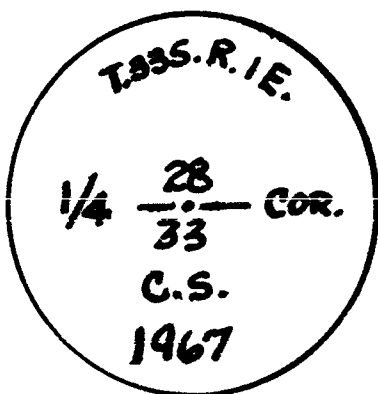

Sketch

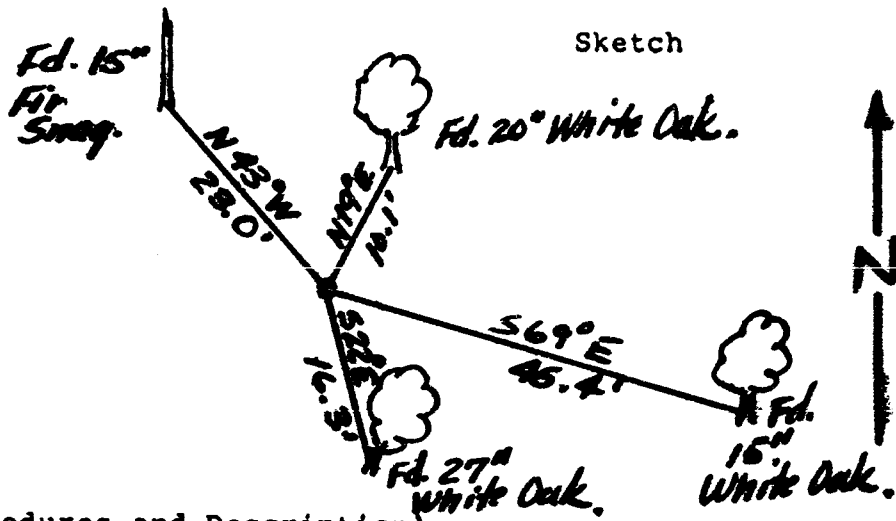

Monument Set (Procedures and Description)

None.

New Accessories

None.

\*\* RECEIVED \*\*

Date 5/9/88 By JK

This survey consists of:

1 sheet(s) Map

13 page(s) Narrative

JACKSON COUNTY  
SURVEYOR

Location & Comments

Casey State Park.  
Drawing not to scale.  
Bearings by hand  
compass, distance by  
EDM.

Compass Declination 18 1/2°E

Firm/Agency Oregon State  
Parks & Recreation Div.

Address 525 Trade Street SE  
Salem OR 97310

Party Chief M. Bradetich

Notes M. Bradetich

Witness B. Bittner, S. Dejanakul

Seal

REGISTERED  
PROFESSIONAL  
LAND SURVEYOR

*John E. Hollingsworth*

OREGON  
JULY 9, 1988  
JOHN E. HOLLINGSWORTH  
691

