

**SURVEY FOR**  
DOUBLE DEE LUMBER Co.  
P.O. BOX 3517  
CENTRAL POINT, OREGON

**LOCATION**  
SW 1/4 OF SECTION 17 AND THE  
NW 1/4 OF SECTION 20,  
T. 36 S., R. 1W, W.M.  
JACKSON COUNTY, OREGON

**SURVEY BY**  
BOYDEN SURVEYORS  
108 MISTLETOE STREET  
MEDFORD, OREGON

**DATE**  
APRIL 28, 1988

REGISTERED  
PROFESSIONAL  
LAND SURVEYOR

*Gary D. Kaiser*

OREGON  
JULY 16, 1967  
GARY D. KAISER  
No. 803

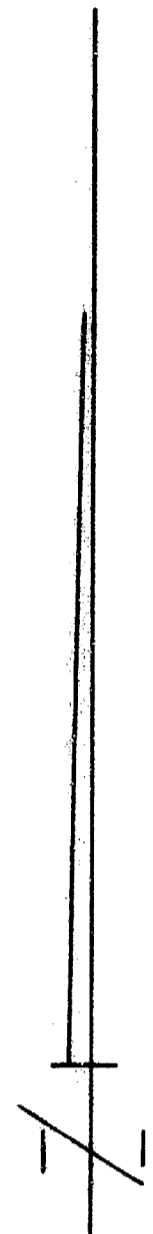

SCALE: 1" = 100'

**BASIS OF BEARINGS**  
FILED SURVEY No. 9185

**LEGEND**

- FOUND 5/8" REBAR WITH PLASTIC CAP
- ✕ FOUND MONUMENT AS INDICATED
- SET 5/8" X 24" REBAR WITH PLASTIC CAP MARKED "KAISER R L S 803"

\*\* RECEIVED \*\*  
Date: *5/10/88* By: *SK*  
This survey consists of:  
- sheet(s) Map  
- profile Narrative  
JACKSON COUNTY SURVEYOR

AVENUE 'G'

N 89°48' W 317.53'

10' WIDE DRAINAGE EASE.  
INST. No. 70-05094 O.R.

10.075 Ac. ±

SANITARY SEWER MAIN  
SS

S 19°56' W

1053.68'

N 0°12' E, 10.00'

Rebar 5/8" Lx272.21'

FILED SURVEY No. 9185

FILED SURVEY No. 11052

S 70°04' E  
329.53'

N 19°56' E

FOUND LEAD/TACK IN A  
CONCRETE RAMP

RAILROAD SPUR TRACK  
EASEMENT  
INST. No. 78-21306 O.R.

FOUND 3/4" IRON PIN  
BENT -- RESET SAME  
MONUMENT

5.73 Ac. ±

2.86 Ac. ±

FILED SURVEY No. 7353

SECTION CORNER  
FOUND C.S. BR. DISK  
IN CONCRETE

18  
19  
20

S 89°44'30" E  
1075.12'

S 58°59'35" E  
408.86'

S 20°31'08" W  
312.57'

S 69°41'55" E  
6000'

N 72°00' E, 64.535'

S 69°41'55" E  
304.045'

N 19°56' E  
223.94'

N 41°45'30" E, 53.795'

N 19°56' E  
385.00'

N 19°56' E  
385.06'

N 41°45'30" E, 53.795'

701.185'

704.48'

S 69°41'55" E  
15.10'

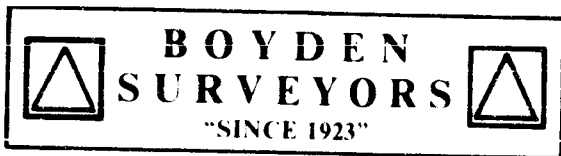

MARK E. BOYDEN  
RPLS ORE 281

108 MISTLETOE ST., MEDFORD, OREGON 97501  
PHONE (503) 773-6000

GARY D. KAISER  
RPLS ORE 803

SURVEY NO. 11167

SURVEY NARRATIVE TO COMPLY WITH O.R.S. 209.250

SURVEY FOR: DOUBLE DEE LUMBER CO.  
P.O.Box 3517  
Central Point, Oregon

SURVEY BY: BOYDEN SURVEYORS  
108 Mistletoe Street  
Medford, Oregon

LOCATION: SW ¼ of Section 17 and the NW ¼ of  
Section 20, T.36S., R.1W., W.M., Jackson  
County, Oregon.

BASIS OF BEARINGS: Filed Survey No. 9185

DATE: April 28, 1988

PURPOSE: To monument and describe the adjusted  
boundaries of Tax Lot No.s 36 1W 17C-2502  
2503 and 2504. These combined Tax Lots  
are described in Warranty Deed from  
Dorothy Dee Shugart to Double Dee Lumber  
Co. as Tracts "A" and "B" in Instrument  
No. 83-13983 O.R. For approval of this  
Lot Line Adjustment see Jackson County  
Planning and Development File No.  
88-15-LLA.

PROCEDURE:

Utilizing E.D.M. equipment, traversed from the corner  
common to Sections 17, 18, 19 and 20 to and around the  
subject tract tying the existing corner monuments. From said  
existing monuments and information shown on Filed Survey No.s  
5143, 7353, 9185 and 11052, the desired tract boundaries were  
computed and monumented as shown on the annexed map. The new  
adjusted tract boundaries were located per the clients  
direction and the County approval.

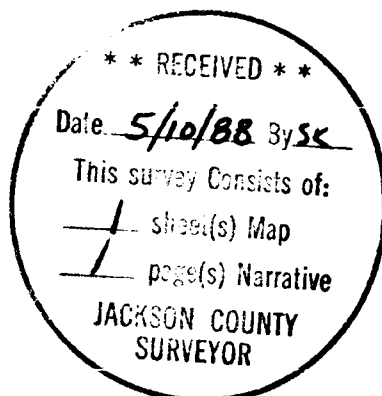

*Gary D. Kaiser*

