

11047

SURVEY FOR
 STONE CONTAINER CORP
 150 NORTH MICHIGAN AVE.
 CHICAGO, ILLINOIS 60601-7568

SURVEY BY
 BOYDEN SURVEYORS
 108 MISTLETOE STREET
 MEDFORD, OREGON 97501

LOCATION
 SOUTH-HALF OF SECTION 18
 T. 36 S., R. 1 W., W.M.
 JACKSON COUNTY, OREGON

DATE
 DECEMBER 2, 1987

REGISTERED
PROFESSIONAL
 LAND SURVEYOR

Gary D. Kaiser
 OREGON
 JULY 16, 1967
 GARY D. KAISER
 No. 803

**** RECEIVED ****
 Date 12/2/87 By SK
 This survey consists of:
 2 sheets(s) Map
 3 panels(s) Narrative
 JACKSON COUNTY
 SURVEYOR

SE COR. OF SECTION 18 BEARS
 SOUTH, 684.04' & EAST, 1743.91'
 D.R. = SOUTH, 684.0' & EAST, 1743.7'

8th STREET (COUNTY ROAD)

AVE. 'G' (COUNTY RD)

AVE. 'F' (FILED SURVEY No. 4096) (COUNTY ROAD)

RAILROAD TRACKS

12.205 Ac. ±

11th STREET (COUNTY ROAD)

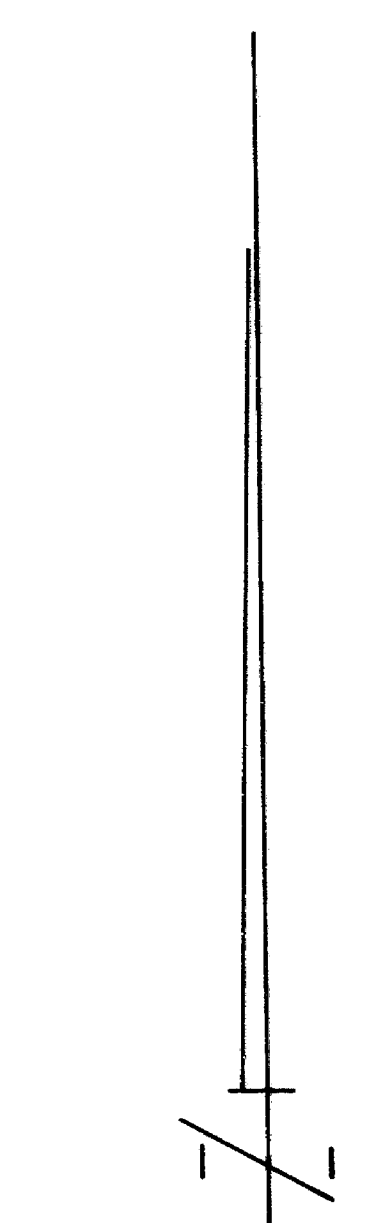

SCALE: 1" = 100'

BASIS OF BEARINGS
 FILED SURVEY No. 10929
 (E AGATE ROAD)

N 81°53'10"E, 41.30'
 S 0°11'33"W, 50.00'
 INST. No. 71-03133 O.R.
 FILED SURVEY No. 4470

SOUTHERN PACIFIC RAILROAD R/W

FILED SURVEY No. 5905

0.27'
 FOUND 1/2" I. PIPE
 12" DEEP

- LEGEND**
- FOUND 3/4" IRON PIN
 - ✕ FOUND MONUMENT AS INDICATED
 - SET 5/8" X 24" REBAR WITH PLASTIC CAP MARKED "KAISER RLS 803"
 - ⊙ FOUND BR. DISK IN CONC. PAVE.

NOTE
 EASEMENT HAVE NOT BEEN LOCATED ON THIS SURVEY.

AVE. 'E' ANTELOPE (COUNTY) ROAD

SHEET 1 OF 2

East from the monumented Easterly boundary of Filed Survey No. 1258.

The Westerly parcel shown on map sheet 2 was monumented consistent with the intent of the Deed Records shown on the map. Filed surveys utilized for control are 5905, 5396 and 2626 plus road control and S.P.R.R. control previously mentioned. It should be mentioned that there are incorrect calls in the Deed Recorded in Instrument No. 87-16967 O.R. The Northwest corner of that tract described in Vol. 588 , Page 497 D.R. was mistakenly called in 2 places where the Northeast corner was intended. In the exception in said deed, the correct call is used. The client and the client's title company have been notified of this.

The Northerly boundary of the Easterly parcel shown on map sheet 2 was recently monumented on Filed Survey No. 10929 and the Deed Recorded in Instruemnt No. 87-23422 O.R. stemed from that survey. The Southerly boundary was monumented as shown.

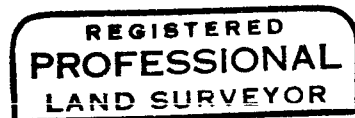

Gary D. Kaiser

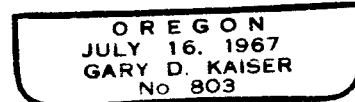

The center line of Antelope Road was located between the Army Engineer's monument (br. disk in concrete pavement) at Eleventh Street and the Br. disk in concrete (see Filed Survey No. 10854) at Pacific Avenue. The Army Engineer's monument at Fourth Street and the stem of the Army Engineer's monument (the disk has been broken off) at Seventh Street were found on this line. The Army Engineer's monument at Agate Road was found 0.18' South of the Antelope Road center line as above described when produced Easterly. This monument was further verified as being off line by the angle turned at the center line intersection of Agate and Antelope. This procedure varies from the control of Antelope Road center line utilized on Filed Survey No. 1894. Because the original R/W deed (see Vol. 316, Page 189) refers to "along the center line of 'B' Street", it was felt that the better solution was to ignore the monument at Agate and Antelope Roads.

The Eleventh Street center line was established according to monuments referred to in the original R/W deed (see Instrument No. 68-05067 O.R.) and by Filed Survey No. 3121.

The Avenue 'C' center line was located from the Army Engineer's monument at Eighth Street and 40 feet Northerly from the Northerly boundary of Filed Survey No. 2626.

The Southerly right-of-way line of Avenue 'F' was located from monuments set on Filed Survey No.s 4096 and 4470 as shown on map sheet 1.

The Southern Pacific Company Railroad right-of-way was located per Filed Survey No. 4470 and Deed Recorded in Vol. 350, Page 95, D.R.

The Westerly boundary of the parcel shown on map sheet 1 was monumented on Filed Survey No. 4470. The record monuments were found and their positions verified. The Easterly boundary of this parcel was also monumented on said Filed Survey No. 4470 but the record monuments have been destroyed. This boundary was remonumented 30 feet Easterly from the 5/8" iron pin found set for the Northeast corner of Filed Survey No. 1258 at the North end and record bearing Southerly as established on Filed Survey No. 4470. An inspection of the field notes taken on Filed Survey No. 4470 indicate the East boundary was established 30 feet

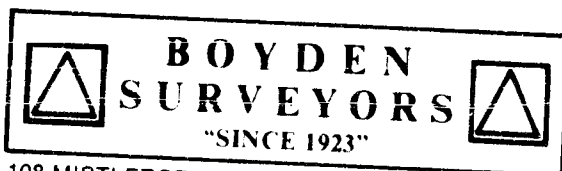

MARK E. BOYDEN
R.P.L.S. ORE 281

108 MISTLETOE ST., MEDFORD, OREGON 97501
PHONE (503) 773-6000

GARY D. KAISER
R.P.L.S. ORE 803

SURVEY NO. 11047

SURVEY NARRATIVE TO COMPLY WITH O.R.S. 209.250

SURVEY FOR: STONE CONTAINER CORPORATION
150 North Michigan Ave.
Chicago, Illinois, 60601-7568

SURVEY BY: BOYDEN SURVEYORS
108 Mistletoe Street
Medford, Oregon, 97501

LOCATION: South-half of Section 18 and the NE 1/4 of
Section 19, T.36S., R.1W., W.M., Jackson
County, Oregon.

BASIS OF BEARINGS: Filed Survey No. 10929 (center line of
Agate Road).

DATE: December 2, 1987

PURPOSE: To monument three parcels proposed to be
transferred. The parcel shown on map sheet
1, consists of those tracts described in
Instrument No. 71-03133 O.R., Vol. 597,
Page 292 D.R. and Vol. 471, Page 227 D.R.
The Westerly parcel shown on map sheet 2
consists of those tracts described in
Instrument No. 74-08191 O.R. less Instru-
ment No. 75-00343 O.R. and Instrument No.
87-16967 O.R. The Easterly parcel shown on
map sheet 2 is that tract described in
Instrument No. 87-23422 O.R.

PROCEDURE:

Utilizing E.D.M. equipment ran control traverses initiat-
ing at the section corner common to Sections 17, 18, 19 & 20.
Closed loop traverses were run around the parcels being monu-
mented, tying existing control monuments needed to compute the
parcel boundaries and leaving traverse points near corner
positions monumented on this survey.

The Agate Road center line was located between the afore-
said section corner and the quarter corner common to Sections
19 & 20.

SURVEY FOR
STONE CONTAINER CORP.
150 NORTH MICHIGAN AVE.
CHICAGO, ILLINOIS 60601-7568

SURVEY BY
BOYDEN SURVEYORS
108 MISTLETOE STREET
MEDFORD, OREGON 97501

LOCATION
NE 1/4 OF SECTION 19
T.36 S., R.14 W., W.M.
JACKSON COUNTY, OREGON

DATE
DECEMBER 2, 1987

PROFESSIONAL
LAND SURVEYOR
J. A. O. K...

RECEIVED
Date 12/2/87 BY J...
This survey is for
2
3
JACKSON COUNTY, OREGON

SCALE: 1" = 100'

BASIS OF BEARINGS
FILED SURVEY No. 10929
(E AGATE ROAD)

LEGEND

- ⊙ FOUND BR. DISK IN CONCRETE
- ⊗ FOUND 5/8" REBAR WITH PLASTIC CAP (SEE FILED SURVEY No. 10929)
- FOUND 3/4" IRON PIN
- FOUND 1/2" IRON PIPE (SEE FILED SURVEY No. 5396)
- ⊙ SET 5/8" X 24" REBAR WITH PLASTIC CAP MARKED "KAISER R.L.S. 803"

NOTES

1. THE LEGAL DESCRIPTION OF PROPERTY DESCRIBED IN INST. No. 87-16967 O.R. HAS AN INCORRECT DEED CALL.
2. EASEMENTS HAVE NOT BEEN LOCATED ON THIS SURVEY.

