

SURVEY IN SEC. 6, T.36 S., R.1 W., WM.
 FOR: JACKSON CO.
 PROJ: PR. 21 (87-18)

BY: EDWARD A. MC GINTY
 JACKSON CO. SURVEYOR
 COURT HOUSE
 MEDFORD, OREGON
 SEPT. 9, 1987

SCALE 1"=400'
 • = 5/8" x 24" REBAR
 ○ = CO-ORDINATE PT.
 (No) = SEE NARRATIVE

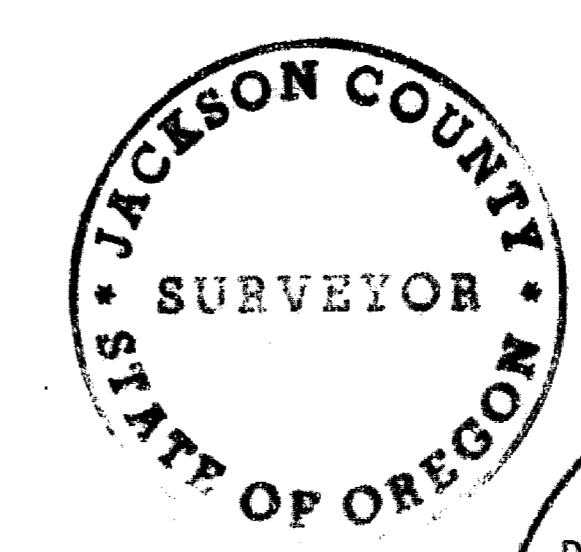

** RECEIVED **
 Date 9/17/87 By SK
 This survey consists of
 1 sheet(s) Map
 2 page(s) Narrative
 JACKSON COUNTY SURVEYOR

- (7) At the center of section, set a 1 inch diam. iron pipe, 36 inches long, flush. This falls approximately 9 feet east of the north-south fence. Osgood monument (lost) computes $N23^{\circ}47'09''W$, 17.00 feet.
- (8) At the East quarter corner found monument set by Osgood and Cummings in 1910, as being a 1 inch pipe set flush in apparently scattered rock mound which falls approximately 3 feet south of east-west powerline and approximately 19.5 feet south of east-west fence line. This location will conflict with the previous prorated position shown on Survey No. 3337.

The legal status of the existing fence line as to a validity of adverse possession, was not determined. The east-west fence along the north line of the section near the quarter corner apparently has been rebuilt after flooding by the Rogue River, perhaps on several occasions. The north-south fence along the center of the section appears to be the same location or near same location for many years.

Osgood and Cummings' field notes indicated a gross error was made on their plat in computing the bearings. Also the notes indicate no attempt was made to determine the true center of Section 6. Osgood's monument near the center of the section line has likely been destroyed by the power company in their placement of the power pole. This computes approximately 1.0 feet south of the pole and approximately 3.45 feet easterly of post identified by Givan as being close to the Osgood monument.

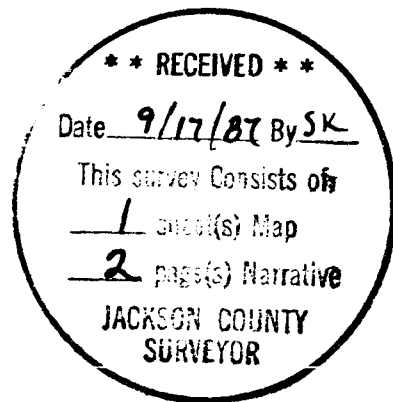

SURVEY NARRATIVE TO COMPLY WITH PARAGRAPH 209.250
OREGON REVISED STATUTES

FOR: Jackson County

BY: Edward A. McGinty
Jackson County Surveyor
County Courthouse
Medford, Oregon 97501

DATE: September 9, 1987

LOCATION: Section 6, Township 36 South, Range 1 West of the
Willamette Meridian in Jackson County, Oregon.

BASIS OF BEARING: Determined from a 1983 traverse along the south line
of Section 6. This bearing being approximately the
same as shown on Survey NO. 5013.

PRECEDENCE OF SURVEY:

Purpose of survey was to subdivide Section 6 and to establish or recover the East quarter corner, the North quarter corner and the center of Section 6.

Utilizing a 1983 traverse, computed the location of the south line of Section 6. On the 1983 traverse, a tie was made to a fence post, identified by Givan in 1983, as being close to the monument set by Osgood and Cummings in 1910. This point was set near the center of Section 6 and tied to verify the location of the south quarter corner which also was identified by Givan.

The East quarter corner was established in 1910 by Osgood, setting a one inch iron pipe in the original rock mound. Since the location of this corner was not evident in the public records, I began a traverse, at the reference point being a 3/4 inch pipe near the Southeast section corner, then tying said quarter corner and then continuing to the Northeast corner of the Section. The location of the East quarter corner as established by Osgood was evaluated as being the best evidence and the only remaining evidence of the original corner.

The traverse continued westerly from the East quarter corner (with a fly tie to the West quarter corner), to a point set in 1983 near the center. Then went northerly to a point near the North quarter corner, then easterly to the Northeast section corner.

The North quarter corner was set at proportional distance, utilizing other private data of a tie to the Northwest corner of the section.

For additional data or references, see the Official Records for the re-establishment of the corners.

MONUMENTS AND OTHER POINTS:

- (1) At the Northeast corner of section, found a 2 1/2 inch brass capped pipe, 4 inches deep, being on east-west fence line.
- (2) At the Southeast corner of section, it was determined by co-ordinates of previous 1983 survey (monument and case in pavement).
- (3) At the West quarter corner of section, found a 2 1/2 inch brass cap flush in the center of old abandon road. (See Official Records).
- (4) At the Northwest corner of section, it was determined from previous data also data on Survey No. 10129.
- (5) At the North quarter corner of section, set a 1 inch diam. iron pipe, 36 inches long, flush, at a prorated distance. This falls 4 feet west of the north-south fence and 15.8 feet south of east-west. Also found evidence of very old fence, possibly running easterly.
- (6) At the witness corner for the center-North sixteenth corner, set a one inch diam. iron pipe, 36 inches long, 15 feet westerly of the center-north one sixteenth corner, 1.5 feet west of the north-south fence and 39.5 feet south of fence running westerly.